

three inches = one foot
one and one half inches = one foot
one inch = one foot
three quarters inch = one foot
one half inch = one foot
three eighths inch = one foot
one quarter inch = one foot
one eighth inch = one foot
one sixteenth inch = one foot

EXISTING FLOOR STRUCTURE : 2" METAL DECK WITH 3 1/4" LIGHTWEIGHT CONCRETE
- FIRST FLOOR TO SECOND FLOOR ABOVE: 12'-3"
- DIMENSION FROM FIRST FLOOR TO BOTTOM OF METAL DECK : 11'-9 3/4"
- DIMENSION FROM FIRST FLOOR TO BOTTOM OF MAIN BEAM (10' x 14"): 10'-0 3/4"
BEAM SIZES Varies - SEE EXISTING DRAWINGS 9-1 DATED 3/7/99 (AS BUILT 4/99)

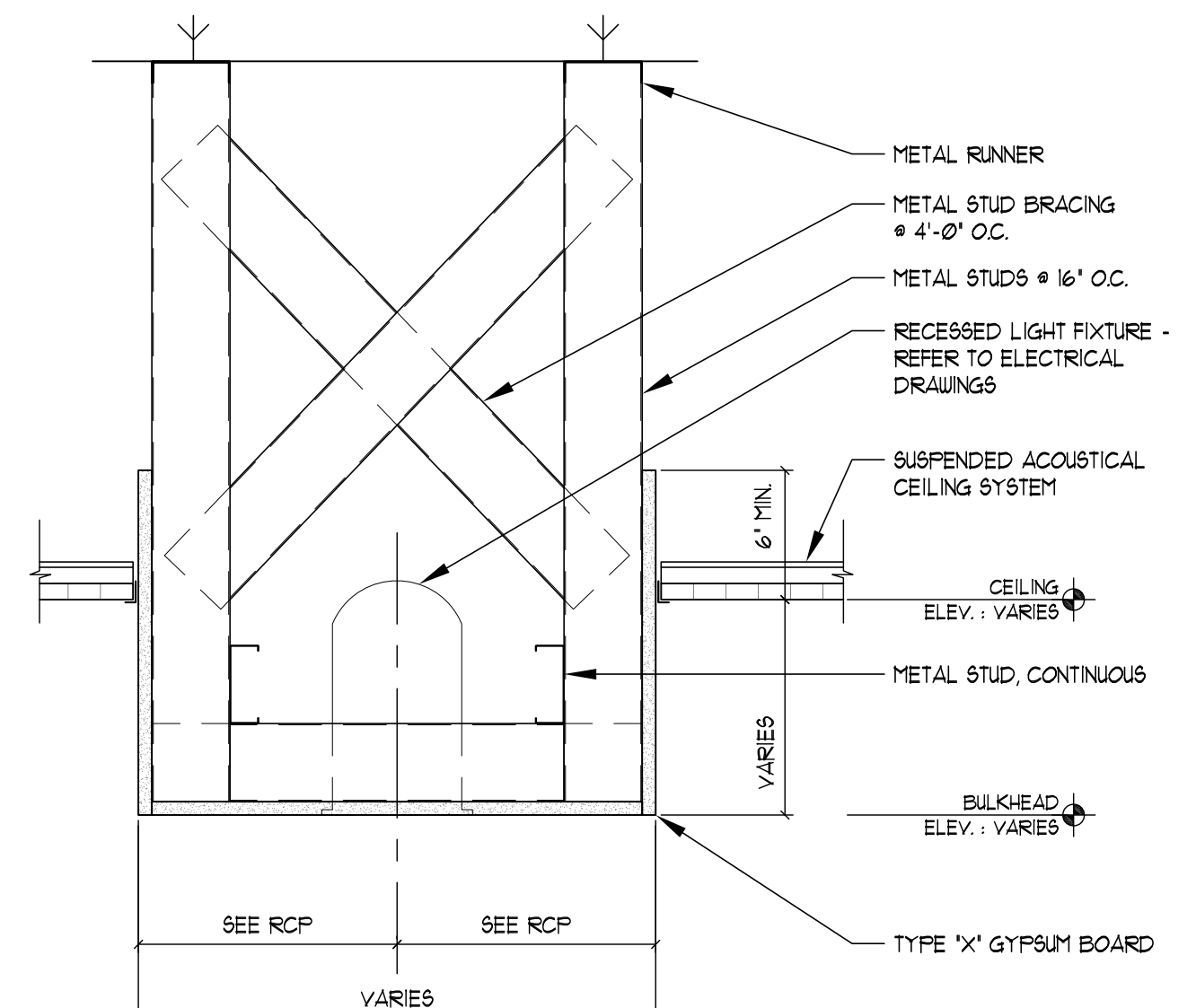
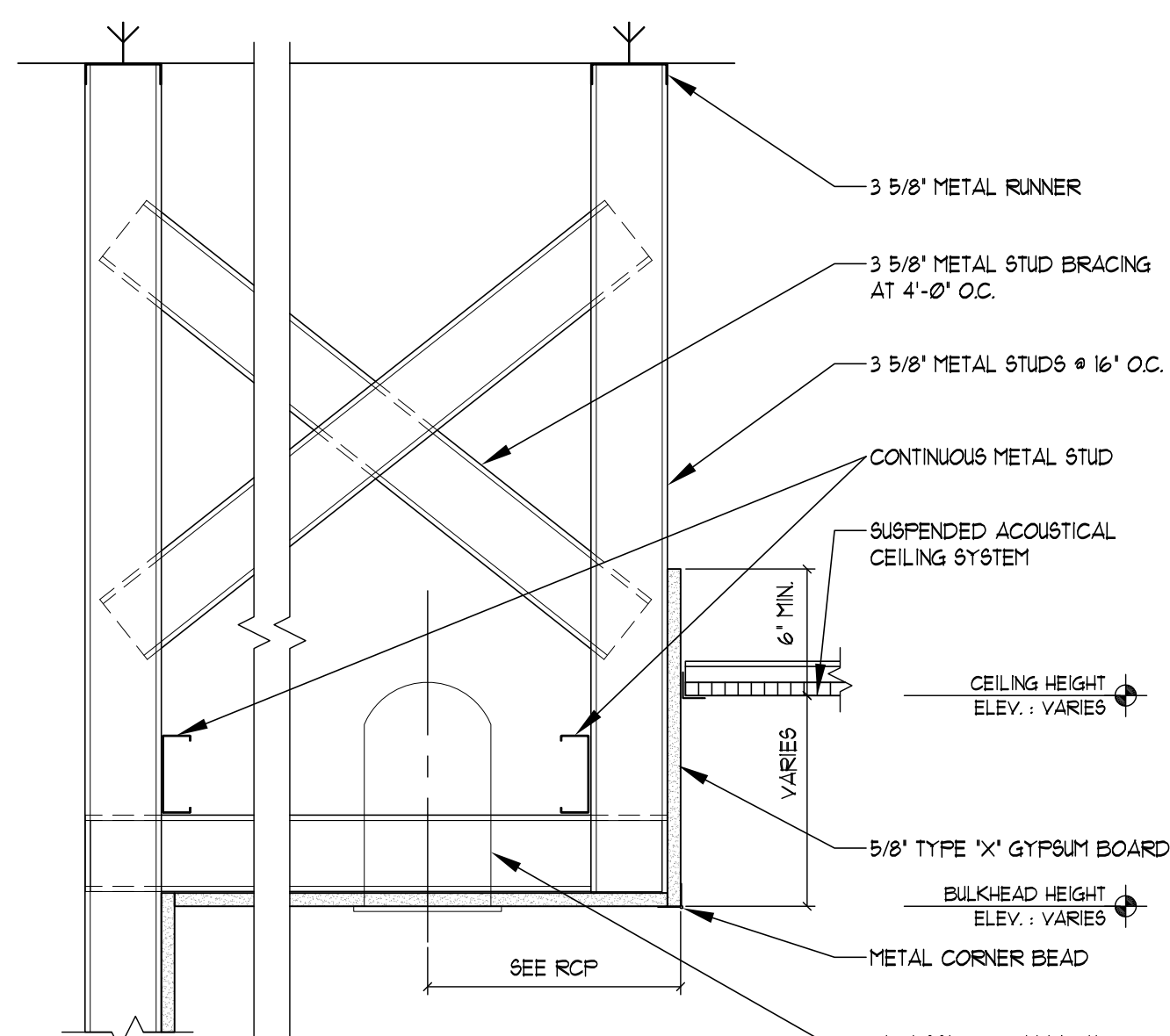

01 PHASE 2 REFLECTED CEILING PLAN - FIRST FLOOR EAST
SCALE: 1/8"=1'-0"

- ### GENERAL REFLECTED CEILING PLAN NOTES:
- A. ALL CEILING HEIGHTS ARE 9'-0" UNLESS NOTED OTHERWISE.
 - B. ALL BULKHEAD/ SOFFIT HEIGHTS ARE 7'-2" UNLESS NOTED OTHERWISE.
 - C. ALL TRADES SHALL PARTICIPATE IN A COORDINATION MEETING PRIOR TO ANY INSTALLATION OF ABOVE CEILING SYSTEMS, SERVICES, EQUIPMENT, ETC. DURING THE SHOP DRAWING PHASE.
 - D. REFER TO THE PROJECT MANUAL AND THE FIRE PROTECTION PLANS FOR THE LOCATION OF THE SPRINKLER HEADS UNLESS DIMENSIONED OTHERWISE ON THE PLANS. DO NOT LOCATE ANY SPRINKLER HEADS IN A BULKHEAD OR SOFFIT WITHOUT FIRST COORDINATING THE LOCATION WITH THE ARCHITECT.
 - E. THE REFLECTED CEILING PLANS DO NOT INDICATE THE LIGHTING LAYOUT IN AREAS WITHOUT CEILING FINISHES. REFER TO THE MECHANICAL PLUMBING AND ELECTRICAL DRAWINGS FOR ADDITIONAL SERVICES.
 - F. REFER TO THE CASEWORK SECTIONS FOR BULKHEAD DEPTHS OVER UPPER CABINETS. THE BULKHEAD SHALL EXTEND BEYOND THE FACE OF THE CABINET DOOR 1/2" OR SHALL EXTEND 1 1/4" BEYOND THE FACE OF THE OPEN SHELF UNITS.
 - G. REFER TO THE MECHANICAL, PLUMBING AND ELECTRICAL DRAWINGS FOR ADDITIONAL CEILING MOUNTED SERVICES.
 - H. ALL CEILING MOUNTED SPRINKLER HEADS, DETECTORS, LIGHT FIXTURES, EXIT LIGHTS, ETC. SHALL BE INSTALLED IN THE CENTER OF THE CEILING SYSTEM GRID. REFER TO THE MECHANICAL AND ELECTRICAL DRAWINGS FOR ADDITIONAL INFORMATION.
 - I. REFER TO A2 SERIES SHEETS FOR GENERAL DEMOLITION NOTES.
 - J. REFER TO THE A5 SERIES SHEETS FOR THE BULKHEAD/SOFFIT DETAILS.
 - K. REFER TO A10 SERIES SHEETS FOR ACCESS DOOR DETAILS.
 - L. REFER TO A16 SERIES SHEETS FOR EQUIPMENT SCHEDULE.
 - M. REFER TO 10 SHEETS FOR ROOM FINISH SCHEDULE AND PLAN FOR FINISH MATERIAL AND COLOR.
 - N. REFER TO THE DEMOLITION PLANS FOR LOCATION OF EXISTING CEILING TO BE REMOVED.
 - O. COORDINATE THE EXTENT OF CEILING REMOVAL AND REPLACEMENT WITH WORK ASSOCIATED WITH MEP AND ASBESTOS REMOVAL. REFER TO MEP DRAWINGS AND ASBESTOS DRAWING FOR ADDITIONAL INFORMATION.

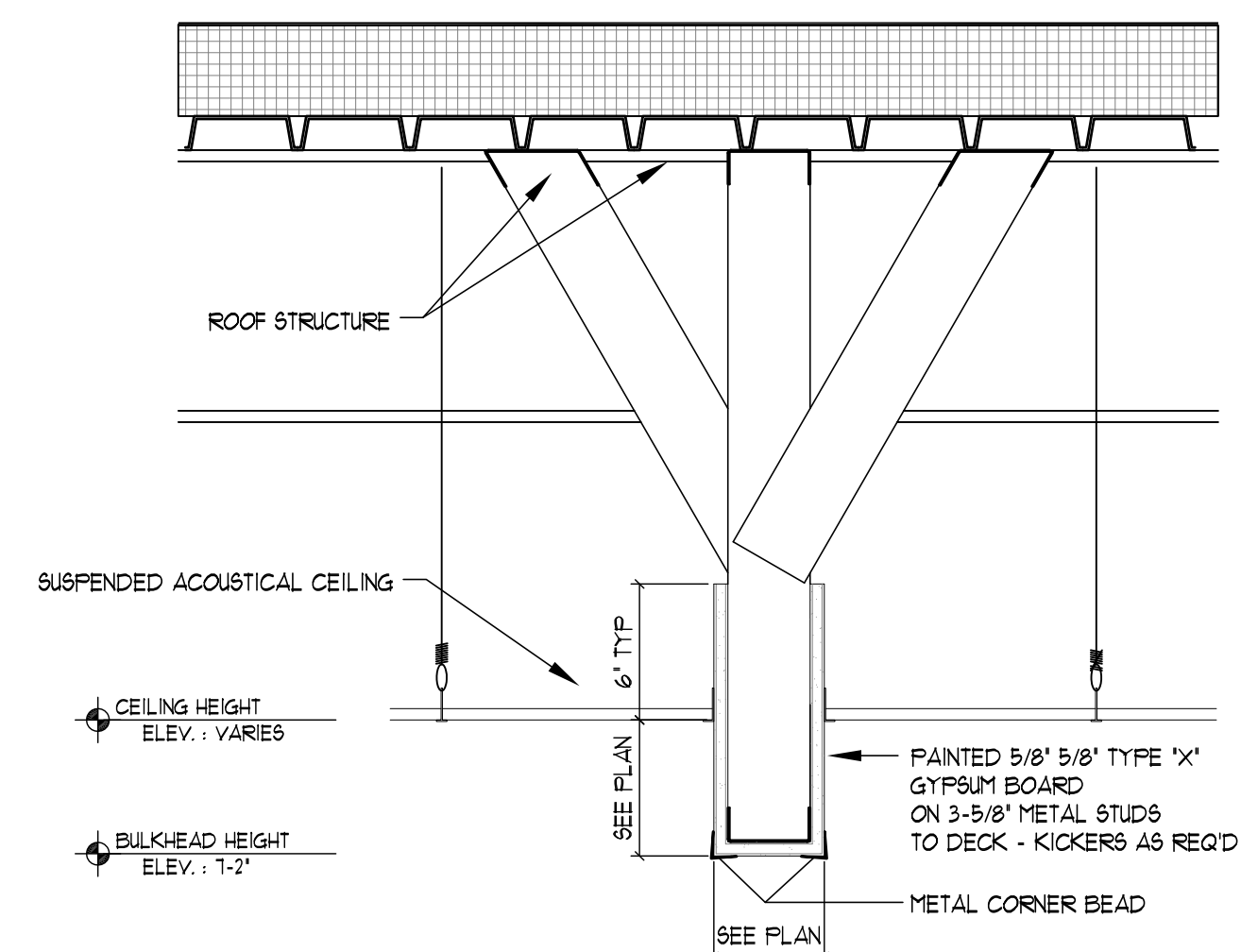
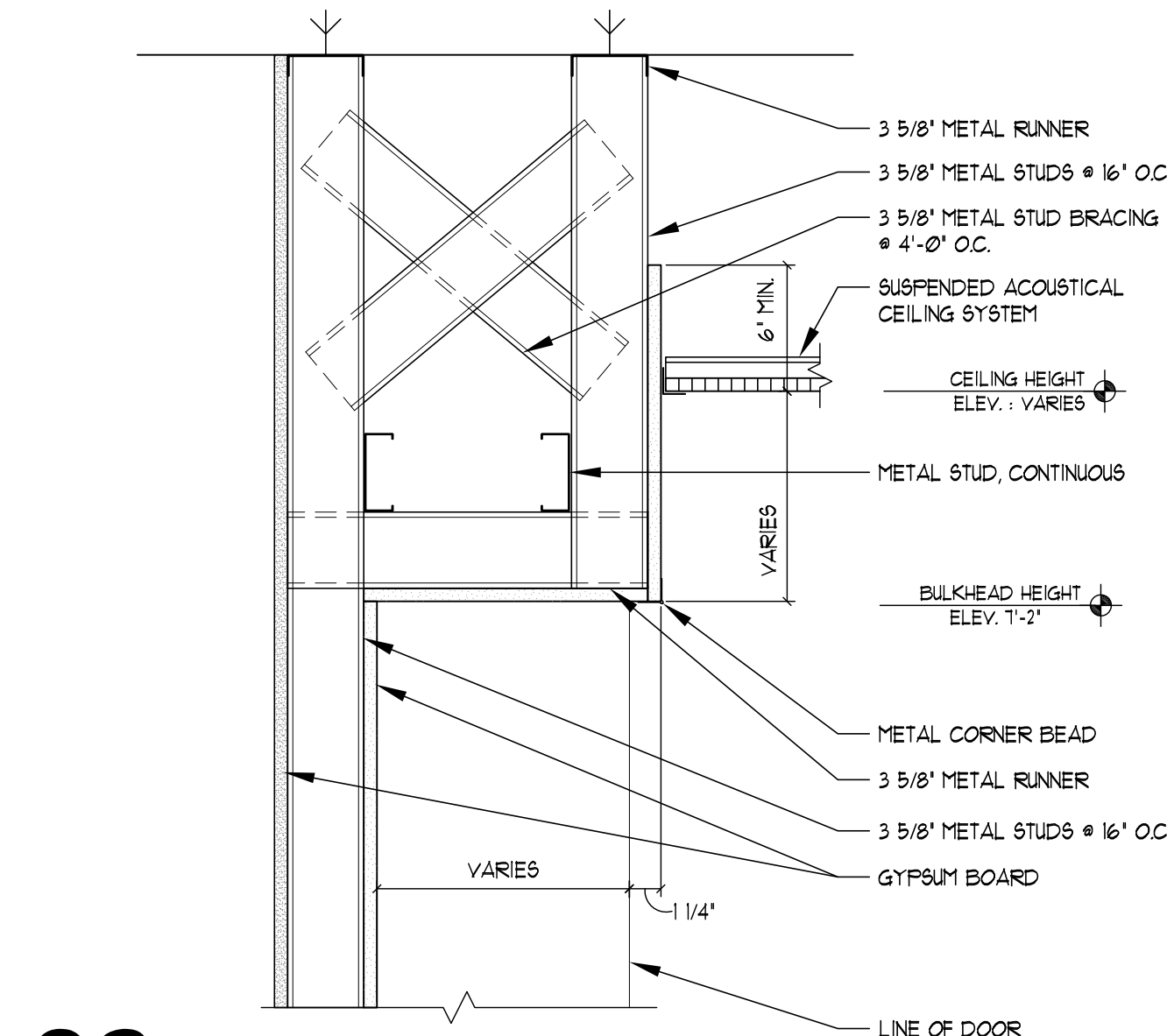

02 BULKHEAD DETAIL, TYP.
SCALE: 1 1/2" = 1'-0"

WALL RATINGS LEGEND:

- NOTES:
- A. RATED WALL DESIGNATIONS ARE DRAWN THROUGH OPENINGS TO INDICATE THAT THE WALL CONSTRUCTION ABOVE THE OPENING HAS THE SAME RATING AS THE CONSTRUCTION ON EITHER SIDE OF OPENING.
 - B. THE CONTRACTOR MUST SUBMIT DOCUMENTATION WHEN RATED WALL ASSEMBLY HAS BEEN TESTED AND APPROVED BY AGENCY OTHER THAN UL.
 - C. THE CONTRACTOR SHALL VERIFY EXISTING RATED WALLS. IF DEFICIENCIES ARE FOUND, THE CONTRACTOR SHALL UPGRADE WALL RATINGS AS ON LIFE SAFETY PLAN AIN AND AIE.
- NON RATED SMOKE PARTITION
DOOR AND RAISE - NOT RATED
DAMPERS - NOT REQUIRED
PENETRATIONS/PERIMETER - SEALED
EXTEND AT LEAST ONE LAYER OF GYPSUM WALL BOARD TO DECK ABOVE OR ENTIRE WALL CONSTRUCTION TO SMOKE RESISTANT CORRIDOR CEILING
- ONE HOUR FIRE BARRIER
DOOR AND RAISE - 45 MIN. RATING
DAMPERS - FIRE - SEE MECH CODE
PENETRATIONS/PERIMETER - FIRE CAULKED
EXTEND ENTIRE WALL CONSTRUCTION TO DECK ABOVE.
- TWO HOUR FIRE BARRIER
DOOR AND RAISE - 90 MIN. RATING
DAMPERS - FIRE - SEE MECH CODE
PENETRATIONS/PERIMETER - FIRE CAULKED
EXTEND ENTIRE WALL CONSTRUCTION TO DECK ABOVE.
- FIRE/SMOKE BARRIER
DOOR AND RAISE - 20 MIN. RATING
DAMPERS - SMOKE - SEE MECH CODE
PENETRATIONS/PERIMETER - SEALED
EXTEND ENTIRE WALL CONSTRUCTION TO DECK ABOVE.
- ONE HOUR FIRE/SMOKE BARRIER
DOOR AND RAISE - 45 MIN. RATING
DAMPERS - FIRE AND SMOKE - SEE MECH CODE
PENETRATIONS/PERIMETER - FIRE CAULKED
EXTEND ENTIRE WALL CONSTRUCTION TO DECK ABOVE.
- TWO HOUR FIRE/SMOKE BARRIER
DOOR AND RAISE - 90 MIN. RATING
DAMPERS - FIRE AND SMOKE - SEE MECH CODE
PENETRATIONS/PERIMETER - FIRE CAULKED
EXTEND ENTIRE WALL CONSTRUCTION TO DECK ABOVE.

REFLECTED CLG. PLAN SYMBOLS:

- 2' x 2' SUSPENDED LAY-IN ACOUSTICAL CEILING (TYPICAL UNLESS OTHERWISE INDICATED)
- 2' x 4' RECESSED LED FIXTURE
- 2' x 2' RECESSED LED FIXTURE
- SPEAKER
- SMOKE DETECTOR
- HEAT DETECTOR
- EXIT LIGHT
- CEILING MOUNTED FIRE ALARM SIGNAL DEVICE
- WALL MOUNTED SCONCE
- RECESSED DOWNLIGHT FIXTURE
- RETURN AIR GRILLE (REFER TO MECHANICAL DRAWINGS)
- SUPPLY AIR DIFFUSER OR REGISTER (REFER TO MECHANICAL DRAWINGS)
- EXHAUST GRILLE (REFER TO MECHANICAL DRAWINGS)
- GYPSUM BOARD SOFFIT/BULKHEAD/CEILING
- BULKHEAD/CEILING HEIGHT (HEIGHT ABOVE FINISHED FLOOR, AS NOTED.)

REFLECTED CEILING PLAN KEYNOTES:

- LINE OF EXISTING BUILDING TO REMAIN. PROTECT DURING NEW CONSTRUCTION.
- NO CEILING FINISH REQUIRED. REFER TO THE MECHANICAL AND ELECTRICAL DRAWINGS FOR SERVICES.
- ALIGN FACE OF SOFFIT/BULKHEAD WITH CORNER OF WALL CONSTRUCTION.
- EXAM LIGHT. SEE DETAIL 05/AB1.
- CUBICLE CURTAIN TRACK. REFER TO DETAIL 05/AB1.
- CEILING MOUNTED TRACK AND RAIL WITH SUPPORT ABOVE FOR BARIATRIC LIFT.
- CEILING MOUNTED SECURITY CAMERA.
- BARRIER FREE CEILING LIFT. GENERAL CONTRACTOR IS TO PROVIDE TRACK AND SUPPORT ABOVE CEILING. COORDINATE WITH VENDOR DRAWINGS. ACTUAL LOCATION SHALL BE COORDINATED WITH COR.
- ACCESS PANEL. REFER TO THE MECHANICAL, PLUMBING AND ELECTRICAL DRAWINGS FOR LOCATION OF VALVES, SWITCHES, DISCONNECTS, ETC.
- A ROW OF CUT TILES.
- PAINT FACE AND ALL SIDES OF BULK-HEAD PT2. UNDERSIDE OF BULKHEAD SHALL BE FG81.
- PAINT FACE AND ALL SIDES OF BULK-HEAD PT4. UNDERSIDE FG81.
- 24 X 24 66 ACCESS PANEL WITH TAMPER/ SUICIDE RESISTENT LOCK.
- CENTER CAN LIGHT IN BULKHEAD.
- NEW PLUMBING CHASE REFER TO PLUMBING DRAWINGS. GC TO MINIMIZE CHASE SIZE.
- PAINT FACE AND ALL SIDES OF BULK-HEAD PT3. UNDERSIDE OF BULKHEAD SHALL BE FG81.
- PAINTED STEEL ACCESS PANEL.
- WINDOW SHUTTER. REFER TO VENDOR DRAWINGS.
- PROVIDE CATEGORY 4 EXTREME DUTY GYPSUM.
- REWORK EXISTING SOFFIT AS REQUIRED TO INSTALL EMERGENCY SIGNAGE, EXTERIOR LIGHTING AND PATIENT LIFT SYSTEM. REPAIR AND REFINISH SOFFIT TO MATCH EXISTING SOFFIT.
- REMOVE AND REPLACE CEILING TILES FOR MEP WORK ABOVE CEILING AND ASBESTOS ABATEMENT WORK. SHALL BE DONE AFTER HOURS OR ON WEEKENDS. COORDINATE WITH COR.

KEYPLAN: FIRST FLOOR

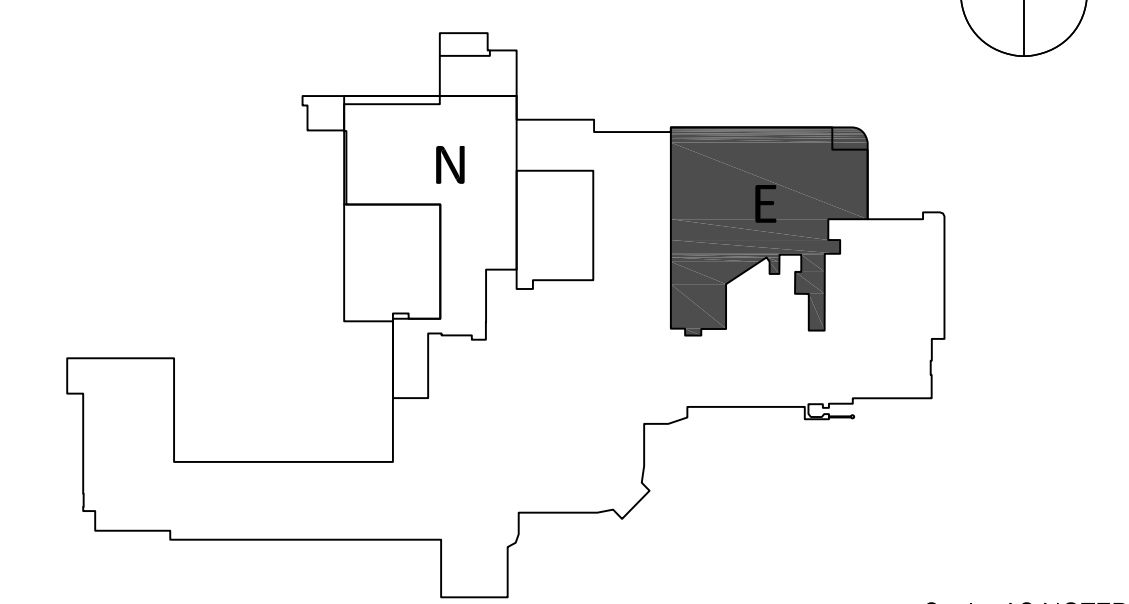

CONSULTANTS:

The Estopinal Group
Mechanical Engineering Division
820 Jordan Street, Suite 507
Shreveport, LA 71101
tel. 318.424.3700
fax 318.424.3764

PROJECT MANAGERS AND ENGINEERS:

TNF A VETERAN OWNED COMPANY
3 EXECUTIVE COURT, UNIT 4
SOUTH BARRINGTON, IL 60010

REFLECTED CEILING PLAN - 1 EAST

Approved: Project Director

Project Title

RENOVATE ED & PRIMARY CARE
Phase 2
Location SHREVEPORT VAMC
510 EAST STONER AVE
Date 01/09/13
Checked JAH
Drawn CSH

Project Number

667-10-100
Building Number 1E
Drawing Number A5.E1
Dwg. 22 of 112

Office of Construction and Facilities Management
Department of Veterans Affairs