

SIGNAGE LEGEND - 1E - PRIMARY CARE			
SIGN NUMBER	SIGNAGE TYPE	SIGNAGE TEXT	NOTES
002	RID-2	IE-300B	--
002A	INF-5	--	--
004	RID-2	IE-300C	--
005	INF-2	FIRE EXTINGUISHER	--
006	INF-6	EXIT	CEILING MOUNTED
007A	INF-3	AUTH PERSONNEL ONLY	--
008	RID-2	IE2	--
009	INF-6	EXIT	DOOR MOUNTED
009A	REG-2	EVAC PLAN	--
010	RID-2	IE4	--
011	FRO-2	CHECK-IN/OUT	CORRDINATE TEXT WITH COR
012	RID-2	IE1	--
012A	INF-3	AUTH PERSONNEL ONLY	--
013	RID-2	IE3	--
014	RID-2	IE6	--
015	RR-4	IE6A	--
016	RR-4	IE5	--
017	RR-1	IE5	--
018	FRO-1	--	--
019	RID-2	IE7	--
020	RID-2	IE8	--
021	RR-4	IE6A	--
022	RID-2	IE10	--
023	RID-2	IE9	--
024	INF-6	EXIT	CEILING MOUNTED
025	RID-2	IE11	--
026	RID-2	IE12	--
027	RID-2	IE13	--
028	RID-2	IE14	--
029	RID-2	IE15	--
030	INF-6	EXIT	CEILING MOUNTED
030A	REG-1	--	COORDINATE TEXT WITH COR
031	RID-2	IE21	--
032	RID-2	IE23	--
033	RID-2	IE22	--
034	INF-2	FIRE EXTINGUISHER	--
035	RR-4	IE24	--
036	RR-1	--	--
037	FRO-1	--	--
038	RID-2	IE26	--
039	RID-2	IE25	--
040	RID-2	IE20	--
040A	INF-3	AUTH PERSONNEL ONLY	--
041	RID-2	IE16	--
042	RID-1	IE19	--
043	RID-2	IE17	--
044	INF-2	FIRE EXTINGUISHER	--
045	INF-6	EXIT	DOOR MOUNTED
045A	REG-2	EVAC PLAN	--
046	RID-2	IE18	--
047A	INF-3	AUTH PERSONNEL ONLY	--
048	RR-4	IE67	--
049	RR-2	--	--
050	FRO-1	--	--
051	RR-4	IE68	--
052	RR-3	--	--
053	REG-2	EVAC PLAN	--
055	INF-2	FIRE EXTINGUISHER	--
056	REG-2	EVAC PLAN	--
057	INF-6	EXIT	--
058	INF-1	EXIT	CEILING MOUNTED
059	RID-2	IE29	--
059A	RID-2	IE29	COORDINATE TEXT WITH COR
059B	INF-3	AUTH PERSONNEL ONLY	--
060	RID-2	IE28	--
061	RID-2	IE27	--
062	RID-2	IE26	--
063	REG-2	EVAC PLAN	--
066	RID-2	--	TBD, COORDINATE WITH COR
067	INF-1	EXIT	CEILING MOUNTED
068	INF-3	AUTH PERSONNEL ONLY	--
069	INF-6	EXIT	DOOR MOUNTED
070	REG-2	EVAC PLAN	--
071A	RID-2	IE1	--
071B	INF-3	AUTH PERSONNEL ONLY	--
072	INF-5	--	--
073	DIMENSIONAL	--	TO BE SUBMITTED PER SIGNAGE SHOP DRAWINGS
074	FRO-2	CHECK-IN	COORDINATE TEXT AND EXACT LOCATION WITH COR
075	FRO-2	CHECK-IN	COORDINATE TEXT AND EXACT LOCATION WITH COR
076	FRO-2	CHECK-IN	COORDINATE TEXT AND EXACT LOCATION WITH COR
077	FRO-2	CHECK-IN	COORDINATE TEXT AND EXACT LOCATION WITH COR
078	FRO-2	CHECK-IN	COORDINATE TEXT AND EXACT LOCATION WITH COR
079	REG-2	EVAC PLAN	--
080	INF-1	EXIT	CEILING MOUNTED
081	RID-2	IE30	--
082	INF-1	EXIT	CEILING MOUNTED
087	INF-2	FIRE EXTINGUISHER	--

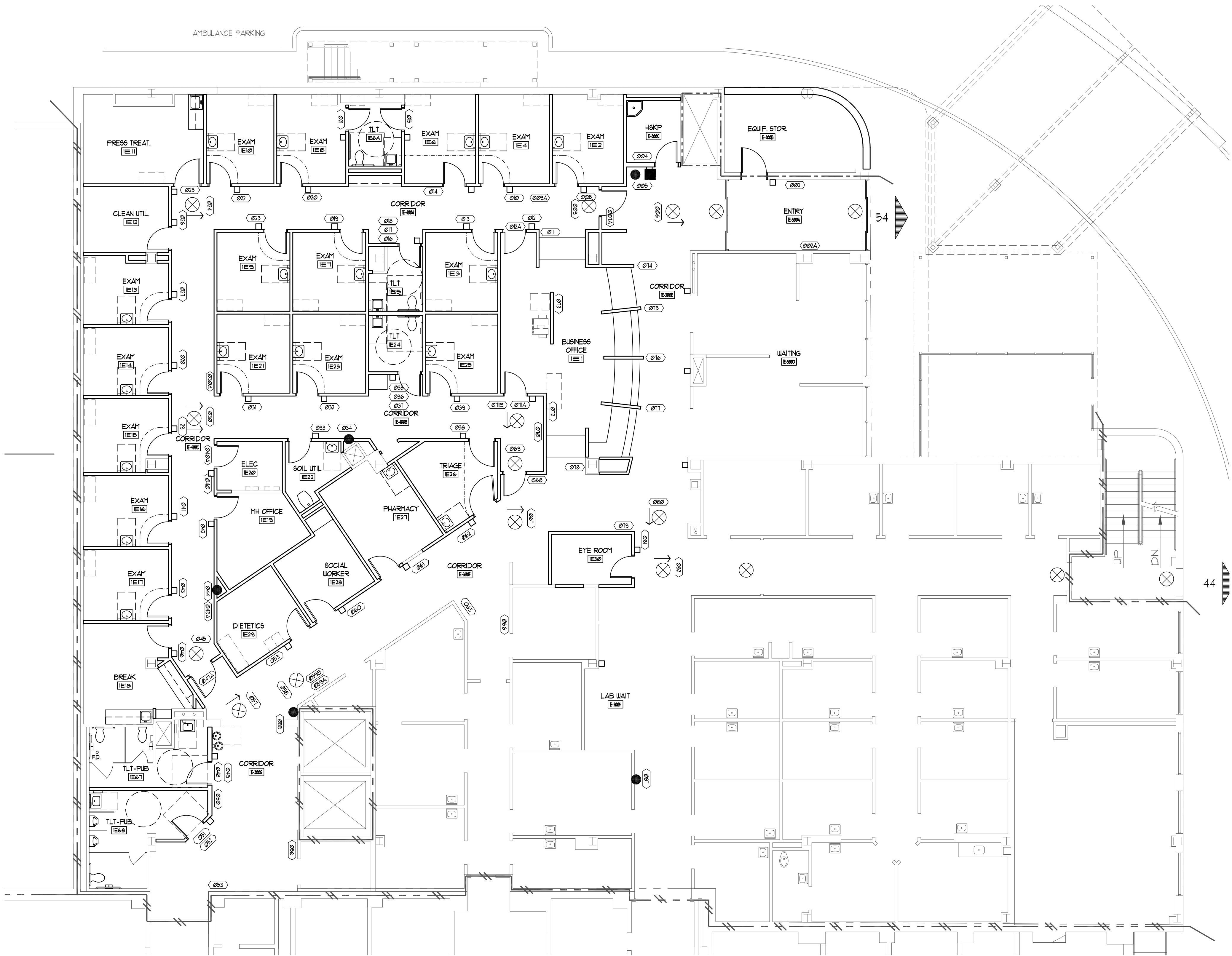

GENERAL CONTRACTOR IS TO SUBMIT SIGNAGE SHOP DRAWINGS, FINAL ROOM NAMES AND LOCATIONS WILL BE DETERMINED BY VA COR

01 FIRST FLOOR SIGNAGE PLAN - EAST
SCALE: 1/8"=1'-0"

CONSULTANTS:



820 Jordan Street, Suite 507 tel. 318.424.3700
Shreveport, LA 71101 fax 318.424.3764



PROJECT MANAGERS AND ENGINEERS:



3 EXECUTIVE COURT, UNIT 4
SOUTH BARRINGTON, IL 60010

Drawing Title
SIGNAGE PLAN - 1E

Approved: Project Director

Project Title
RENOVATE ED # PRIMARY CARE

Location
SHREVEPORT VAMC
510 EAST STONER AVE

Date
01/09/13

Checked
JAH

Drawn
CSH

Project Number
667-10-100

Building Number

Drawing Number

1D1.E2
Dwg. 46 of 112

Office of
Construction
and Facilities
Management



Scale: AS NOTED