

- GENERAL NOTES:**
- A. SUB-BASEMENT SHOWN ON THIS PLAN CAN BEGIN IN PHASE 1. WORK ON THIS PLAN SHALL BE COMPLETED PRIOR TO THE END OF PHASE 2.
 - B. SUB-BASEMENT IS A CRAW SPACE APPROXIMATELY FOUR (4) FEET HIGH WITH LIMITED CLEARANCE AND LIGHTING. ACCESS TO SUB-BASEMENT CAN BE ACHIEVED THROUGH STAIR NUMBER EIGHT (8) AND/OR STAIR NUMBER FIVE (5). ALL PIPING SHOWN IS LOCATED BELOW THE BASEMENT IN THE SUB-BASEMENT.
 - C. ANY OPEN FLAME CUTTING, BRAZING OR WELDING IN SUB-BASEMENT WILL REQUIRE SPOT EMISSIONS DUTY TO OUTSIDE. CONTRACTOR SHALL SUBMIT VENTILATION PLAN TO VA FOR APPROVAL PRIOR TO STARTING WORK.

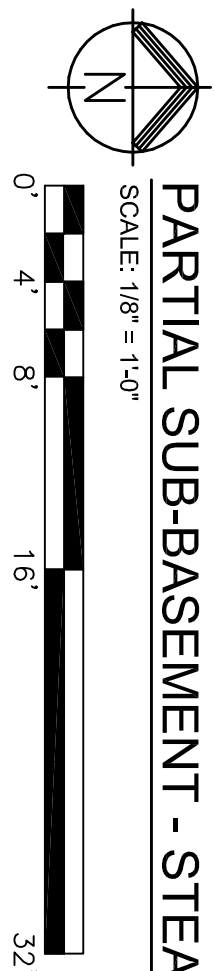

CONSULTANTS:		ARCHITECT:	
FREDRICK, FREDRICK & HELLER 1000 EAST 12TH AVENUE, SUITE 200 BROOKVIEW HTS., OHIO 44147 Tel: (440) 544-2444 Fax: (440) 544-2444		Drawing Title SUB-BASEMENT FLOOR PLAN AREA 1	
Revisions: Date		Project Title STEAM TRAP MONITORING, INSULATION AND PIPING UPGRADES	
FINAL CD-SUBMISSION 95% SUBMISSION 65% SUBMISSION		Location VAMC - WADE PARK	
12-21-12 11-30-12 11-16-12		Checked WFM	
		Drawn JMF	
		Drawing Number 3-SB-1	
		Building Number 541-12-115	
		Office of Facilities Management Department of Veterans Affairs	

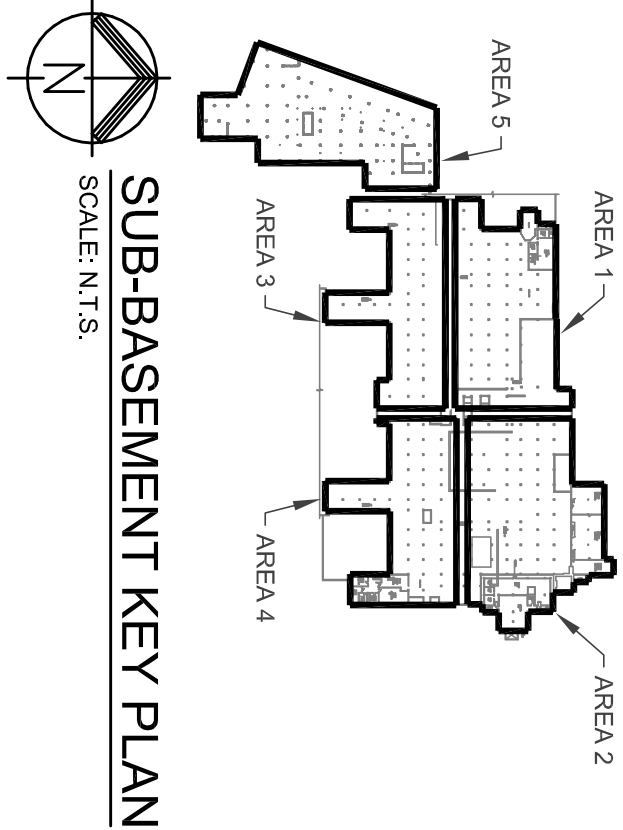