

7'-0" HIGH CONTROL WALL

sink

3'-11" SPACE FOR A STRETCHER.

1703

THE FOLLOWING TOMO & IMAGE PASTING APPLICATIONS ARE POSSIBLE WITH THE LAYOUT AS SHOWN IN THESE DRAWINGS

NOTE: NOT ALL TOMO/IMAGE PASTING OPTIONS MAY BE INCLUDED IN YOUR EQUIPMENT ORDER. PLEASE CONSULT YOUR EQUIPMENT ORDER OR QUOTE FOR VALIDATION.

	YES	NO
WALLSTAND TOMO AND/OR WALLSTAND IMAGE PASTE	✓	
TABLE TOMO (NOT AVAILABLE W/ TRAD ONLY TABLE) AND/OR TABLE IMAGE PASTE	✓	
WALLSTAND CROSS-TABLE TOMO	✓	
EXTENDED WALLSTAND TOMO		✓

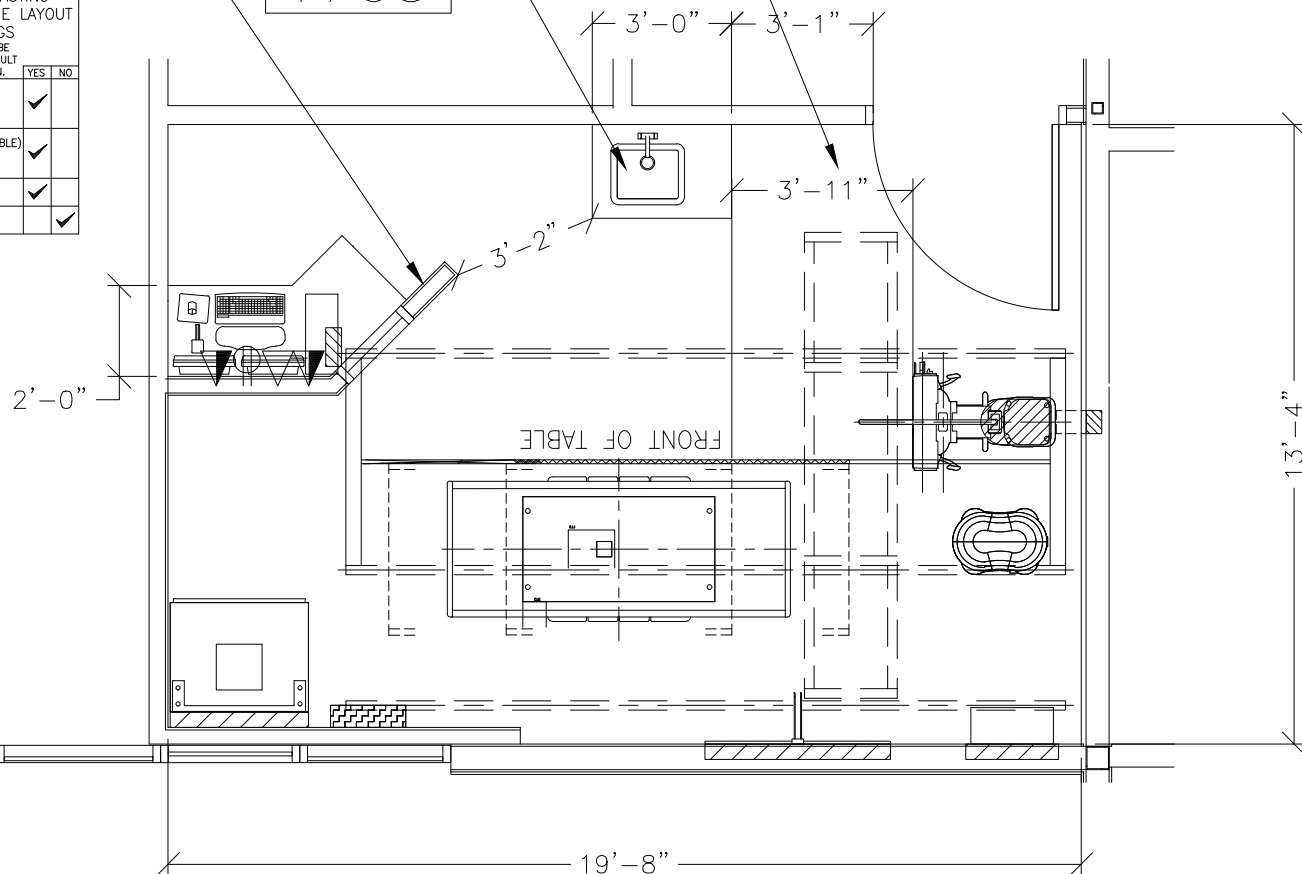

PRELIMINARY PLANNING ONLY

PROJECT TITLE:

VA Clinic  
Discovery XR650  
Pueblo, CO

SCHEME NO.: 12dec386 DRAWN BY: cac DATE: 28.JAN.13

THIS LAYOUT MUST BE APPROVED BEFORE  
FINAL DRAWINGS CAN BE STARTED. THANK YOU

CUSTOMER \_\_\_\_\_ DATE: \_\_\_\_\_

GE INSTALL. SPECIALIST \_\_\_\_\_ DATE: \_\_\_\_\_



**GE Healthcare**

Modality Installation Planning

Milwaukee,

Wisconsin