

Filing Capacity

Items not assigned to a Position

Actual LFI

25,084"

Nominal LFI

26,562"

Actual LFF

2090'4"

Nominal LFF

2213'6"

Include Existing

☒

PHASE ONE

PHASE 1 CARRIAGES - BID ITEM ALTERNATE

(REFERENCE SCHEDULE B IN SOLICITATION)

Standard Elevation

76 1/4" uprights

7 openings

@ 9 3/4" clear

1 divider per opening

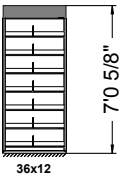

Binder Elevation

76 1/4" uprights

5 openings

1 @ 12 3/4" clear

4 @ 14 1/4" clear

1 divider per opening

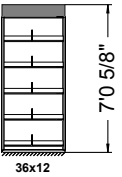

Copyright © 2012 Southwest Solutions Group

See copyright details below

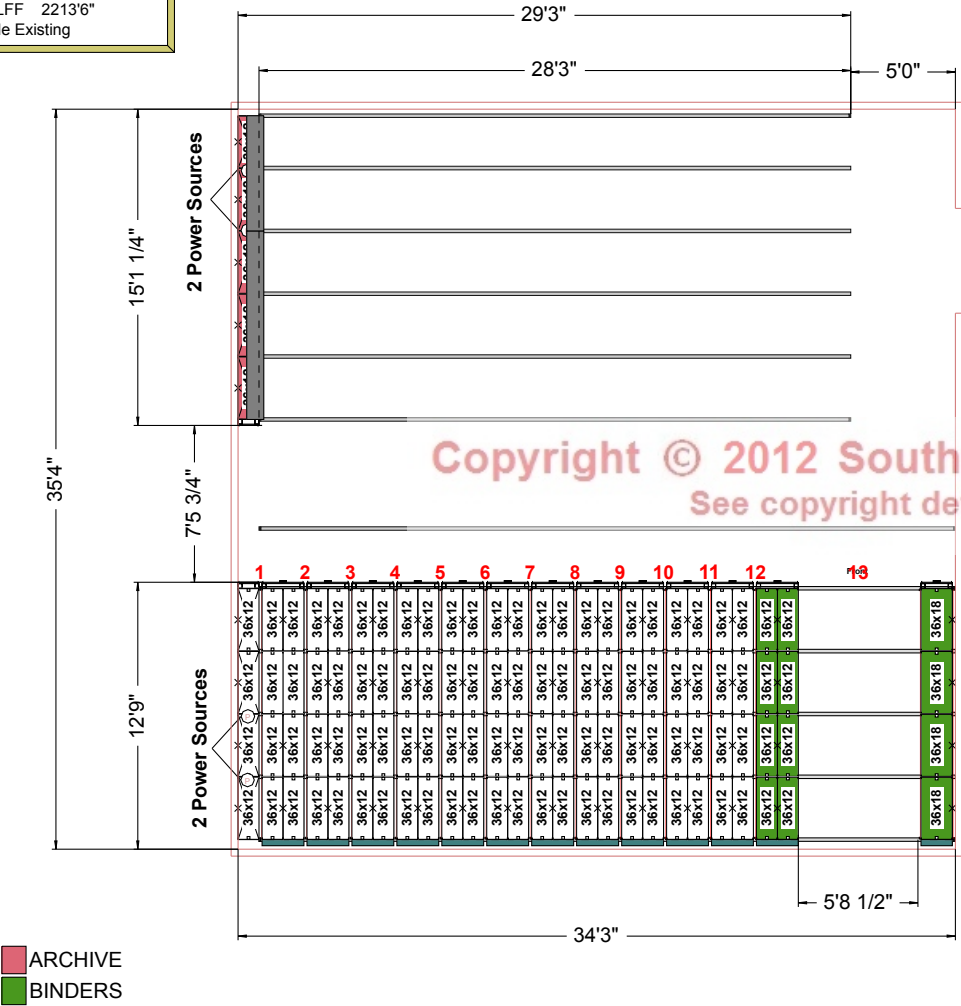

LOWER SYSTEM

System Weight Summary Report			
Total media weight	54,876.00 lbs		
Total equipment weight	16,070.50 lbs		
Total picklist weight	0.00 lbs		
Total aisle weight (15 lbs/ft²)	2,456.63 lbs		
Total system (media, equipment and aisle) weight	73,403.13 lbs		
Total Foot-Print area	534.54 ft²		
Total weight load per square foot (avg unit load)	137.32 lbs/ft²		
Maximum Deflection Allowed is:	L/480		
Weight load (line load*) under front rail	9,293.51 lbs	279.50 lbs/ft	
Weight load (line load*) under rail no. 2	16,734.02 lbs	503.28 lbs/ft	
Weight load (line load*) under rail no. 3	16,734.02 lbs	503.28 lbs/ft	
Weight load (line load*) under rail no. 4	16,734.02 lbs	503.28 lbs/ft	
Weight load (line load*) under back rail	8,477.51 lbs	254.96 lbs/ft	
*Line Load calculations do not include the weight of Floor, Ramp, or Aisles.			

SOUTHWESTSOLUTIONSGROUP

business organization systems

Texas • Oklahoma • Kansas

Arkansas • Mississippi • Tennessee

Toll Free 1-800-803-1083

www.southwestsolutions.com

Scale:	Sheet:
1:110	1 of 1
Printed Date:	Drawn By:
12/03/2012	A. Morris
Drawing:	
Number:	30441-STO-1F
Salesperson:	CROCK,CRAIG

Central TX Veterans Healthcare System

Storage

Waco, TX

Copyright © 2012 Southwest Solutions Group. This material is proprietary and confidential, and the disclosure reproduction by photography, film, blueprint or otherwise or incorporation into any information retrieval system without first receiving written approval from Southwest Solutions Group is expressly prohibited by law.

Filing Capacity	
Items not assigned to a Position	
Actual LFI	50,108"
Nominal LFI	53,058"
Actual LFF	4175'8"
Nominal LFF	4421'6"
<input checked="" type="checkbox"/> Include Existing	

44,000 LFI GOAL

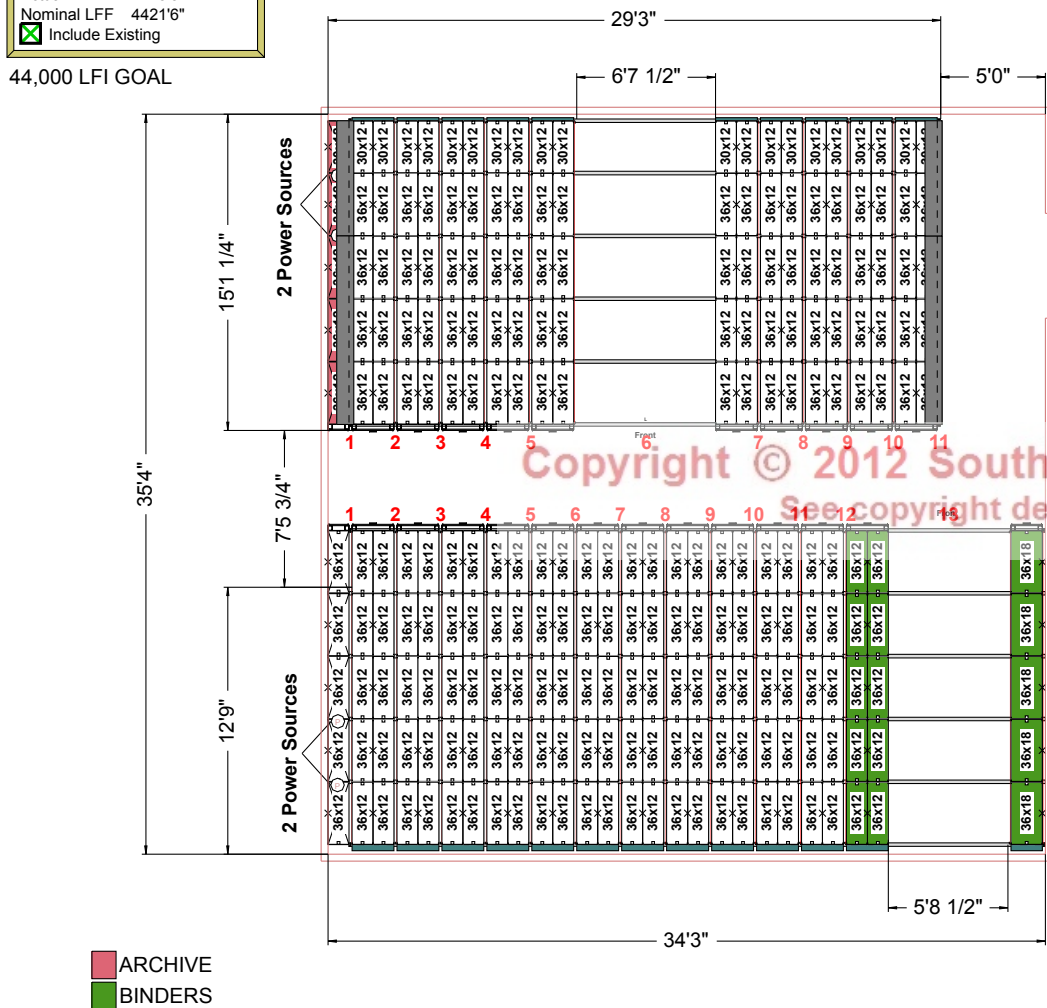

PHASE TWO

PHASE 2 - REFERENCE ONLY - IS
FOR FUTURE PURCHASE BY VA -
NOT IN CONTRACT (NIC)

System Weight Summary Report

Total media weight	45,423.00 lbs	
Total equipment weight	14,269.11 lbs	
Total picklist weight	0.00 lbs	
Total aisle weight (15 lbs/ft²)	2,667.80 lbs	
Total system (media, equipment and aisle) weight	62,359.91 lbs	
Total Foot-Print area	526.43 ft²	
Total weight load per square foot (avg unit load)	118.46 lbs/ft²	
Maximum Deflection Allowed is:	L/480	
Weight load (line load*) under front rail	6,455.06 lbs	228.67 lbs/ft
Weight load (line load*) under rail no. 2	11,441.62 lbs	405.31 lbs/ft
Weight load (line load*) under rail no. 3	11,441.62 lbs	405.31 lbs/ft
Weight load (line load*) under rail no. 4	11,441.62 lbs	405.31 lbs/ft
Weight load (line load*) under rail no. 5	10,503.86 lbs	372.09 lbs/ft
Weight load (line load*) under back rail	4,877.30 lbs	172.78 lbs/ft

*Line Load calculations do not include the weight of Floor, Ramp, or Aisles.

Standard Elevation
76 1/4" uprights
7 openings
@ 9 3/4" clear
1 divider per opening

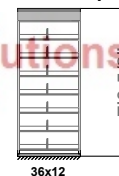

Binder Elevation
76 1/4" uprights
5 openings
1 @ 12 3/4" clear
4 @ 14 1/4" clear
1 divider per opening

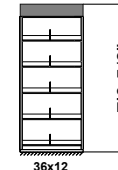

UPPER SYSTEM

LOWER SYSTEM

System Weight Summary Report

Total media weight	68,170.00 lbs	
Total equipment weight	19,417.34 lbs	
Total picklist weight	0.00 lbs	
Total aisle weight (15 lbs/ft²)	2,713.51 lbs	
Total system (media, equipment and aisle) weight	90,300.85 lbs	
Total Foot-Print area	637.35 ft²	
Total weight load per square foot (avg unit load)	141.68 lbs/ft²	
Maximum Deflection Allowed is:	L/480	
Weight load (line load*) under front rail	9,213.09 lbs	277.09 lbs/ft
Weight load (line load*) under rail no. 2	16,573.18 lbs	498.44 lbs/ft
Weight load (line load*) under rail no. 3	16,573.18 lbs	498.44 lbs/ft
Weight load (line load*) under rail no. 4	16,573.18 lbs	498.44 lbs/ft
Weight load (line load*) under rail no. 5	16,573.18 lbs	498.44 lbs/ft
Weight load (line load*) under back rail	8,397.09 lbs	252.54 lbs/ft

*Line Load calculations do not include the weight of Floor, Ramp, or Aisles.



SOUTHWESTSOLUTIONSGROUP
business organization systems

Texas • Oklahoma • Kansas
Arkansas • Mississippi • Tennessee
Toll Free 1-800-803-1083
www.southwestsolutions.com

Scale: 1:110	Sheet: 1 of 1
Printed Date: 12/03/2012	Drawn By: A. Morris
Drawing: Number: 30441-STO-1F	
Salesperson: CROCK,CRAIG	

Central TX Veterans Healthcare System Storage Waco, TX

Copyright © 2012 Southwest Solutions Group. This material is proprietary and confidential, and the disclosure reproduction by photography, film, blueprint or otherwise or incorporation into any information retrieval system without first receiving written approval from Southwest Solutions Group is expressly prohibited by law.

Plug-In Method:

Locate a customer-supplied, single 20-amp outlet near the front of the system and 6" above the top of the shelving. Power supplied to this outlet should be on a dedicated/isolated 120 VAC, 60 Hz, 20-amp circuit, including a dedicated/isolated ground wire to the distribution source.

Note: With a plug-in-the-wall system (without Automatic Battery Backup), Spacesaver provides a 20-amp breaker box, a 10 ft. cord and a 20-amp hospital-grade plug.

ALL POWER SUPPLY TO BE
PURCHASED AND INSTALLED AS
PART OF THE BASE BID SCOPE

PLUG-IN INSTALLATION CONSIDERATIONS: Power supply cord must NOT be attached to the building surface, or run through walls, ceilings, floors and similar openings in the building structure. Be sure to take measures to prevent physical damage to the power supply cord, including proper routing of the power supply cord and provision of a receptacle (socket outlet) near the Spacesaver mobile storage system, or positioning the mobile storage system near a receptacle (socket outlet).



SOUTHWESTSOLUTIONSGROUP
business organization systems

Texas • Oklahoma • Kansas
Arkansas • Mississippi • Tennessee
Toll Free 1-800-803-1083
www.southwestsolutions.com

Scale:

1:35

Sheet:

1 of 1

Printed Date:

12/03/2012

Drawn By:

A. Morris

Drawing:

Number: 30441-STO-1F

Salesperson:

CROCK, CRAIG

Central TX Veterans Healthcare System Storage Waco, TX

Copyright © 2012 Southwest Solutions Group. This material is proprietary and confidential, and the disclosure reproduction by photography, film, blueprint or otherwise or incorporation into any information retrieval system without first receiving written approval from Southwest Solutions Group is expressly prohibited by law.

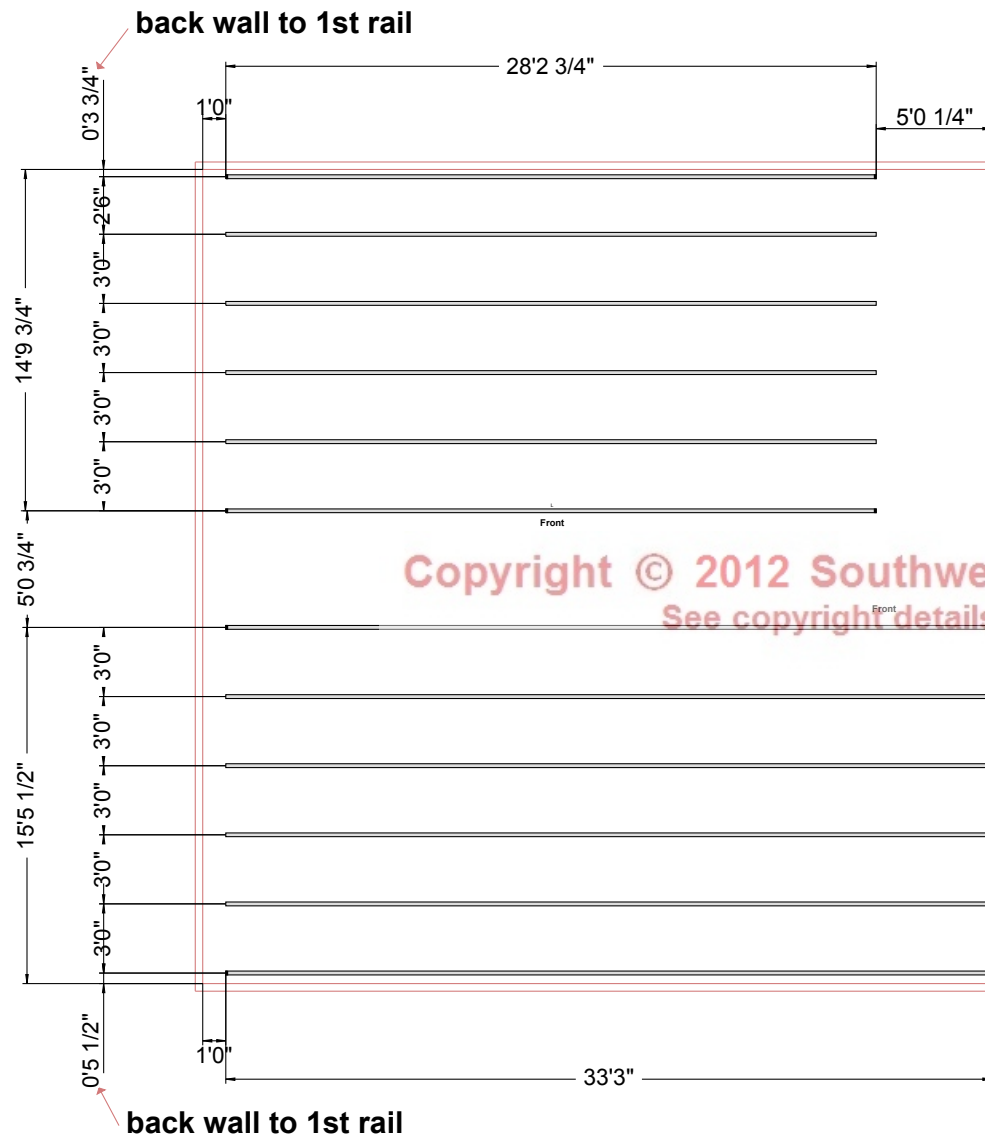

ALL FLOOR RAILS TO BE PURCHASED AND
INSTALLED AS AN ALTERNATE
(REFERENCE SCHEDULE B IN SOLICITATION)

Copyright © 2012 Southwest Solutions Group
See copyright details below

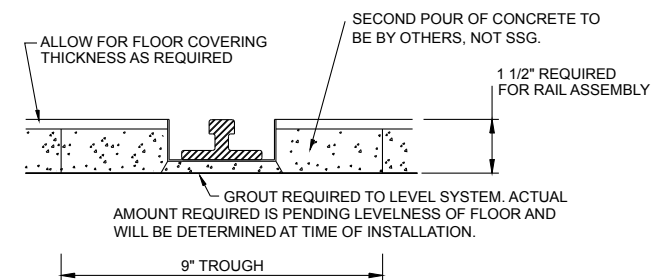

SOUTHWESTSOLUTIONSGROUP

business organization systems

 Texas • Oklahoma • Kansas

 Arkansas • Mississippi • Tennessee

 Toll Free 1-800-803-1083

 www.southwestsolutions.com

Scale: 1:100	Sheet: 1 of 1
Printed Date: 12/03/2012	Drawn By: A. Morris
Drawing: Number: 30441-STO-1F	
Salesperson: CROCK, CRAIG	

Central TX Veterans Healthcare System Storage Waco, TX

Copyright © 2012 Southwest Solutions Group. This material is proprietary and confidential, and the disclosure reproduction by photography, film, blueprint or otherwise or incorporation into any information retrieval system without first receiving written approval from Southwest Solutions Group is expressly prohibited by law.