

Building 1	Admissions Information Primary Care Respiratory Therapy Specialty Clinic Laboratory X-Ray Podiatry	Building 3	Dental Projects Facility Services Employee Health	Building 4	Dining Administration Nutrition Services Human Resources Quality Mgmt. Contracting Fiscal	Building 5	Pharmacy Travel Pay Agent Cashier C & P	Building 28	Mental Health Services Inpatient Outpatient Pharmacy PRRPT	Building 29	Audiology Optometry Whomans Clinic Care Unit 5 Business Office Billing	Building 48	Adult Day Health Care Mail Room Swimming Pool Education Physical Therapy	Building 40	Community Living Center Hospice Medical Records	Building 50	Community Living Center Ventilator Unit Family Meditation	Building 51	Community Living Center Dementia Unit Rehabilitation Therapy	Building 108	Pharmacy & Counseling	Building 111	Mental Health Services Outpatient Pharmacy After Hours Assistance	Building T100	Veteran and Community Services OEF / OIF Release of Information
------------	---	------------	--	------------	---	------------	---	-------------	---	-------------	---	-------------	---	-------------	--	-------------	---	-------------	--	--------------	--------------------------	--------------	--	---------------	--

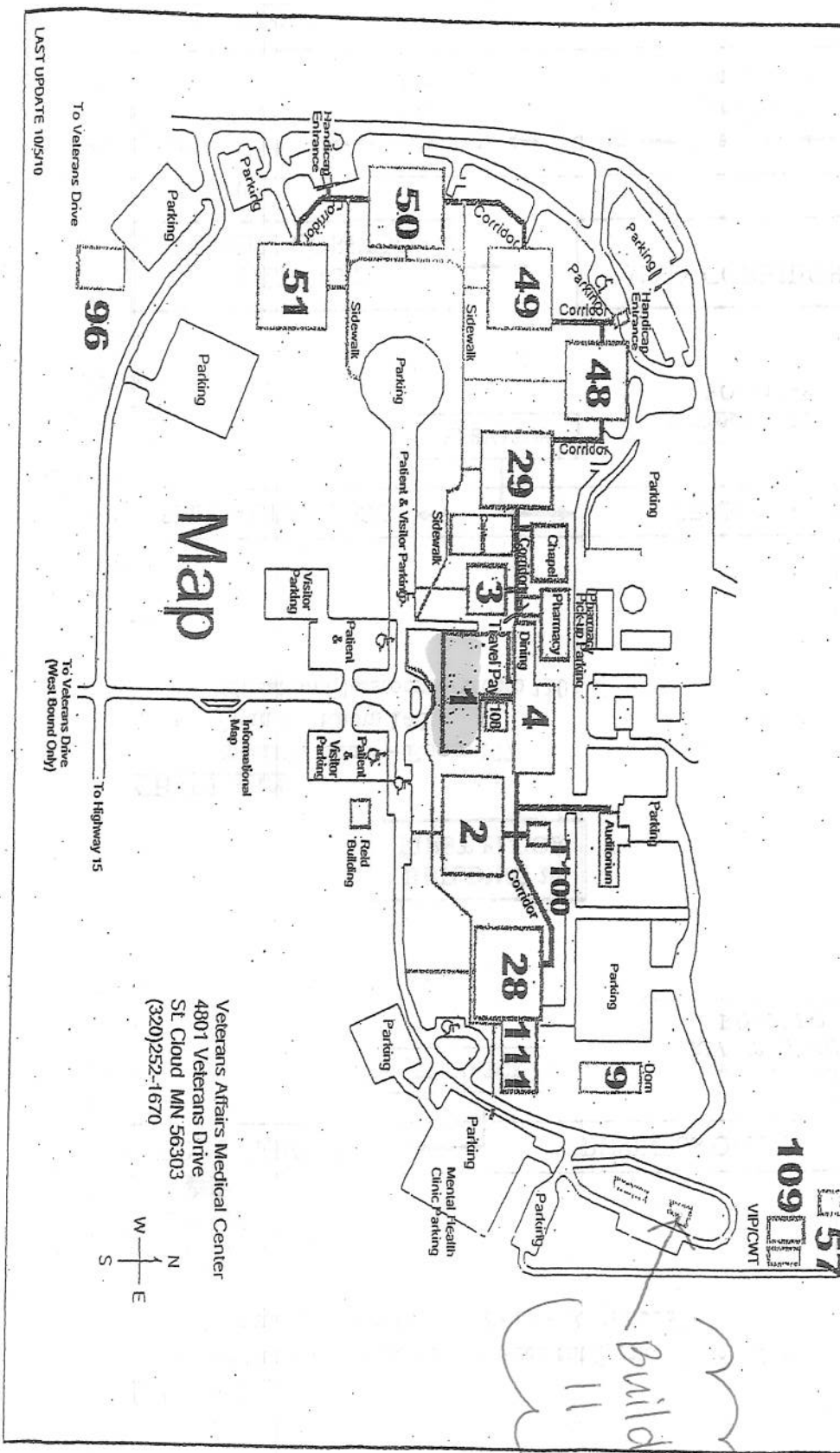

LAST UPDATE 10/5/10