

PROJECT FINISH REFERENCES	
ACOUSTIC CEILING (ACT)	
ARMSTRONG SQUARE EDGE WITH ARMSTRONG ML 15/16" EXPOSED TEE SYSTEM (WHITE) ½" TRACK, FINE FISSURED ACOUSTICS # 1811	
ACT-1	ARMSTRONG 895 2'X4'
ACT-2	ARMSTRONG 896 2'X2'
GYP BD CEILING	
PT-1	GLIDDEN PROFESSIONAL, LIFEMASTER NO VOC, 30YV 71/138, FLAXEN WHITE, SEMI-GLOSS LATEX ENAMEL
RESILIENT TILE FLOORING (VCT)	
VCT-1	KARNDEN, VLT, GRANDEWOOD, VGV33T, COPPER GUM, 48"x7" PLANK, LAID RANDOM
VCT-2	CENTIVA, VLT, RIVER ROCK, HY-RR61 CORTEZ GOLD, SQUARE EDGE 18"x18", LAID ASTER PATTERN
VCT-3	MANNINGTON, VCT, COLOR POINT, CREME BEIGE
BASE	
RB-1	JOHNSONITE, 76 CINNAMON, 6" RUBBER BASE ROLL (NO STICK). 4" BASE WHERE WINDOW FRAMES ARE AT 4" A.F.F.
EXPANSION JOINT	
INPRO J101 - A01 FOR FLOOR TO FLOOR & J101 - A02 FOR FLOOR TO WALL, BLACK SANTPRENE SEAL, INPRO J113 - A07 FOR WALL TO WALL JOINTS, OFF-WHITE SANTOPRENE SEAL	
WALL PAINT GLIDDEN PROFESSIONAL, LIFEMASTER NO VOC, 30YV 71/138, FLAXEN WHITE, SEMI-GLOSS LATEX ENAMEL	
PT-1	
DOOR AND WINDOW FRAME PAINT	
PT-2	GLIDDEN PROFESSIONAL, DEVFLEX 4216, 30YV 71/138, FLAXEN WHITE, SEMI-GLOSS LATEX ENAMEL
HAND RAIL	
HR-1	INPRO 2000W, WOODLAND GROUP, 0535, HONEY NUT
CHAIR RAIL	
CR-1	INPRO 2500, 0288 CHESTNUT, 2"
WALL GUARD	
WG-1	PAWLING CORPORATION, CGF-888-1HR, FIRE RATED ENDWALL PROTECTION, BROWN- OR EQUIVALENT
CORNERGUARD	
CG-1	INPRO 170FR, 0288 CHESTNUT
CG-2	PAWLING CORPORATION, CGF-888-1HR, FIRE RATED ENDWALL PROTECTION, BROWN- OR EQUIVALENT
PLASTIC LAMINATE	
PL-1	WILSONART, WILLOWSTONE 4791K-52
PORCELAIN TILE	
CT-1	AMERICAN OLEAN, PORCELAIN TILE, AVENUE ONE, AU03 PLAYGROUND SAND 12"x12" WITH 3"x12" BULLNOSE
TUMBLLED SLATE TILE	
CT-2	AMERICAN OLEAN, TUMBLLED SLATE, NATURAL STONE, INDIA MULTICOLOR TU72, 2"x2" (MESH MOUNTED ON 12"x12" SHEETS)
TILE GROUT	
GR-1	LATICRETE, EPOXY GROUT, 39 MUSHROOM
DOOR PROTECTION	
DP-1	INPRO DESIGNER KICKPLATES MODEL 10, 0288 CHESTNUT

FINISH SCHEDULE						
ROOM NUMBER	ROOM NAME	WALL FINISH	BASE FINISH	FLOOR FINISH	CEILING FINISH	CEILING HEIGHT
C075	CORRIDOR	PT-1	RB-1	VCT-1	ACT-1/PT1	9'-4"
C076	CORRIDOR	PT-1	RB-1	VCT-1/VCT-2	ACT-1/PT1	9'-4"
C042/C043	WAITING AREA	PT-1	RB-1	VCT-1	ACT-1/PT1	VARIES
C079	LOBBY	PT-1	RB-1	VCT-1/VCT-2	ACT-1/PT1	9'-4"
C081	LOBBY	EXISTING	RB-1	VCT-1/VCT-2	ACT-1	9'-4"
C082	LOBBY	EXISTING	RB-1	VCT-1/VCT-2	ACT-1	9'-4"
D061	CORRIDOR	PT-1	RB-1	VCT-1	ACT-1	9'-4"
D051/D052	NURSE STATIONS	PT-1	RB-1	VCT-1	ACT-1/PT1	9'-4"
D060	CORRIDOR	PT-1	RB-1	VCT-1	ACT-1	9'-4"
D059	CORRIDOR	PT-1	RB-1	VCT-1	ACT-1	9'-4"
D058	CORRIDOR	PT-1	RB-1	VCT-1	ACT-1	9'-4"
C080	COORIDOR	PT-1	RB-1	VCT-1	ACT-1	9'-4"
C083	COORIDOR	PT-1	RB-1	VCT-1	ACT-1	9'-4"
C084	CORRIDOR	PT-1	RB-1	VCT-1	ACT-1	9'-4"
C085	CORRIDOR	PT-1	RB-1	VCT-1	ACT-1	9'-4"
C021	VESTIBULE	PT-1	RB-1	VCT-1	ACT-1	9'-4"
C023	OFFICE	PT-1	RB-1	EXISTING	ACT-1	9'-4"
						PT-1 ON (NEW) WEST WALL ONLY

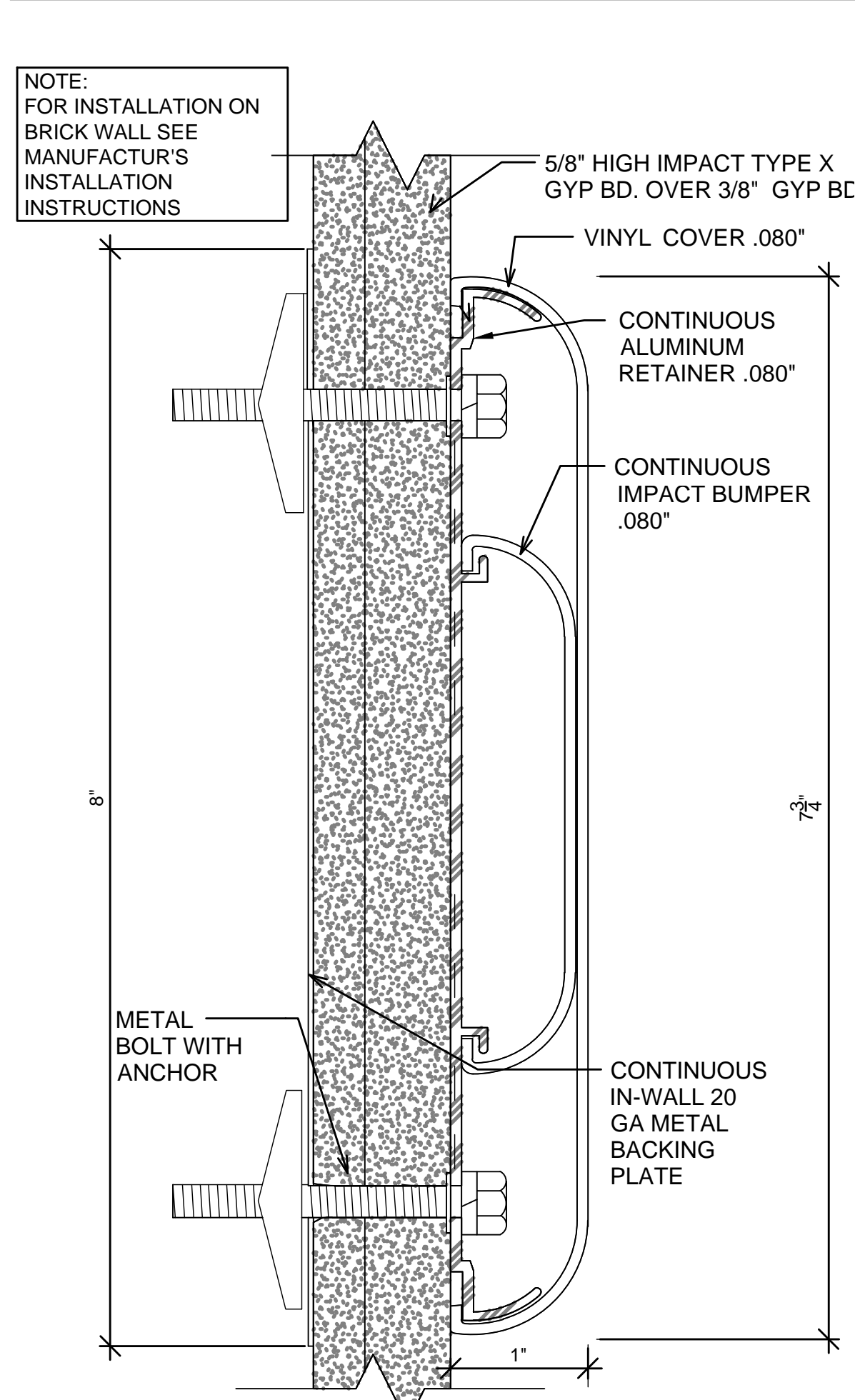

5 WALL GUARD DETAIL - 7-3/4"
1/2" = 1'-0"

ARCHITECTURAL GRAPHICAL LEGEND

EXISTING TO REMAIN

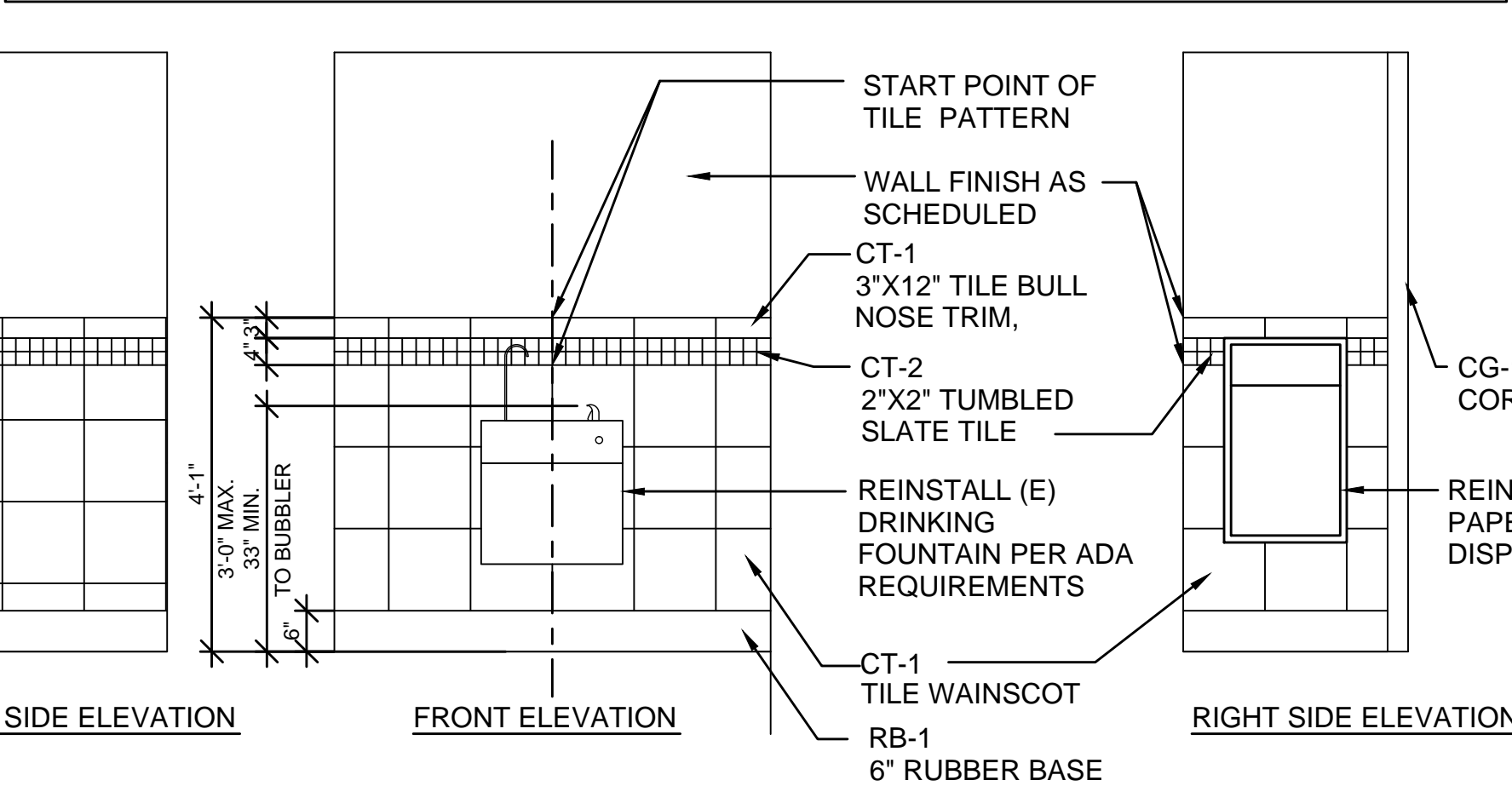
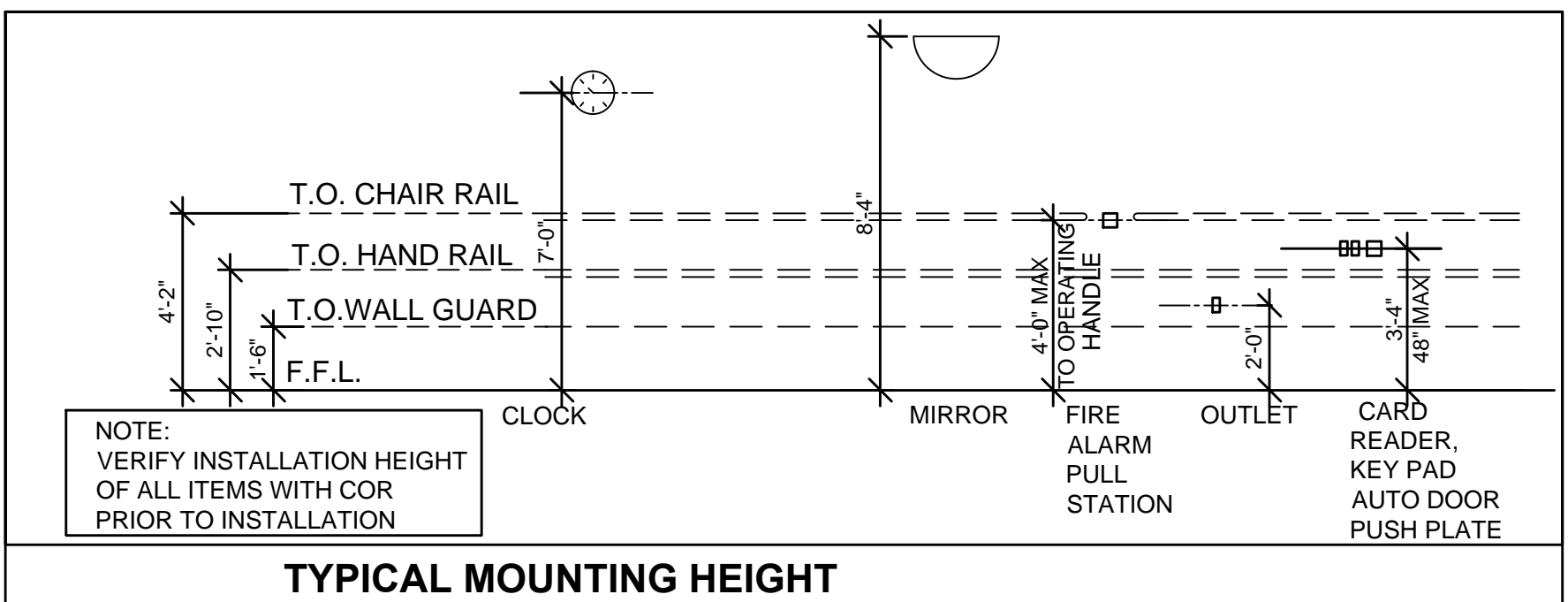

4 WALL MOUNTED DRINKING FOUNTAIN ALCOVE
1/2" = 1'-0"

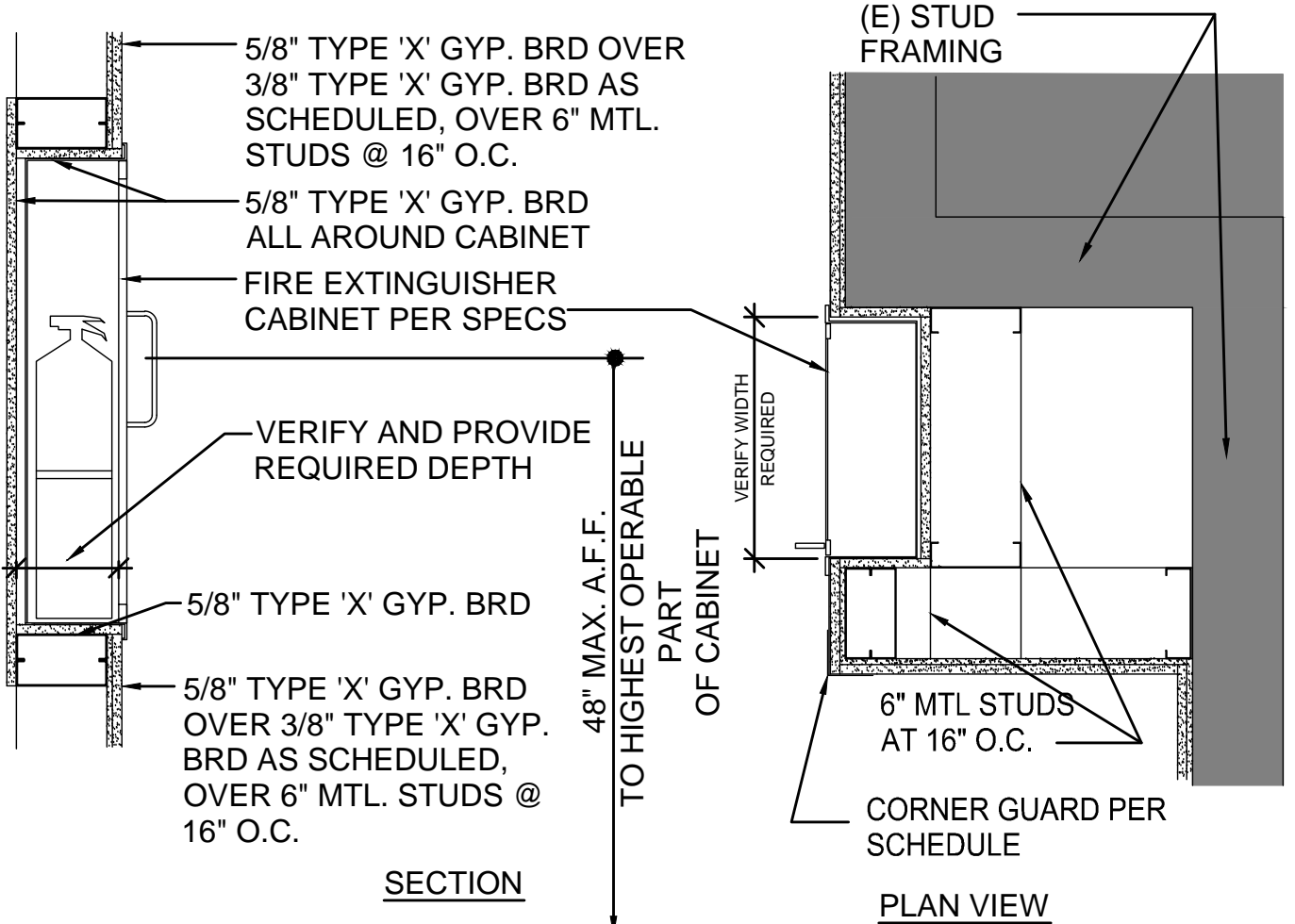

12 FIRE EXTINGUISHER CABINET DETAIL
1/2" = 1'-0"

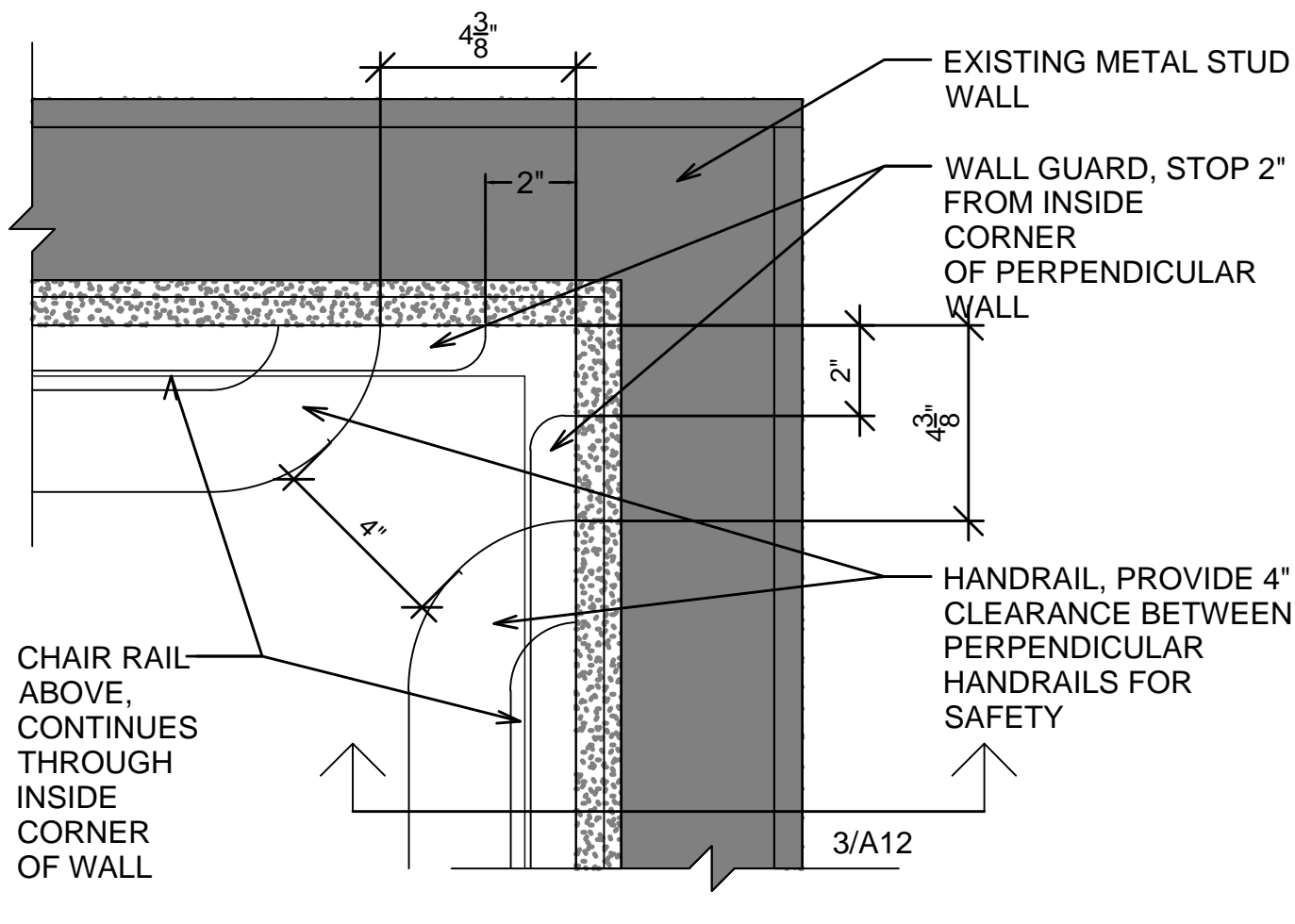

9 INSIDE WALL CORNER W/ PERPENDICULAR WALL PROTECTION
3" = 1'-0"

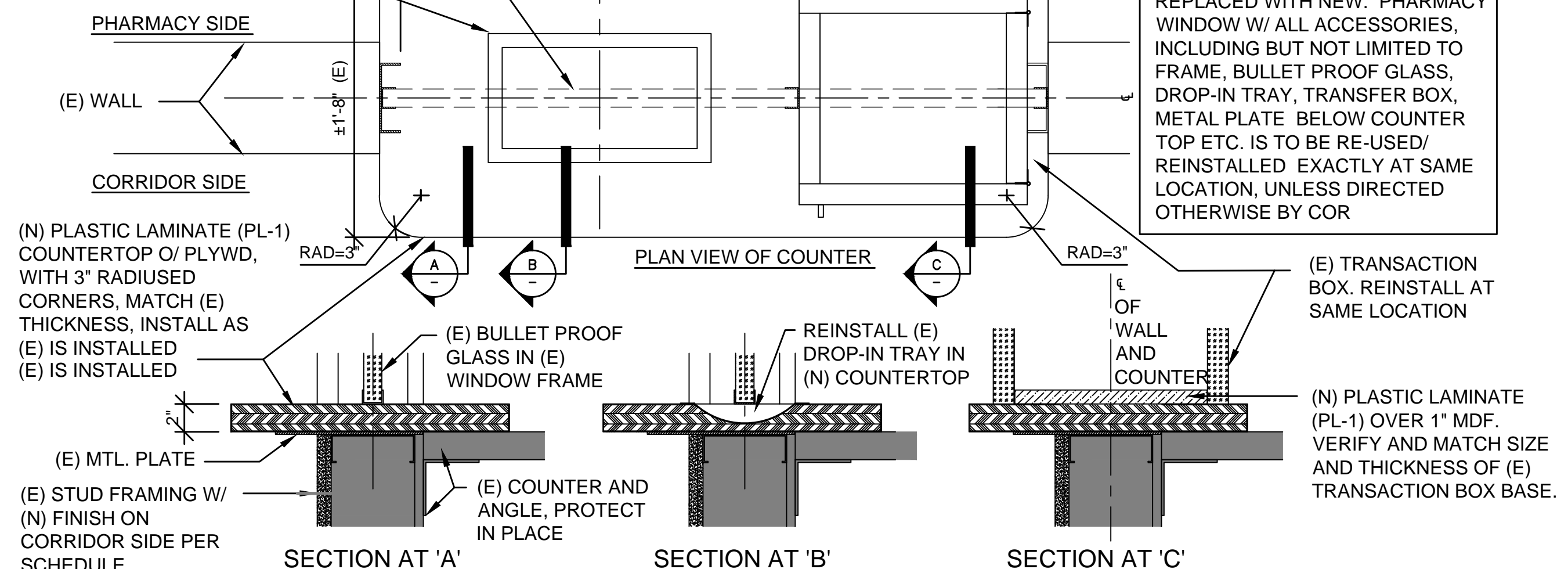

11 PHARMACY COUNTER
1 1/2" = 1'-0"

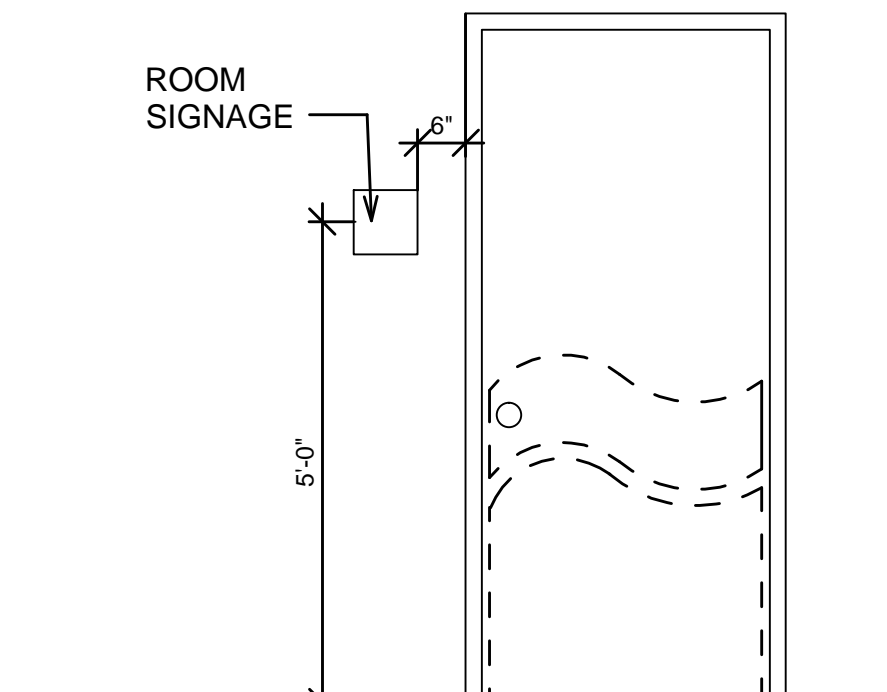

8 TYP. ROOM SIGNAGE AND MOUNTING HEIGHT
1/2" = 1'-0"

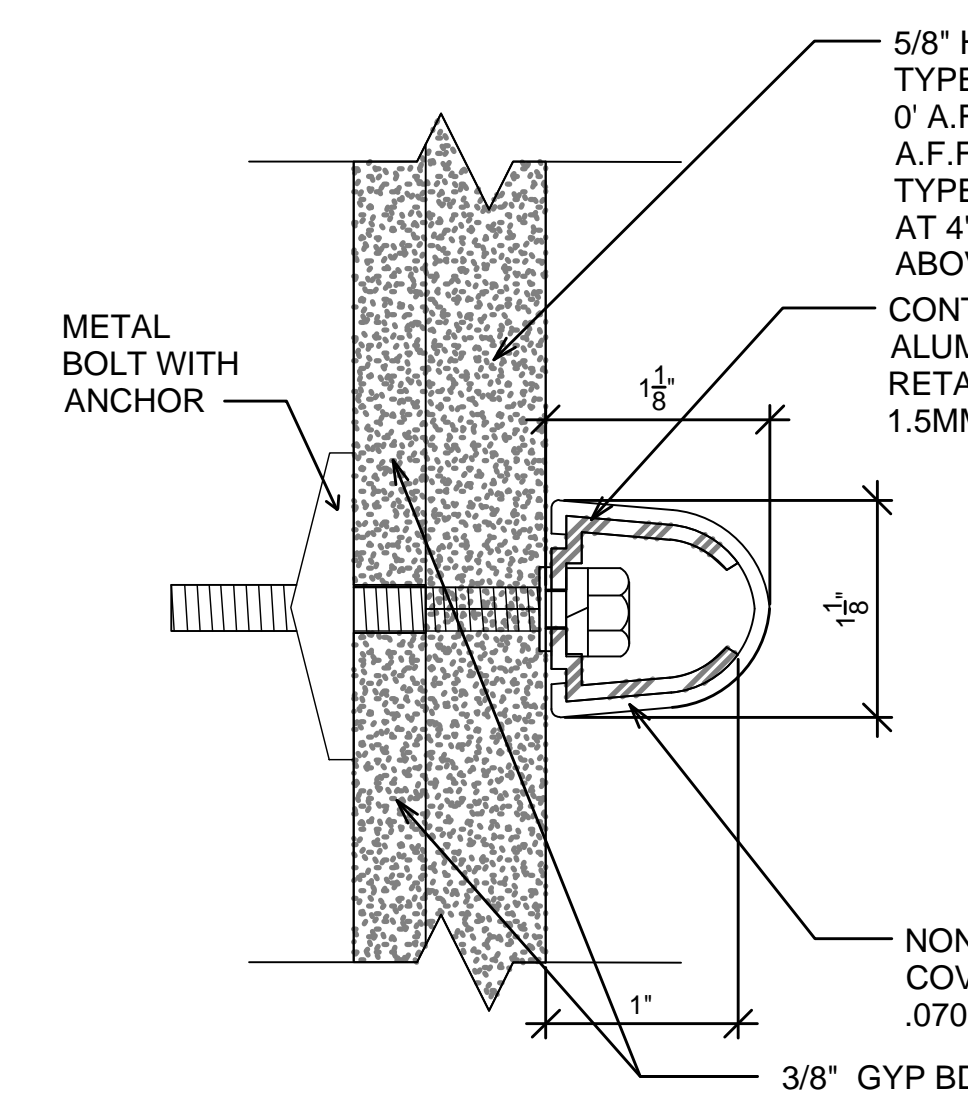

7 CHAIR RAIL DETAIL
12" = 1'-0"

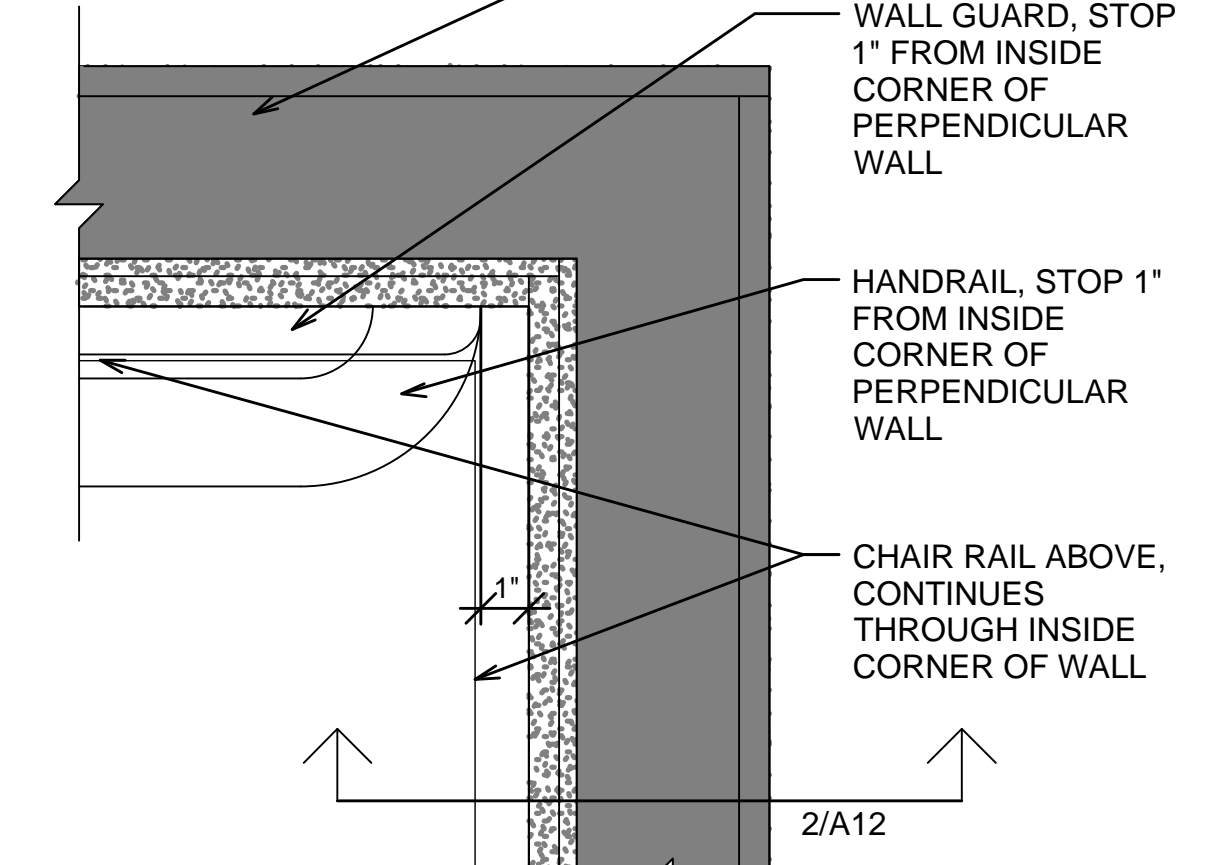

10 INSIDE WALL CORNER WITHOUT PERPENDICULAR WALL PROTECTION
3" = 1'-0"

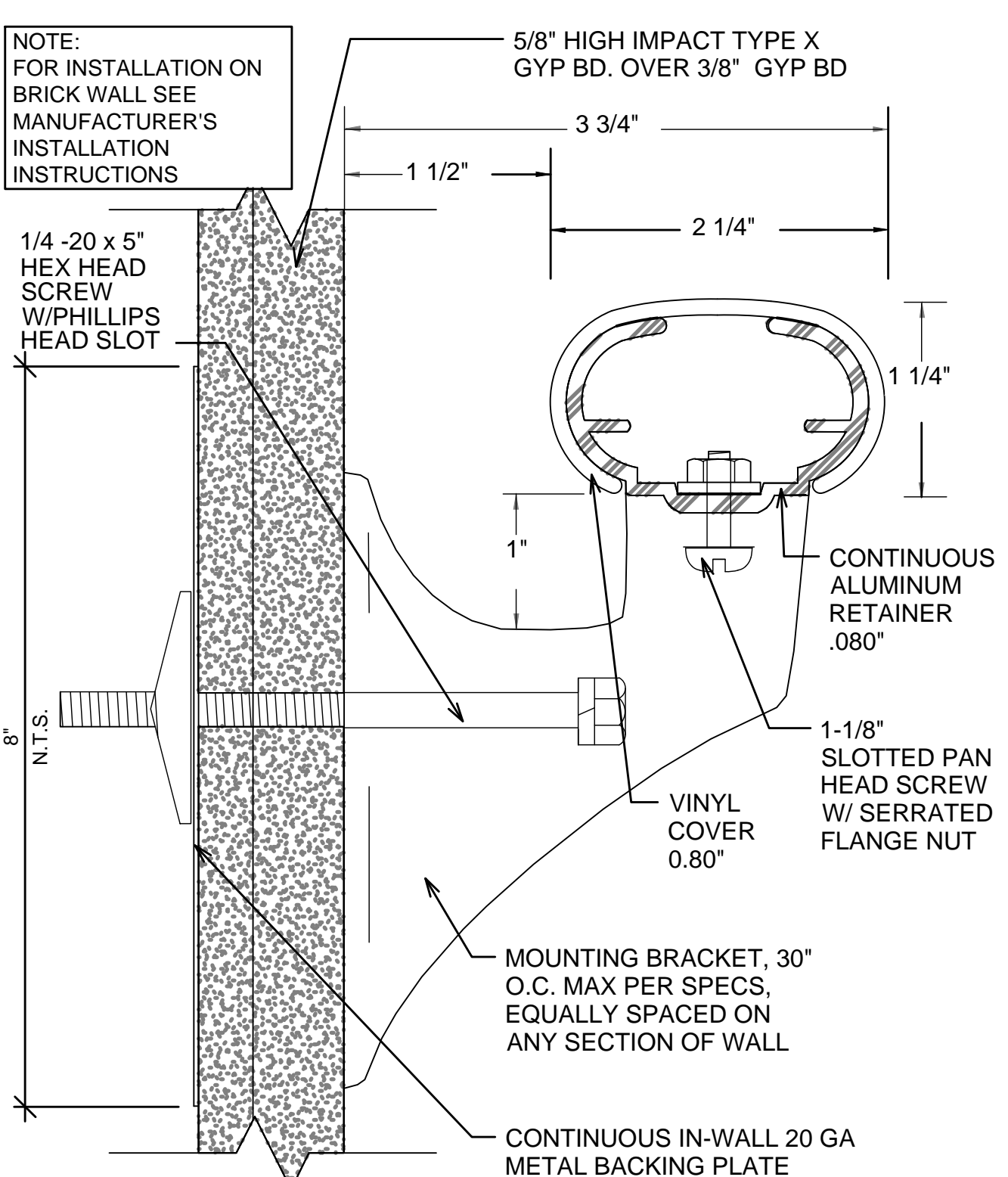

6 HANDRAIL DETAIL
12" = 1'-0"

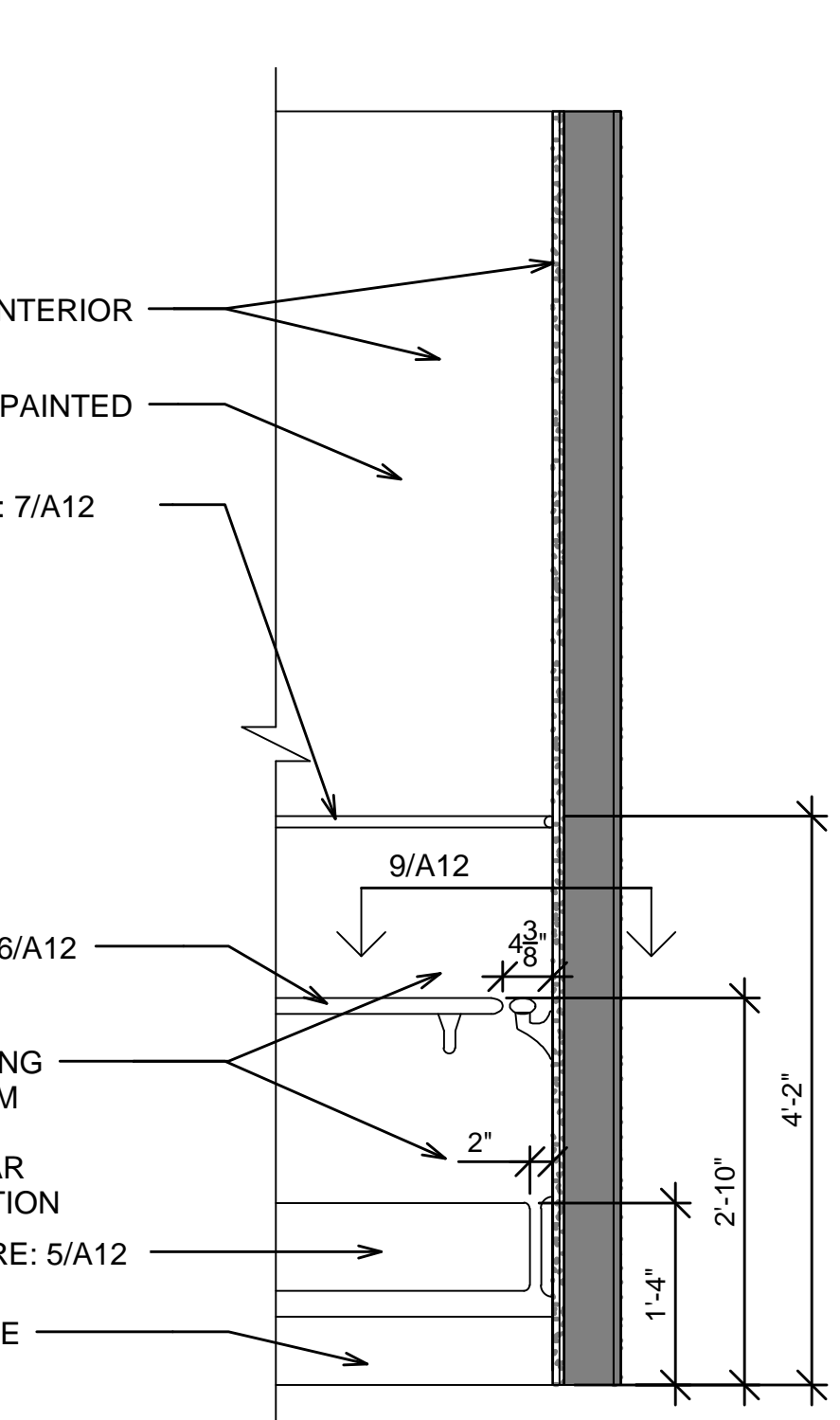

3 TYPICAL INTERIOR ELEVATION WITH PERPENDICULAR PROTECTION
3/4" = 1'-0"

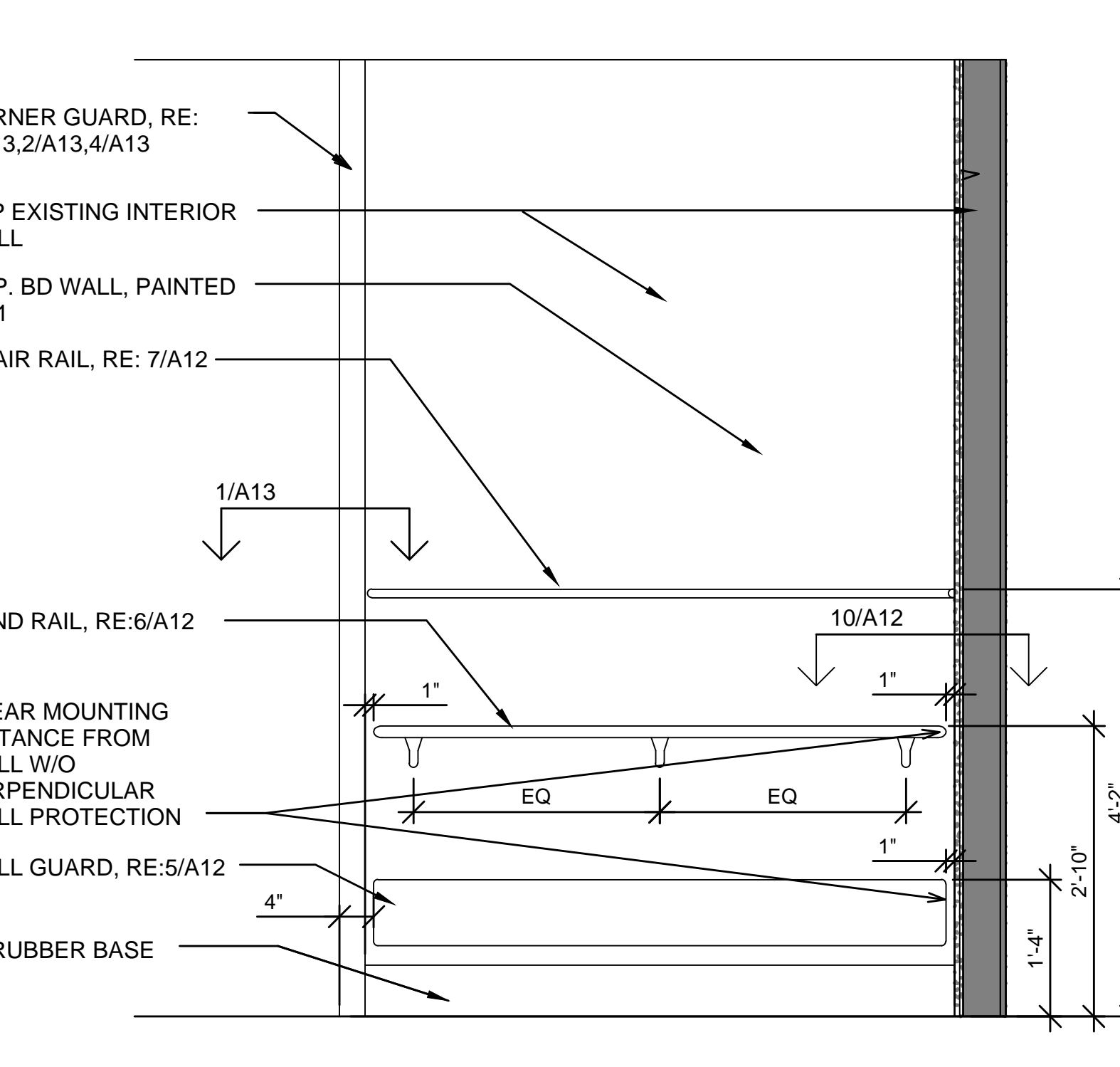

2 TYP. INTERIOR ELEVATION WITHOUT PERPENDICULAR PROTECTION
3/4" = 1'-0"

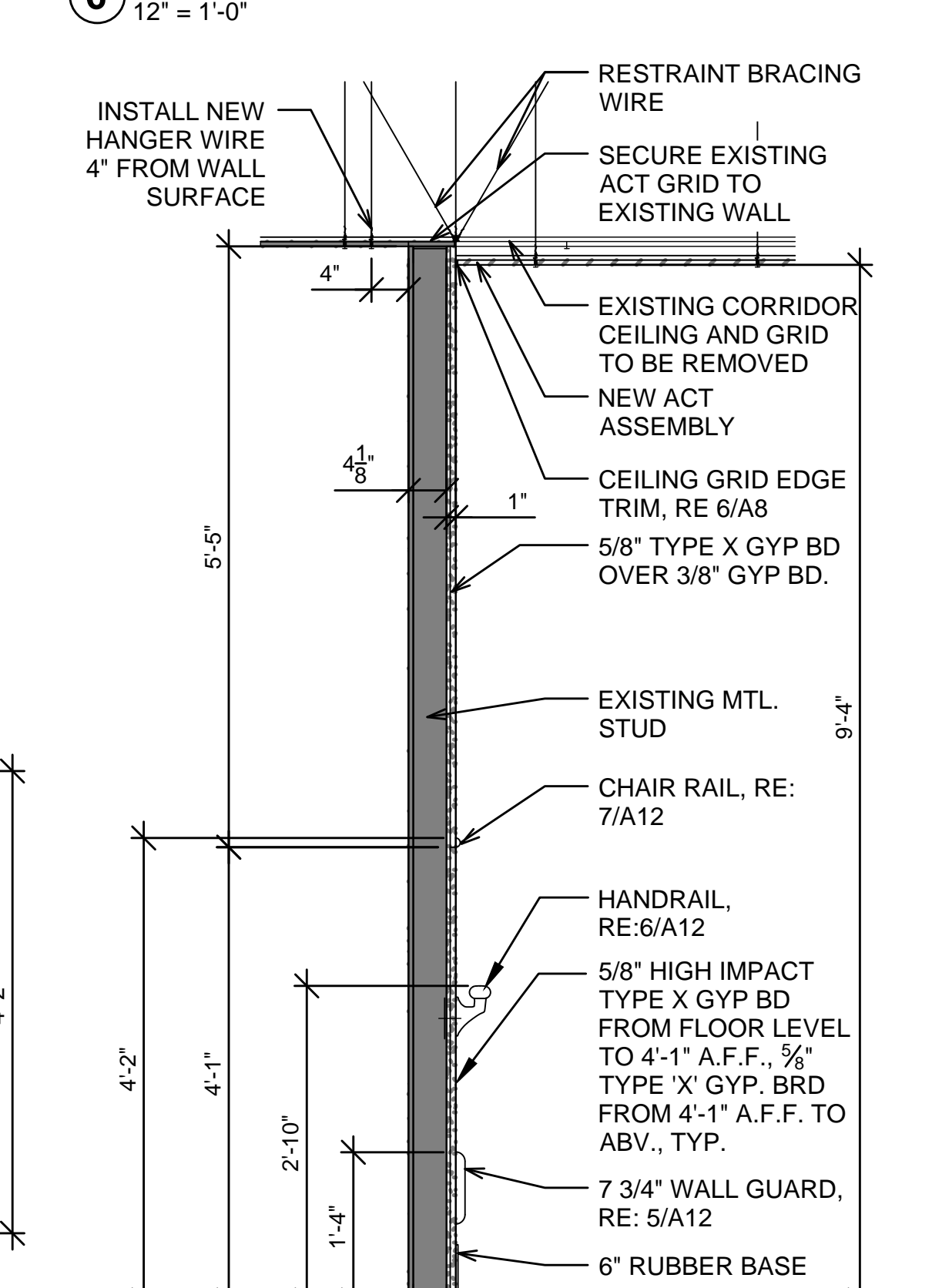

1 CORRIDOR WALL ASSEMBLY - TYP.
3/4" = 1'-0"

Revisions	Date

NOTE:
THE RESIDENT ENGINEER MUST BE NOTIFIED 24 HOURS IN ADVANCE OF ANY COMPROMISE IN THE FIRE SUPPRESSION OR SMOKE DETECTION SYSTEMS. A COPY OF THE INTERIM LIFE SAFETY CODE MEASURES MUST BE OBTAINED AND FOLLOWED DURING CONSTRUCTION.

Approved: Service Chief	Approved: Service Chief
Concur M & O	Approved: Service Chief
Concur Bio-Med	Approved: Service Chief
Concur Safety	Approved: Service Chief
Approved: Service Chief	Approved: Admin. Officer

Drawing Title
SCHEDULE AND DETAILS
Approved: Chief of Engineering
Approved: Associate Director

Project Title
SPINAL CORD INJURY UNIT CORRIDORS RENOVATION
Building Number
1
Checked
RM
Drawn
NS
Location
AUDIE L. MURPHY MEMORIAL VETERANS HOSPITAL - SAN ANTONIO, TEXAS

Date
04-04-2013
Project No.
671-13-105
DRAWING NO.
A12

