

PROJECT: ICVA-ICVA-EXPAND BUILDING FOR FACT PROJECT
SHEET TITLE: FACILITY-1125505-LEVEL 1-F-1125505-ICVA-ICVA
DRAWN BY: JMB
CHECKED BY: JMB
DATE: 05/21/2013

ONE-EIGHTH INCH = ONE FOOT
ONE-FOURTH INCH = ONE FOOT
ONE-HALF INCH = ONE FOOT
THREE-FOURTHS INCH = ONE FOOT
THREE-QUARTERS INCH = ONE FOOT
ONE INCH = ONE FOOT
ONE AND ONE-HALF INCHES = ONE FOOT
THREE INCHES = ONE FOOT

REVISIONS

DATE

REVISIONS

DATE

REVISIONS

DATE

VA FORM 08-6231, FEB. 1983

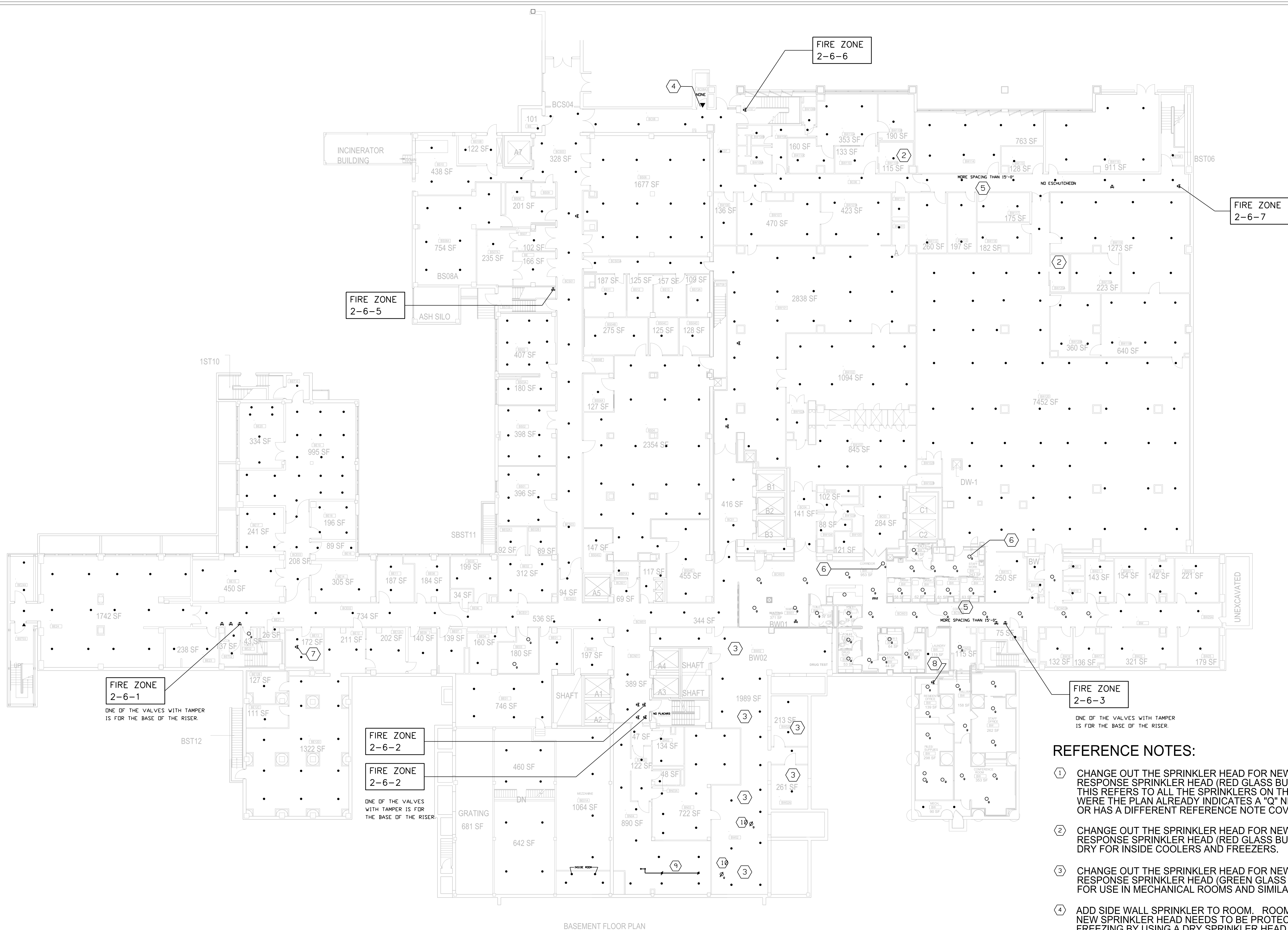

1 THIS NOTE APPLIES THE ENTIRE FLOOR.

REFERENCE NOTES:

- CHANGE OUT THE SPRINKLER HEAD FOR NEW QUICK RESPONSE SPRINKLER HEAD (RED GLASS BULB COLOR). THIS REFERS TO ALL THE SPRINKLERS ON THIS LEVEL EXCEPT WERE THE PLAN ALREADY INDICATES A 'Q' NEXT TO THE HEAD OR HAS A DIFFERENT REFERENCE NOTE COVERS THE AREA.
- CHANGE OUT THE SPRINKLER HEAD FOR NEW QUICK RESPONSE SPRINKLER HEAD (RED GLASS BULB COLOR) DRY FOR INSIDE COOLERS AND FREEZERS.
- CHANGE OUT THE SPRINKLER HEAD FOR NEW QUICK RESPONSE SPRINKLER HEAD (GREEN GLASS BULB COLOR) FOR USE IN MECHANICAL ROOMS AND SIMILAR SPACES.
- ADD SIDE WALL SPRINKLER TO ROOM. ROOM IS NOT HEATED. NEW SPRINKLER HEAD NEEDS TO BE PROTECTED FROM FREEZING BY USING A DRY SPRINKLER HEAD. CONNECT TO THE SPRINKLER LINE FROM CORRIDOR.
- SPACING BETWEEN SPRINKLER HEADS IS GREATER THAN THE NFPA 13 15'-0" LIMIT. ADD AN ADDITIONAL SPRINKLER HEAD. REPLACE THE EXTENDED COVERAGE SPRINKLER HEADS USED IN THIS SPACING THAT IS MORE THAN 15'-0".
- SPRINKLER HEAD IS PRESENTLY SERVED BY SPRINKLER ZONE ON OTHER SIDE OF THE DOUBLE DOORS. REPIPE THIS SPRINKLER HEAD SUCH THAT IT IS SERVED BY THE SAME SPRINKLER ZONE AS REST OF THE CORRIDOR.
- REPLACE THE SPRINKLER HEADS IN THE EAST LAUNDRY CHUTE. SHUT OFF VALVE IS IN THE CEILING OF LAUNDRY ROOM. SPRINKLER HEADS ARE LOCATED AT THE CHUTE OPENINGS ON LEVELS 1, 3, 5, 7, 9, AND 10. ALL SPRINKLER HEADS SHALL BE REPLACED IN ONE SHUT-DOWN.
- REPLACE THE SPRINKLER HEADS IN THE WEST LAUNDRY CHUTE. SHUT OFF VALVE IS IN THE CEILING ROOM SOUTH OF LAUNDRY ROOM. SPRINKLER HEADS ARE LOCATED AT THE CHUTE OPENINGS ON LEVELS 1, 3, 5, 7, 9, AND 10. ALL SPRINKLER HEADS SHALL BE REPLACED IN ONE SHUT-DOWN.
- REMOVE THE EXPOSED SPRINKLER PIPING AND SPRINKLER HEADS UNDER THE BULKHEAD. CAP PIPING PER NFPA 13.
- ADD UNDER DUCT SPRINKLER HEADS (QUICK RESPONSE) IN THE MECHANICAL ROOM BW02 IN THE TWO PLACES SHOWN.

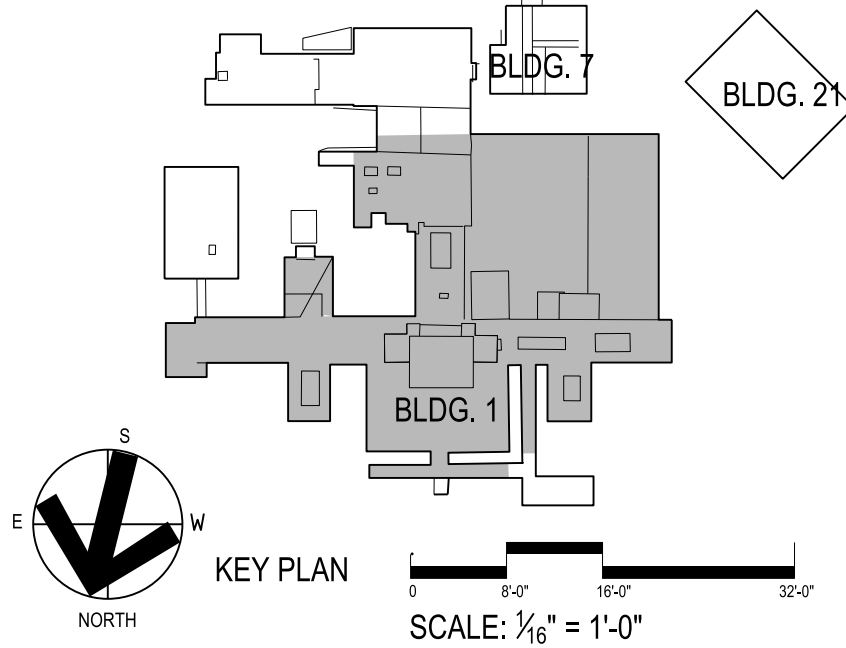

project number
11-25505

DRAWING TITLE
**FIRE SPRINKLER PLAN
LEVEL BASEMENT**

PROJECT TITLE
REPLACE SPRINKLER HEADS

BUILDING NO.
BLDG 1

CHECKED
JMB

DRAWN
JMB

LOCATION
ICVA HEALTH CARE SYSTEM

DATE
05/21/2013

PROJECT NO.
636A8-13-001

DRAWING NO.
1-F1

DWG. 2 OF 9



DEPARTMENT OF
VETERANS AFFAIRS