

one eighth inch = one foot
0 4 8 16
one quarter inch = one foot
0 4 8
one half inch = one foot
0 4 8
three eighths inch = one foot
0 4 8
one inch = one foot
0 6 12
three quarters inch = one foot
0 6 12
one and one half inches = one foot
0 6 12
three inches = one foot
0 6 12

Revisions
Date

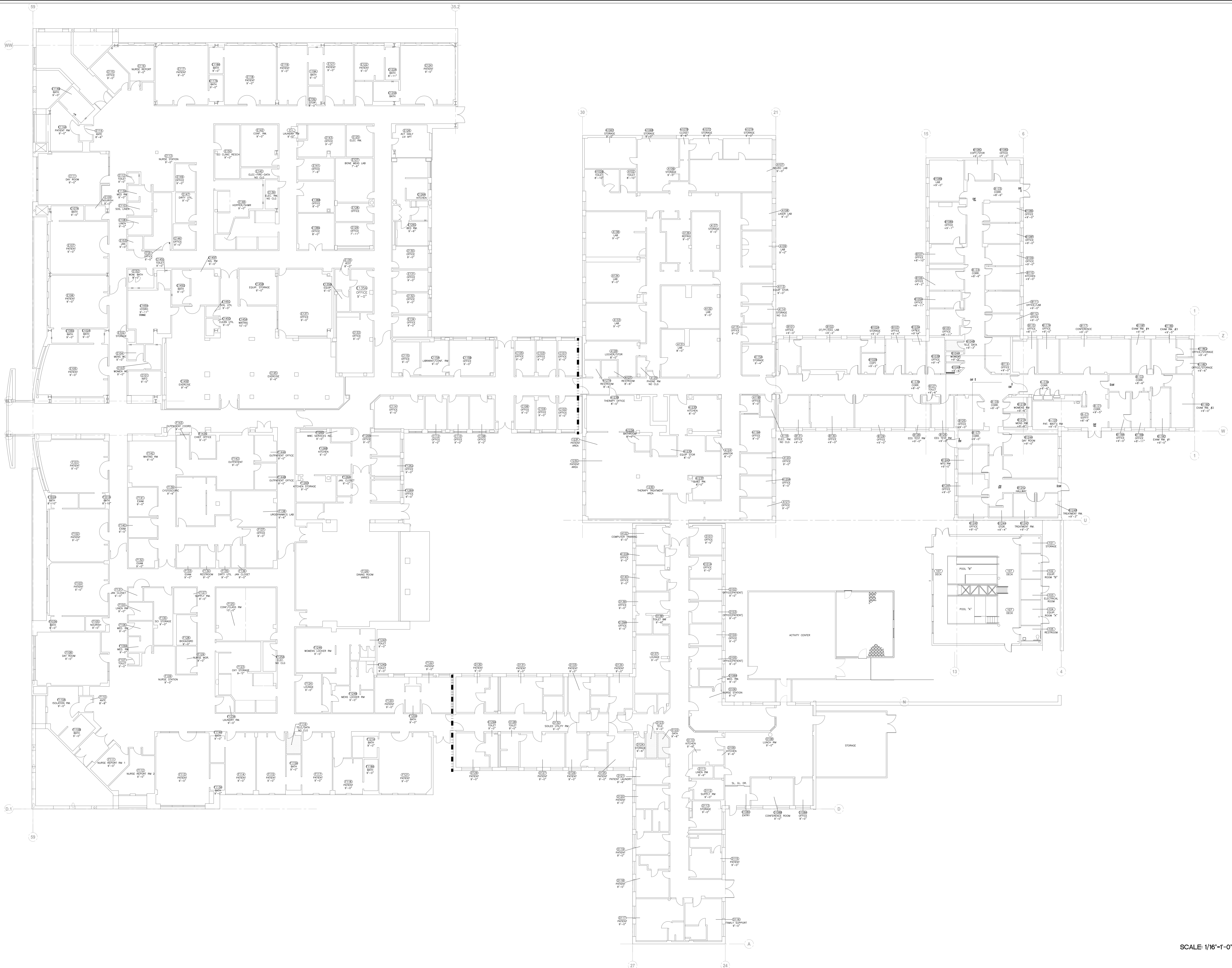

CONSULTANTS:

ARCHITECT/ENGINEERS:

Drawing Title
BUILDING 7
FIRST FLOOR PLAN

Approved Project Director
-
VAPAHCS PLANNING AND ENGINEERING

Project Title
BUILDING 7
(FOR REFERENCE ONLY)
(NOT FIELD VERIFIED)

Location
PAD PALO ALTO CA
Date
1/3/2012
Checked
JR
Drawn
JPM

SCALE: 1/16"=1'-0"

Project Number
0000000
Building Number
007
Drawing Number
-
Dwg. -- of --

Office of
Construction
and Facilities
Management

Department of
Veterans Affairs