

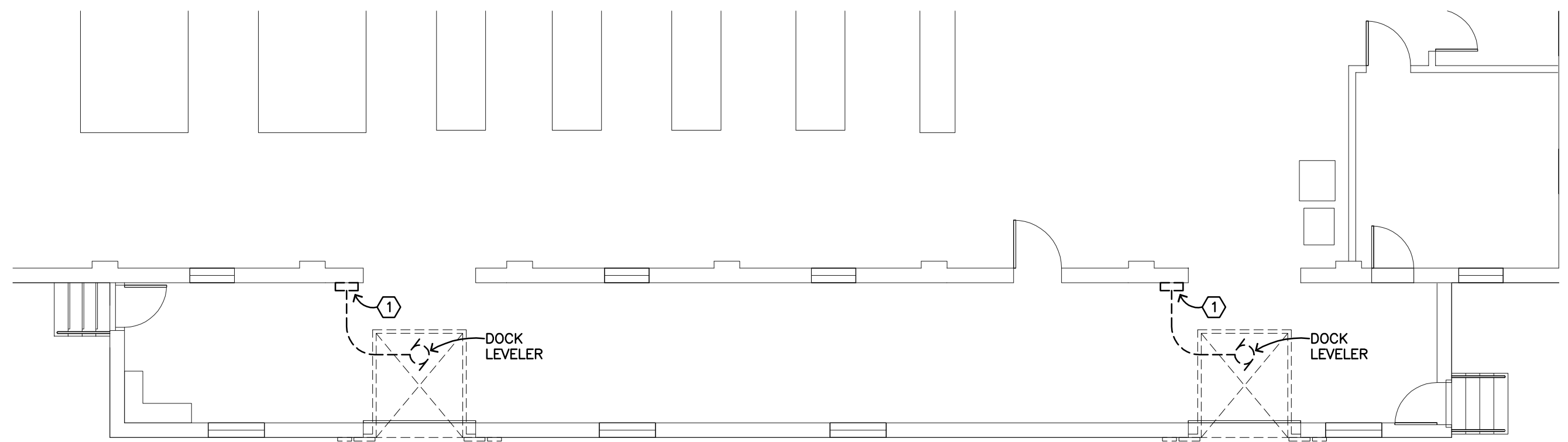

1
E1
BUILDING 1 - ELECTRICAL



2
E1
BUILDING 12 - ELECTRICAL

GENERAL NOTES:

1. THE PROJECT MUST BE DONE IN PHASES TO ENSURE AT LEAST ONE LOADING DOCK IS OPERATIONAL AT ALL TIMES IN BOTH BUILDING 12 AND BUILDING 1.

PLAN NOTES:

- ① DISCONNECT EXISTING DOCK LEVELER AND REMOVE EXISTING DOCK LEVELER CONTROLS. PROVIDE AND INSTALL NEW CONTROL PANEL IN THE SAME LOCATION. CONNECT NEW DOCK LEVELER AND CONTROLS. REUSE EXISTING CONDUIT AND CONNECT TO EXISTING CIRCUIT USING EXISTING CONDUCTORS. PROVIDE NEW CONDUCTORS TO CONNECT THE NEW CONTROLLER TO THE NEW PUMP AND DEVICES AT THE LEVELER. COORDINATE ALL WIRING REQUIREMENTS WITH THE LEVELER SUPPLIER.
- ② WORK AT NORTH DOCK TO BE DELETED UNDER DEDUCT ALTERNATE #3.
- ③ WORK AT SOUTH DOCK TO BE DELETED UNDER DEDUCT ALTERNATE #4.

J:\Projects\2013\13-100\Draws\13-100 E1.dwg/17/2013 10:12 AM

Revisions	Date

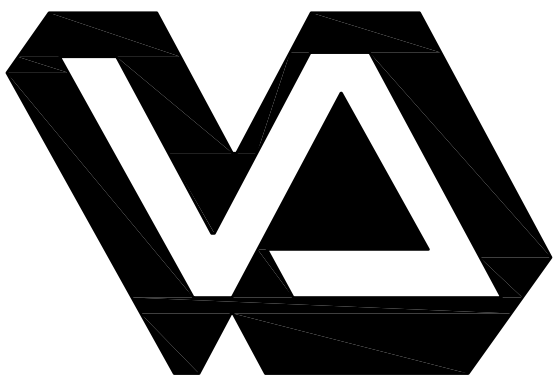

Dept. of Veterans Affairs
Medical Center
2101 Elm Street
Fargo, ND 58102

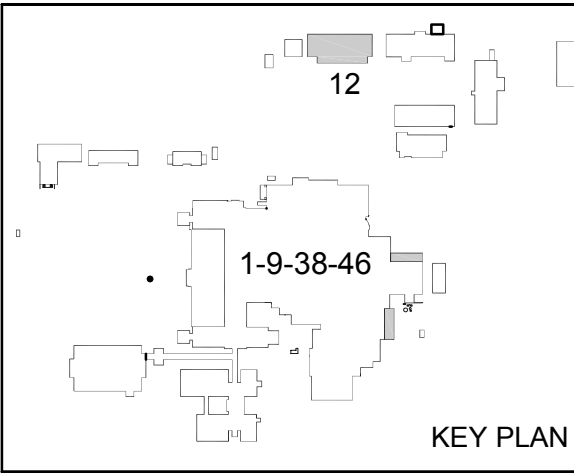

Drawing Title BUILDING 1 AND BUILDING 12 LOADING DOCKS - ELECTRICAL		
VA Project No. 437-13-119	Contract No. VA263-P-1218 VA263-P- VA263-P-	AutoCAD File Name 13-100 E1.DWG
Building No. #12, and #1-9-38-46	Location VA HEALTHCARE SYSTEM FARGO, NORTH DAKOTA	

Project Title REPLACE LOADING DOCK LEVELERS			Date 05-17-13
Scale: AS SHOWN			Drawing No. E1
Designed By MB	Checked By MB	Drawn By TP	Dwg. 4 of 4

