

F:\projects\1393 VA Central Valley\001 Bld 24 Seismic Corrections & Addition\18-CAD\ACA\Sheets\CLARIFICATION DRAWINGS\AD-A01 PARTIAL FLOOR PLAN.dwg 6/7/2013 8:52 AM Cheng Lo

PROJECT NUMBER 570-215

BUILDING NO. 24

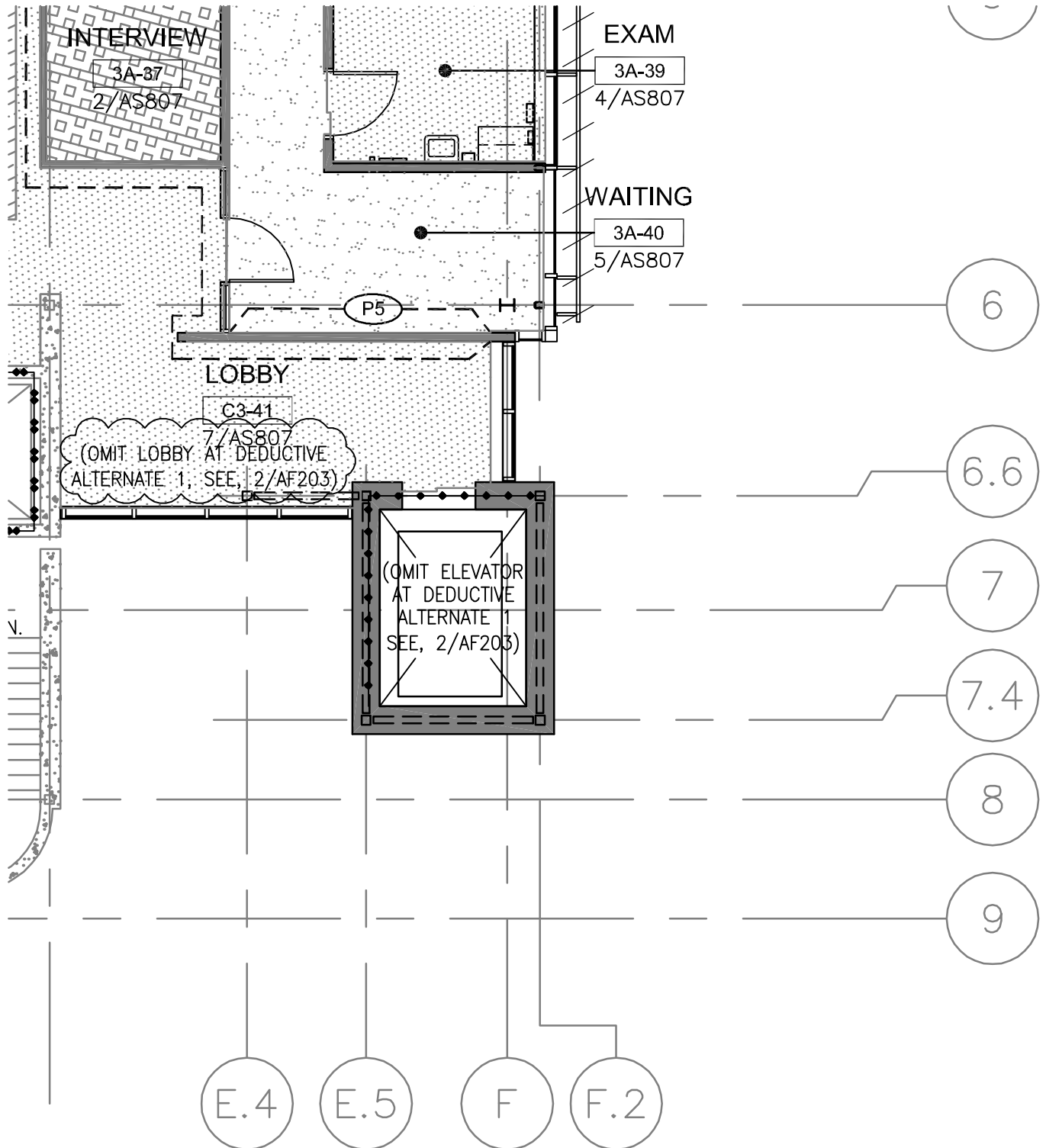

Drawing Title: PARTIAL FLOOR PLAN

Reference Drawing: AF203

Scale:  
1/8" = 1'-0"

Project No.  
1393001

Date:  
06/05/2013

**HMC**Architects

1827 E. Fir Avenue, Studio 103 / Fresno, CA 93720  
T 559 322 2444 / www.hmcarchitects.com

**BUILDING 24  
SEISMIC  
CORRECTION  
AND ADDITION**

**Office of  
Construction  
and Facilities  
Management**

Department of  
Veterans Affairs

**AD-A01**