

three eighths inch = one foot
one eighth inch = one foot
one quarter inch = one foot
three quarters inch = one foot
one half inch = one foot
one inch = one foot
one and one half inches = one foot
two inches = one foot
three inches = one foot
four inches = one foot
five inches = one foot
six inches = one foot
seven inches = one foot
eight inches = one foot
nine inches = one foot
ten inches = one foot
eleven inches = one foot
twelve inches = one foot
thirteen inches = one foot
fourteen inches = one foot
fifteen inches = one foot
sixteen inches = one foot
seventeen inches = one foot
eighteen inches = one foot
nineteen inches = one foot
twenty inches = one foot
twenty one inches = one foot
twenty two inches = one foot
twenty three inches = one foot
twenty four inches = one foot
twenty five inches = one foot
twenty six inches = one foot
twenty seven inches = one foot
twenty eight inches = one foot
twenty nine inches = one foot
thirty inches = one foot
thirty one inches = one foot
thirty two inches = one foot
thirty three inches = one foot
thirty four inches = one foot
thirty five inches = one foot
thirty six inches = one foot
thirty seven inches = one foot
thirty eight inches = one foot
thirty nine inches = one foot
forty inches = one foot
forty one inches = one foot
forty two inches = one foot
forty three inches = one foot
forty four inches = one foot
forty five inches = one foot
forty six inches = one foot
forty seven inches = one foot
forty eight inches = one foot
forty nine inches = one foot
fifty inches = one foot
fifty one inches = one foot
fifty two inches = one foot
fifty three inches = one foot
fifty four inches = one foot
fifty five inches = one foot
fifty six inches = one foot
fifty seven inches = one foot
fifty eight inches = one foot
fifty nine inches = one foot
sixty inches = one foot
sixty one inches = one foot
sixty two inches = one foot
sixty three inches = one foot
sixty four inches = one foot
sixty five inches = one foot
sixty six inches = one foot
sixty seven inches = one foot
sixty eight inches = one foot
sixty nine inches = one foot
seventy inches = one foot
seventy one inches = one foot
seventy two inches = one foot
seventy three inches = one foot
seventy four inches = one foot
seventy five inches = one foot
seventy six inches = one foot
seventy seven inches = one foot
seventy eight inches = one foot
seventy nine inches = one foot
eighty inches = one foot
eighty one inches = one foot
eighty two inches = one foot
eighty three inches = one foot
eighty four inches = one foot
eighty five inches = one foot
eighty six inches = one foot
eighty seven inches = one foot
eighty eight inches = one foot
eighty nine inches = one foot
ninety inches = one foot
ninety one inches = one foot
ninety two inches = one foot
ninety three inches = one foot
ninety four inches = one foot
ninety five inches = one foot
ninety six inches = one foot
ninety seven inches = one foot
ninety eight inches = one foot
ninety nine inches = one foot
one hundred inches = one foot

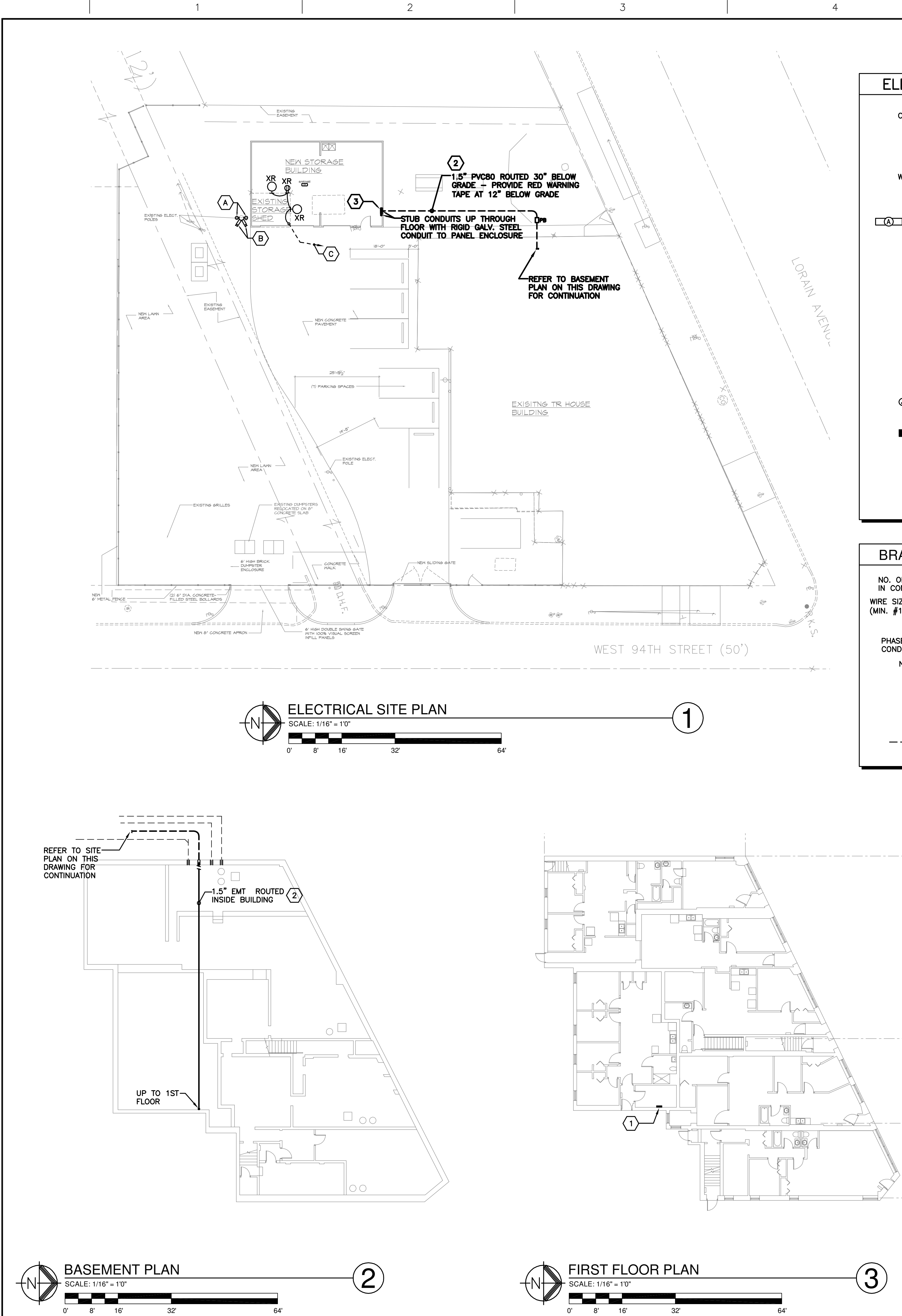

ELECTRICAL LEGEND

- CM 20A-125V, EXTRA HEAVY DUTY, DUPLEX RECEPTACLE. CEILING MOUNT FOR GARAGE DOOR OPENER - COORDINATE EXACT LOCATION WITH GARAGE DOOR VENDOR. COLOR SHALL BE BROWN WITH BROWN NYLON WALLPLATE.
- 20A-125V, EXTRA HEAVY DUTY, SELF TEST GFCI, DUPLEX RECEPTACLE. MOUNT FLUSH AT 24" ABOVE FLOOR UNLESS OTHERWISE NOTED. COLOR SHALL BE BROWN WITH BROWN NYLON WALLPLATE.
- WP 20A-125V, EXTRA HEAVY DUTY, SELF TEST GFCI, DUPLEX RECEPTACLE, INSTALLED IN CAST ALUMINUM WEATHERPROOF ENCLOSURE WITH LOCKING DEVICE THAT MAINTAINS WET LOCATION RATING WHILE IN-USE. CONNECT TO NORMAL 20A-120V CIRCUIT. MOUNT AT 24" ABOVE GRADE/FLOOR UNLESS OTHERWISE NOTED. RECEPTACLE COLOR SHALL BE BROWN.
- LED OR FLUORESCENT LIGHTING FIXTURE, CONNECT TO NORMAL CIRCUIT AS INDICATED - TYPE AS SPECIFIED IN SCHEDULE.
- 20A-1P-120/277V WALL SWITCH MOUNTED AT 48" AFF UNLESS OTHERWISE NOTED.
- 20A-3WAY-120/277V WALL SWITCH MOUNTED AT 48" AFF UNLESS OTHERWISE NOTED.
- 20A-1P-120/277V WALL SWITCH MOUNTED AT 48" AFF UNLESS OTHERWISE NOTED. MOUNT VERTICAL IN "WHILE-IN USE COVER" WITH CLEAR COVER AND LOCKING DEVICE OPTION.
- 120V-1Ø MANUAL MOTOR STARTER WITH INTEGRAL THERMAL OVERLOAD PROTECTION
- MOTOR OUTLET - SIZE AND TYPE AS NOTED
- JUNCTION BOX, CEILING OR WALL MOUNTED, 4" SQ. WITH GROUND LUG, UNLESS OTHERWISE NOTED. COORDINATE MOUNTING LOCATION WITH EQUIPMENT.
- 120/240V-1Ø-3W PANELBOARD UNLESS OTHERWISE NOTED. MOUNT AT 78" AFF TO TOP OF PANEL.
- FUSED DISCONNECT SWITCH - SIZE AND TYPE AS NOTED. PROVIDE CLASS RK1 FUSES UNLESS OTHERWISE NOTED. NEMA 1 ENCLOSURE UNLESS OTHERWISE NOTED.
- 120V-1Ø OR 277V-1Ø (AS REQUIRED) LOCKABLE MANUAL SWITCH (NO THERMAL OVERLOADS).

BRANCH CIRCUIT WIRING

- NO. OF CCTS IN CONDUIT
WIRE SIZE (MIN. #12AWG)
PHASE CONDUCTORS
NEUTRALS
GROUND
- BRANCH CIRCUIT HOME RUN TO PANEL - ARROWHEADS INDICATE CIRCUITS. WIRE INDICATED ARE GREEN GROUND, SEPARATE NEUTRALS (SHARED NEUTRALS ARE NOT PERMITTED FOR BRANCH CIRCUITS) AND THREE HOT LESS (A DIFFERENT PHASE FOR EACH CIRCUIT) MAXIMUM THREE CIRCUITS PER CONDUIT. 3/4" MINIMUM CONDUIT WITH WIRE SIZE INDICATED ON DRAWING ("XX" INDICATES AWG SIZE). ALL POWER WIRING SHALL BE STRANDED COPPER CONDUCTORS WITH THHN/THWN INSULATION. PROVIDE SEPARATE EQUIPMENT GROUNDING CONDUCTOR (SAME SIZE AS PHASE AND NEUTRAL, UNLESS OTHERWISE NOTED) FOR EACH CONDUIT. CONDUIT WIRE FILLS SHALL BE IN ACCORDANCE WITH LATEST NATIONAL ELECTRIC CODE.
- CONDUIT UP
CONDUIT DOWN
UNDERGROUND CONDUIT

CODED NOTES - NEW WORK:

- EXISTING 225A-120/240V-1Ø-3W MAIN SERVICE PANEL "MSP" TO REMAIN. PROVIDE (1) NEW 100A-2P BREAKER IN PANEL FOR CONNECTION TO NEW PANEL "GP". COORDINATE BREAKER REQUIREMENTS WITH PANEL MANUFACTURER. PROVIDE SCREW TYPE 1/4" MICARTA NAMEPLATE FOR DISTRIBUTION PANEL BREAKER.
- PROVIDE 1.5" CONDUIT - 3#1/0 & 1#6 EQUIPMENT GROUND FROM "MSP" TO NEW PANEL "GP". VERIFY EXACT ROUTING IN FIELD. PROVIDE ALL NECESSARY COMPONENTS (SUPPORTS, BENDS, TERMINATIONS, ETC) FOR A COMPLETE SYSTEM.
- PROVIDE NEW 100A-2Ø8/120V-3Ø-4W SURFACE MOUNTED PANEL "GP". PROVIDE TYPED PANELBOARD SCHEDULE. REFER TO PANEL FRONT DETAIL AND SPECIFICATIONS FOR ADDITIONAL REQUIREMENTS. PROVIDE SCREW TYPE 1/4" MICARTA NAMEPLATE FOR PANEL.

CODED NOTES - DEMOLITION:

- EXISTING SECURITY CAMERAS MOUNTED TO UTILITY POLE - TO REMAIN.
- EXISTING UTILITY STREET LIGHTS MOUNTED TO UTILITY POLE - TO REMAIN.
- DISCONNECT EXISTING ELECTRICAL CIRCUITS TO SHED - "MAKE SAFE" FOR DEMOLITION. TRACE CIRCUITS BACK TO FEED IN MAIN BUILDING. DISCONNECT FROM OVERCURRENT PROTECTION AND LABEL BREAKER SPARE. REMOVE WIRING COMPLETE - CONDUIT SHALL REMAIN AND BE LABELED AS REQUIRED.

GENERAL ELECTRICAL INSTALLATION NOTES:

- ALL MOUNTING HEIGHTS ARE TO CENTER OF DEVICE UNLESS OTHERWISE NOTED.
- ALL NEW WALL MOUNTED ELECTRICAL DEVICES ARE TO BE INSTALLED FLUSH IN WALL UNLESS OTHERWISE NOTED. ALL ELECTRICAL CONDUIT SHALL BE CONCEALED BEHIND FINISHED WALLS AND ABOVE FINISHED CEILING UNLESS OTHERWISE NOTED. THE COST TO CUT AND PATCH WALLS SHALL BE THE RESPONSIBILITY OF THE TRADE REQUIRING THE CUTTING.
- CONTRACTOR IS RESPONSIBLE FOR REMOVAL AND REPLACEMENT OF CEILINGS REQUIRED FOR ELECTRICAL WORK. CONTRACTOR SHALL REPLACE ANY DAMAGED CEILING TILES.
- PRIOR TO INSTALLATION, VERIFY PRECISE LOCATION OF NEW OR RELOCATED WALL OR CEILING MOUNTED DEVICES WITH ARCHITECTURAL ELEVATIONS AND REFLECTED CEILING PLANS.
- COORDINATE ALL SHUT-DOWNS OF EXISTING ELECTRICAL SYSTEMS WITH OWNER A MINIMUM OF FOURTEEN (14) WORKING DAYS IN ADVANCE. ALL SHUT-DOWNS SHALL OCCUR DURING WEEKENDS OR BETWEEN 8:00PM AND 7:00AM ON WEEKDAYS ("OFF-HOURS"). INCLUDE ALL PREMIUM TIME CHARGES IN BID.
- ALL NOISE GENERATING OPERATIONS, INCLUDING CUTTING OF CEILINGS, WALLS AND FLOORS, CORING, DRILLING, ETC. SHALL BE SCHEDULED DURING WEEKENDS OR BETWEEN 8:00PM AND 7:00AM ON WEEKDAYS ("OFF-HOURS"). INCLUDE ALL PREMIUM TIME CHARGES IN BID.
- CONTRACTOR SHALL CONNECT ALL MECHANICAL EQUIPMENT COMPLETE PER MANUFACTURER'S WIRING DIAGRAMS AND INSTRUCTIONS. COORDINATE WITH MECHANICAL CONTRACTOR AND VERIFY LOCATION, VOLTAGE, AMPS, NO. OF WIRES, AND PROTECTION REQUIREMENTS PRIOR TO ROUGH-IN. CONTACT ENGINEER WITH ANY DISCREPANCIES FROM DESIGN DRAWINGS.
- PROVIDE LIQUID-TIGHT FLEXIBLE METAL CONDUIT FOR FINAL CONNECTION TO MECHANICAL EQUIPMENT OR OTHER EQUIPMENT WHICH MAY PROPAGATE VIBRATION.
- ALL FLUORESCENT LAMPS THAT WILL NOT BE REUSED SHALL BE DISPOSED OF IN ACCORDANCE WITH EPA STANDARDS, AND WRITTEN EVIDENCE OF PROPER DISPOSAL SHALL BE FURNISHED TO THE OWNER.
- ALL WORK SHALL BE PERFORMED IN STRICT CONFORMANCE WITH THE PHASING REQUIREMENTS OF THE PROJECT. ALL COSTS ASSOCIATED WITH THESE REQUIREMENTS SHALL BE INCLUDED IN THE BID SUBMITTAL.
- CONTRACTOR IS RESPONSIBLE FOR PROVIDING TEMPORARY LIGHTING TO ADEQUATELY LIGHT ALL CONSTRUCTION AREAS, TEMPORARILY PARTITIONED AREAS, AND EXIT CORRIDORS MAINTAINED DURING CONSTRUCTION.
- DEFINITION: "PROVIDE" - FURNISH, INSTALL AND CONNECT COMPLETE.
- PROJECT AND PHASING SCOPE LINES INDICATE WHERE GENERAL CONSTRUCTION BOUNDARIES OCCUR. ELECTRICAL WORK AND UTILITY TIE-INS MAY OCCUR OUTSIDE OF SCOPE LINES.

GENERAL LEGEND

- CODED NOTE - "1" INDICATES NOTE NUMBER.
- DETAIL REFERENCE - "1" INDICATES DETAIL NUMBER, "1-E01" INDICATED DRAWINGS NUMBER.
- COLUMN GRID
- REVISION REFERENCE NUMBER

ABBREVIATIONS

AC	ABOVE COUNTER AT 9" UNLESS OTHERWISE NOTED	AFC	ABOVE FINISHED CEILING
AF	AMP FRAME	AT	AMP TRIP
AFF	ABOVE FINISHED FLOOR	ATS	AUTOMATIC TRANSFER SWITCH
CM	CEILING MOUNTED	COTR	CONTRACTING OFFICER/TECHICAL REPRESENTATIVE
EC	ELECTRICAL CONTRACTOR	EG	EQUIPMENT GROUND
EOL	END OF LINE	EW	ELECTRIC WATER COOLER
GC	GENERAL CONTRACTOR	GFCI	GROUND FAULT CIRCUIT INTERRUPTER
IG	ISOLATED GROUND	IRM	INFORMATION RESOURCES MANAGEMENT
MC	MECHANICAL CONTRACTOR	MCB	MAIN CIRCUIT BREAKER
MLO	MAIN LUGS ONLY	NEC	NATIONAL ELECTRICAL CODE
NF	NOT FUSED	SM	SURFACE MOUNTED
TC	TELECOMMUNICATIONS CONTRACTOR	TCC	TEMPERATURE CONTROLS CONTRACTOR
TV	TELEVISION	VSC	VARIABLE SPEED MOTOR CONTROLLER
WP	WEATHERPROOF ENCLOSURE - NEMA 4 TYPE		
X	EXISTING OUTLET, DEVICE, LIGHTING FIXTURE, CONDUIT, ETC. - TO REMAIN		
XB	INDICATES EXISTING OUTLET, LIGHTING FIXTURE, CONDUIT, ETC - TO BE REMOVED. PROVIDE BLANK COVER FOR OUTLET AND MAINTAIN CIRCUIT CONTINUITY.		
XL	NEW LOCATION OF EXISTING OUTLET, DEVICE, LIGHTING FIXTURE, ETC.		
XN	EXISTING OUTLET, DEVICE, LIGHTING FIXTURE, ETC. - TO BE REPLACED WITH NEW OF SPECIFIED TYPE		
XR	EXISTING OUTLET, DEVICE, LIGHTING FIXTURE, CONDUIT, ETC. - TO BE REMOVED COMPLETE- MAINTAIN CIRCUIT CONTINUITY TO ADJACENT OUTLETS, EXTEND CONDUIT AND WIRING AS REQUIRED.		
XRR	EXISTING OUTLET, DEVICE, LIGHTING FIXTURE, ETC. - TO BE REMOVED AND REINSTALLED AT NEW LOCATION - EXTEND CONDUIT AND WIRING AS REQUIRED		
VAMC	VETERANS AFFAIRS MEDICAL CENTER		

CONDUIT DIRECT BURIAL - SECTION A-A

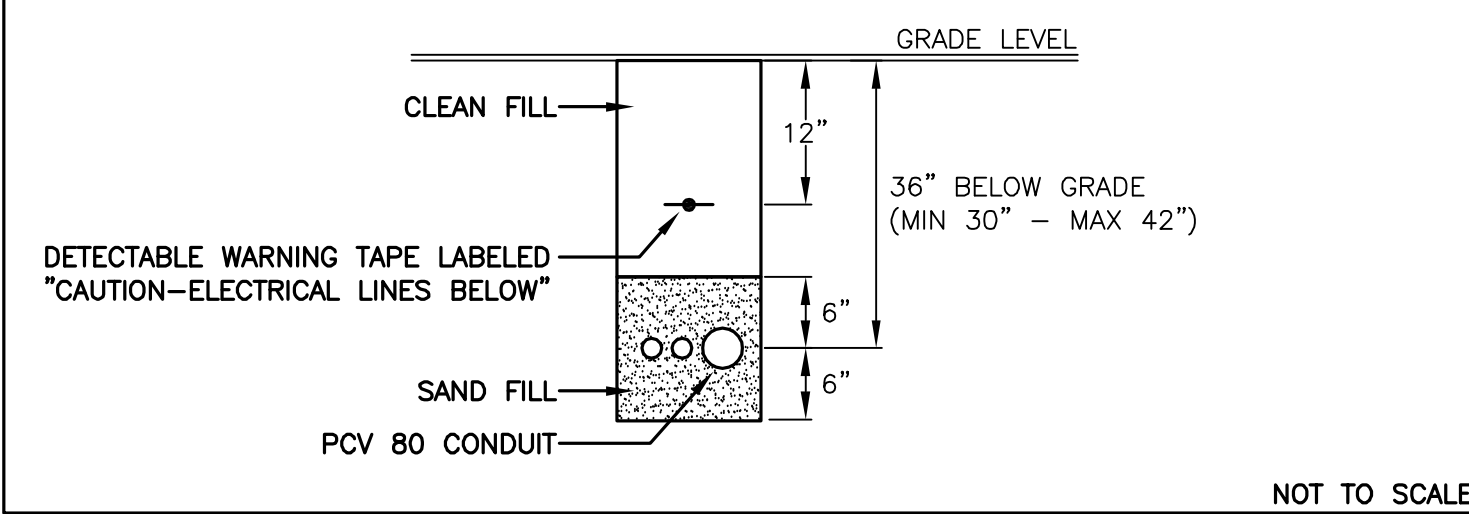

FOR CONSTRUCTION

CONSULTANTS:		ARCHITECT/ENGINEERS:		Drawing Title ELECTRICAL SITE PLAN AND LEGEND		Project Title VAMC WADE PARK CLEVELAND TR HOUSE IMPROVEMENTS		Project Number 541-12-125		Office of Construction and Facilities Management Department of Veterans Affairs	
				Approved: Project Director		Location 9401 LORAIN AVE, CLEVELAND, OHIO 44102		Building Number			
FINAL CD SUBMISSION Revisions:		M.P. LONG 58459 REGISTERED PROFESSIONAL ENGINEER FF&H #12062		MAKOVICH & PUSTI ARCHITECTS, INC. 111 FRONT STREET, NILES, OHIO 44017 (440) 991-8919		Date 01-14-13		Checked By MPL		Drawing Number 1-E1	