

Mod to Bid Alt #1 – Demolition

Scale: $\frac{1}{16}'' = 1'$

Demolition Notes:

1. Remove and dispose of existing exterior door, frame, and associated equipment and wiring.
2. Remove and dispose of existing door, frame, associated hardware, and wall.
3. Remove and dispose of existing chair rail, vinyl wall covering, and wainscott.

Electrical: Remove all electrical wiring, conduit, and devices for unused circuit to the branch junction box or breaker, as appropriate. Cap all openings.

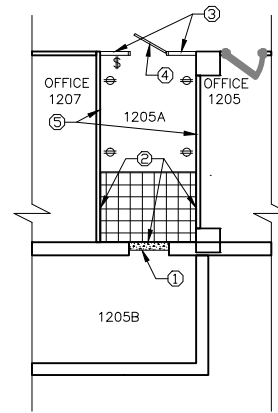

Mod to Bid Alt #1 – Construction

Scale: $\frac{1}{16}'' = 1'$

Construction Notes:

1. Infill opening with 8" insulated CMU block. Place moisture-impervious sheet barrier and 2" rigid foam on interior block face, so that the insulation is flush with the adjacent wall surface.
2. Install $\frac{1}{2}''$ Type X gypsum board, direct-adhered to existing wall surface. Chamfer bottom edge to accommodate existing terazzo cove base. Prep walls for paint finish.
3. Construct gypsum wall to deck ($\frac{3}{8}''$ galvanized steel studs and channels per specifications, $\frac{5}{8}''$ Type-X gypsum board both sides, finish joints and seal penetrations for 1-hour fire rating).
4. Install 36"x84"x2" solid core wood door, white birch veneer natural finish, with Storeroom latchset, per specifications, and commercial grade closer. Door shall be rated and labeled for 45-minute fire protection in accordance with NFPA requirements.
5. Skim and prep walls for paint finish.
6. Install Armstrong Excelon Washed Linen 51810 12"x12" VCT tile over existing terazzo flooring. Install Armstrong VCT5 $\frac{1}{8}''$ -to-Nothing VCT Edge strip, light gray.
7. Modify and repair existing ACT ceiling, tiles and grid, as necessary.

Electrical: Install wiring, galvanized conduit, and associated devices as necessary to install a 2'x2' recessed fluorescent light fixture, light switch, and four duplex 110V electrical outlets as shown.

Drawing Title Modification to Alternate #1 to Bid Item #3: See Drawing Sheets A1-1 and E1-2	Project Title Renovate Restrooms - Omaha		Project Number 636-13-125		Nebraska - Western Iowa Healthcare System Omaha VAMC
			Building Number Bldg 1		
Notes Replaces architectural and electrical instructions on Drawing Sheets A1-1 and E1-2	Location Omaha VAMC			Drawing Number Drawing Mod 1	
	Date June 13, 2013	Checked CMW	Drawn CMW	Dwg of	