

one and one half inches = one foot
one inch = one foot
three quarters inch = one foot
one half inch = one foot
one quarter inch = one foot
one eighth inch = one foot

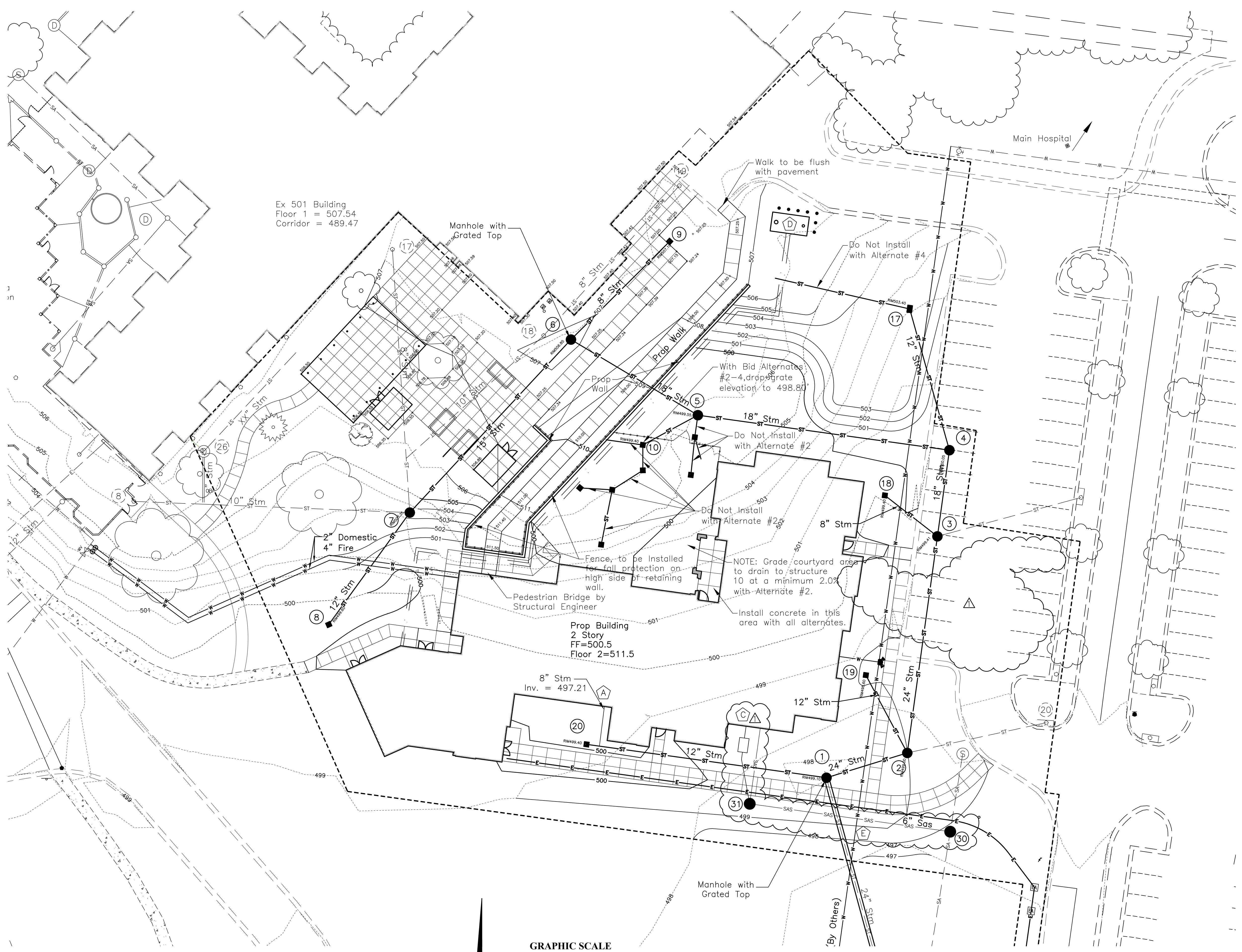

LEGEND

Existing

Sanitary Sewer

Storm Sewer

Water Main

Electric

Fire Hydrant

Water Valves

Electric Pull Box

Electric Outlet

Electric Pedestal Box

Wooden Light Pole

Metal Light Pole

Mailbox

Fence Post

Sign

Trees

Bushes

Contours

Structure Number

Proposed

Contours

Spot Elevation

Limits of Disturbance (1.91 Acres)

Storm Structure Number

Water Line

Water Valve

Fire Department Connection

Storm Line

Storm Manhole

Storm Catch Basin

Storm Yard Inlet

Sanitary Service

Sanitary Main (By Others)

Sanitary Manhole (By Others)

Electric Line

Electric Manhole

Gas Line

Key Notes

Roof Drain Connection Location (Sitework limits to 5' outside building)

Rainwater Collection System Roof Drainage Connection Location

Sanitary Sewer Connection Location (Sitework limits to 5' outside building)

Fuel Oil Tank

Contractor to Verify As-Built Water Elevations and ensure 24" clearance to sanitary lateral

Notes

Location of existing utilities indicated on these plans is approximate. Contractor shall verify location of all existing utilities prior to construction.

No blasting is allowed on-site.

See Detail C, CS104 for patching of existing pavement associated with proposed utility work.

See Specification 31 20 11 for backfill requirements with utility excavation.

Reference CS109 for grading in areas not impacted by deduct alternates.

SITE BID ALTERNATE LIST:

BID ALTERNATE #1:
ELIMINATE LOADING DOCK PAVING AND LOCATION OF THE REMOTE FUEL STORAGE TANK AND BOLLARDS AS SHOWN ON CS108. DUE TO REMOVAL OF LOADING DOCK PAVING THE LIMITS OF DEMOTION (CS105) AND PAVEMENT REPLACEMENT (CS108) ARE MODIFIED. SEE LP106 FOR MODIFIED LANDSCAPE PLANTINGS.

BID ALTERNATE #2:
ELIMINATE TEMPORARY CONSTRUCTION ACCESS AND CONCRETE WALKS, STEPS, RAMPS, PLANTER WALLS, UNDERDRAINS, RAINWATER HARVESTING SYSTEM AND IRRIGATION IN COURTYARD AREA AS SHOWN ON SHEET LP105. SIDEWALK TO REMAIN INCLUDES WALK ON SOUTH AND EAST SIDES OF BUILDING AND PORTIONS EXITING THE NORTH SIDE OF THE ELEVATOR LOBBY AREA. SEE CS109A FOR CLARIFICATION ON ANY SIDEWALKS TO REMAIN IN CONTRACT.

BID ALTERNATE #3:
EXTEND LIMITS OF GRADING TO SINGLE WIDE CORRIDOR (SEE ARCHITECTURAL DRAWINGS FOR LIMITS OF SINGLE WIDE CORRIDOR).

BID ALTERNATE #4:
DELETE CONNECTING CORRIDOR, ADD RETAINING WALL AND PEDESTRIAN WALK BRIDE (SEE STRUCTURAL PLANS FOR DETAILS). ADD 6' WIDE WALK CONNECTION FROM 501 BUILDING TO PROPOSED BUILDING, REDUCE LIMITS OF UPPER COURTYARD CONCRETE INSTALLATION. FOR GRADING MODIFICATIONS AND CLARIFICATION OF SCOPE, SEE CS109A. INSTALL LOW VOLTAGE DUCT BANK PER MECHANICAL PLANS.

SEWER PROJECT COORDINATION		2013.06.10		CONSULTANTS:		ARCHITECT/ENGINEERS:		Drawing Title		Project Title		Project Number		Office of Construction and Facilities Management	
								ALTERNATE GRADING AND UTILITY PLAN		RELOCATE DEMENTIA UNIT		VA PN 613-207			
												Building Number			
Revisions:		Date						Approved: Project Director		Location		Drawing Number		CS109A	
										VAMC MARTINSBURG					
										Date		Checked		Dwg. 9 of 17	
										8/6/2012		JAM		SBO	

VA FORM 08-6231

1

2

3

4

5

6

7

8