

OPENING IN FLOOR SLAB  
FOR DENTAL UNIT  
SCALE: 1/2" IN.=1 FT.

DETAIL OF LINTELS L6 & L7  
NOTE: SCALE: 3/8"=1'-0"

LINTEL SCHEDULE			
MARK	LINTEL	LENGTH	REMARKS
L1	1 1/2" x 3/4" x 3" x 1/4"	4'-4"	FOR ALL A1 & A2 WINDOWS WHERE SPANDREL COMES DOWN.
L2	3 1/2" x 3/4" x 3" x 1/4"	4'-4"	FOR A1 & A2 WINDOWS WHERE BEAM DOES NOT COME DOWN.
L3	3 1/2" x 3/4" x 3" x 1/4"	4'-0"	FOR 3'-0" OPENINGS
L4	1 1/2" x 5" x 5" x 1/4"	23'-4"	CONTINUOUS SEE DETAIL SH. #156
L5	1 1/2" x 7" x 5" x 1/4"	23'-4"	CONTINUOUS SEE DETAIL SH. #156
L6	1 1/2" x 5" x 3/4" x 1/4"	15'-5"	1/2" BOLTS-3'-0" O.C. TO SPAN. BEAM-SEE DET.
L7	1 1/2" x 5" x 3/4" x 1/4"	8'-5"	DO.
L8	3 1/2" x 4" x 3/4" x 1/4"	6'-0"	FOR 5'-0" OPENINGS
L9	2 1/2" x 4" x 3/4" x 1/4"	4'-6"	STAIRS
L10	2 1/2" x 4" x 3/4" x 1/4"	13'-6"	ELEVATORS
L11	2 1/2" x 4" x 3/4" x 1/4"	5'-6"	ELEVATORS
L12	3 1/2" x 5" x 3/4" x 1/4"	4'-8"	FOR 3'-8" OPENINGS
L13	1 1/2" x 3/4" x 3" x 1/4"	3'-0"	FOR ACCESS DOORS

LEFT & CENTER WING FIRST FLOOR FRAMING PLAN  
SHOWING LINTELS OVER OPENINGS IN FLOOR BELOW.

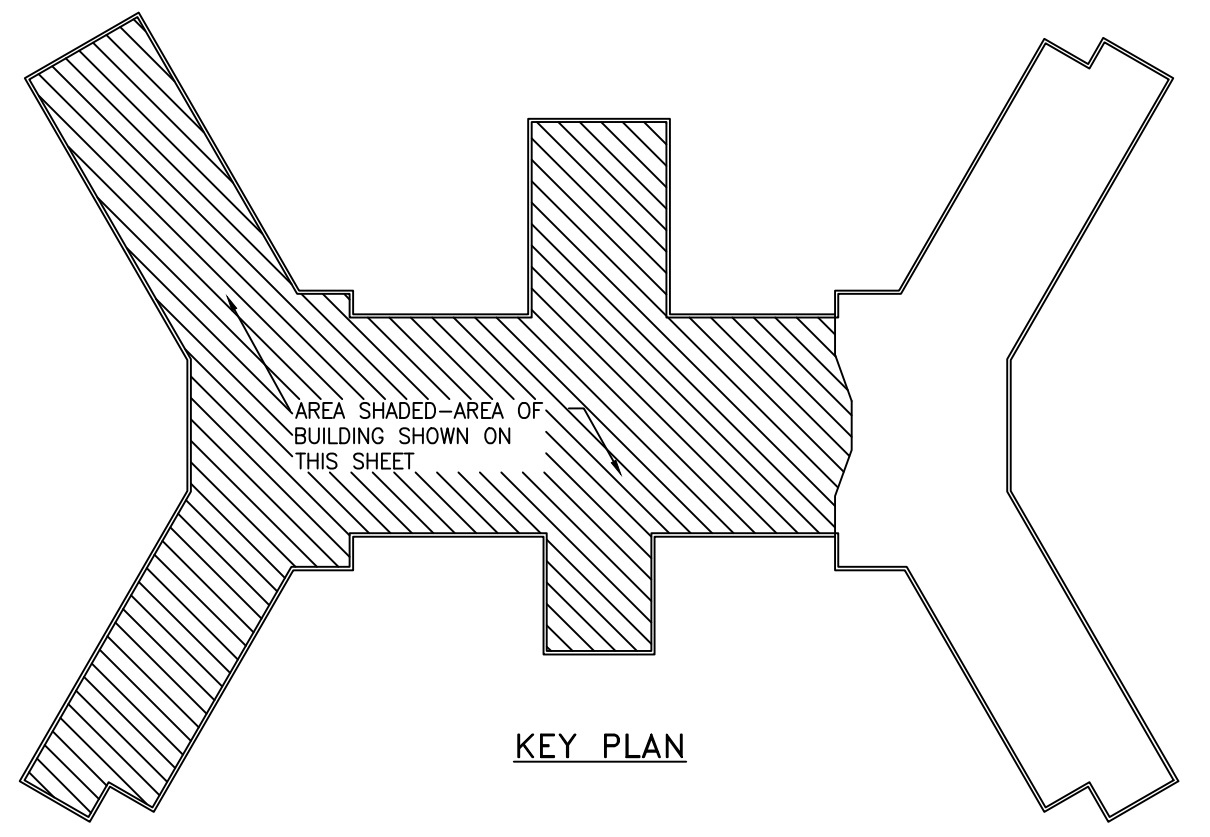

BLDG #2

REVISION	DATE	DESCRIPTION	BY
WALTER HOOK & ASSOCIATES, INC. CHARLOTTE, NORTH CAROLINA WM. HENLEY DETTRICK, INC. RALEIGH, NORTH CAROLINA WM. C. OLSEN ARCHITECTS, ENGINEERS IN ASSOCIATION WITH NEEROAARD, CRAIG & McCAGG HOSPITAL CONSULTANTS-NEW YORK, N.Y.			
CORPS OF ENGINEERS U.S. ARMY CHARLESTON DISTRICT CHARLESTON, S.C.		VETERANS ADMINISTRATION HOSPITAL SALISBURY, NORTH CAROLINA 960 BED NP HOSPITAL WING FIRST FLOOR FRAMING PLAN	
DRAWN BY: K.Q.		SCALE: AS NOTED	
CHECKED BY: K.Q.		DATE: DEC. 9, 1949	
SUBMITTED BY: PEL		DRAWING NUMBER	
APPROVED: _____		SPEC. NO.	
CHIEF ENGINEER LT. COL. C. E. DISTRICT ENGINEER		V.A. PROJECT NO.2448	

NO. OF SHEETS	172
IN SET	471