

three inches = one foot  
one and one half inches = one foot  
one inch = one foot  
three quarters inch = one foot  
one half inch = one foot  
three eighths inch = one foot  
one quarter inch = one foot  
one eighth inch = one foot

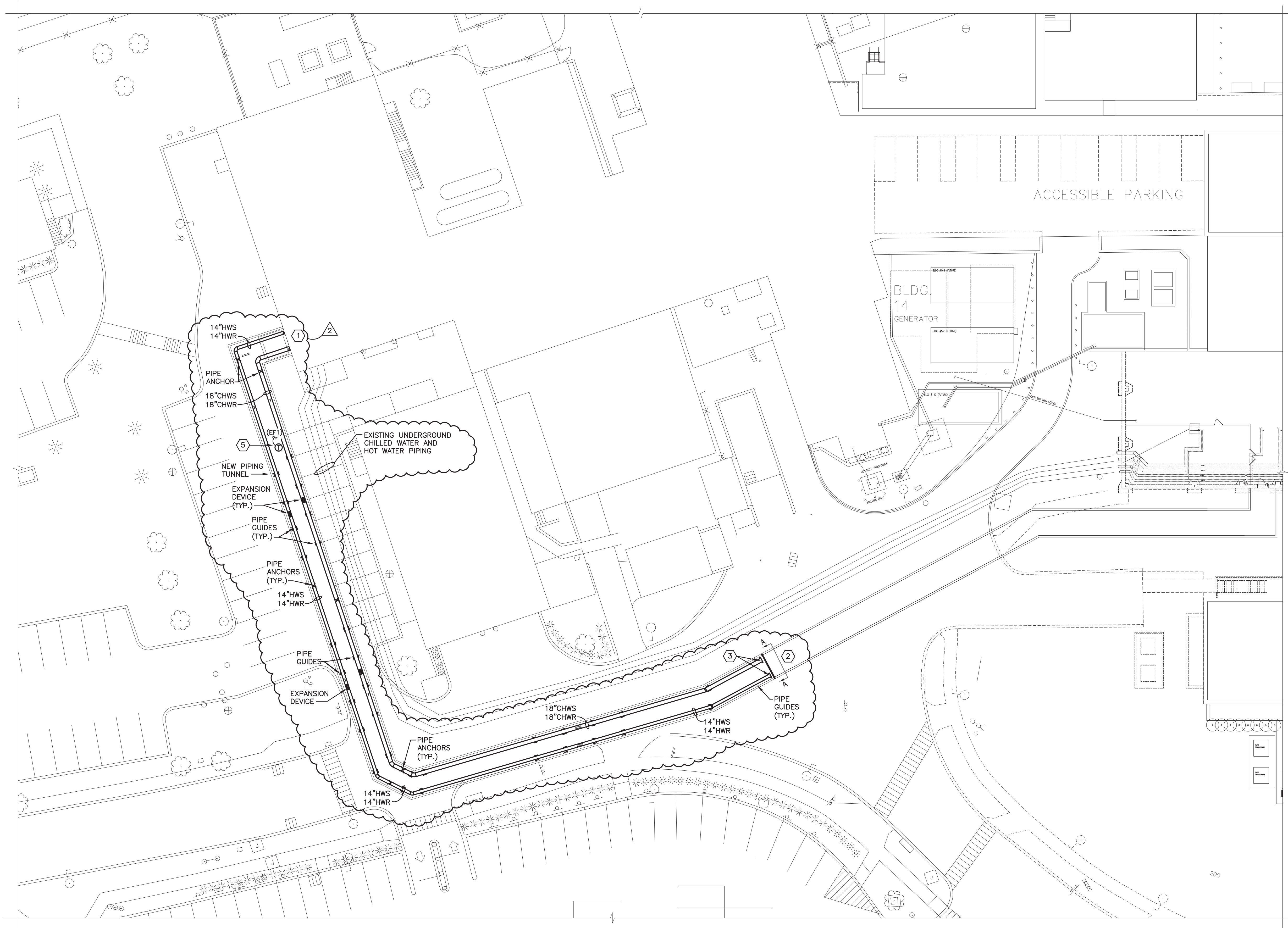

MECHANICAL SITE PLAN

SCALE: 1" = 20'-0"



GENERAL NOTES:

1. INSTALL ALL EXPANSION JOINT EQUIPMENT INCLUDING EXPANSION DEVICE, PIPE GUIDES, PIPE ANCHORS, AND SPACING REQUIREMENTS, PER MANUFACTURER'S RECOMMENDATIONS. EXPANSION JOINTS TO BE METRAFLEX INC. MODEL "METRAGATOR"; OR EQUAL. SEE SPECIFICATIONS. COORDINATE WITH STRUCTURAL DRAWINGS.

KEYED NOTES:

- 1 SEE PARTIAL CHILLED WATER AND HOT WATER PIPING PLANS FOR CONTINUATION.
- 2 SEE SECTION A-A FOR PIPING ARRANGEMENT AND RACKING DETAILS.
- 3 PROVIDE PIPE CAPS FOR BOTH CHILLED WATER AND HOT WATER PIPING AT THIS LOCATION. PIPE TUNNEL AND PIPING CONTINUATION ARE PART OF ANOTHER PROJECT.
- 4 SEE STRUCTURAL DRAWINGS FOR ACTUAL PIPING SUPPORT SYSTEM IN TUNNEL.
- 5 PROVIDE NEW THERMOSTAT TO CONTROL NEW EXHAUST FAN, SEE UPPER TUNNEL ENTRY PLAN AND SCHEDULES FOR CONTINUATION.

MECHANICAL SYMBOL LIST

GENERAL		MECHANICAL ABBREVIATIONS	
Connect new work to existing		Access Door	AD
Demolition of work		Capacity	CAP
PIPING		Cubic Feet Per Minute	CFM
Existing Chilled Water Return		Direct Digital Control	DDC
Existing Chilled Water Supply		Gallon	GAL
Existing Hot Water Return		Gallons Per Minute	GPM
Existing Hot Water Supply		Head	HD
Chilled Water Return		Linear Feet or Foot	LF
Chilled Water Supply		Pressure Drop	PD
Hot Water Return		GENERAL ABBREVIATIONS	
Hot Water Supply		Above Finished Floor	AFF
VALVES AND PIPING ACCESSORIES		Ceiling	CLG
Direction of fluid flow		Diameter	DIA
Drain Valve		Down	DN
Pipe down		Drawing	DWG
Pipe up		Elevation	ELEV
Pipe takeoff from bottom		Existing	EXIST
Ball Valve		Feet	FT
Butterfly Valve		Floor	FL
Gate Valve		Manufacturer	MFR
Pipe Anchor Point		Maximum	MAX
Pipe Guide		Minimum	MIN
Union		Mounted	MTD
		Not Applicable	N/A
		Number	#
		On Center	OC
		Typical	TYP

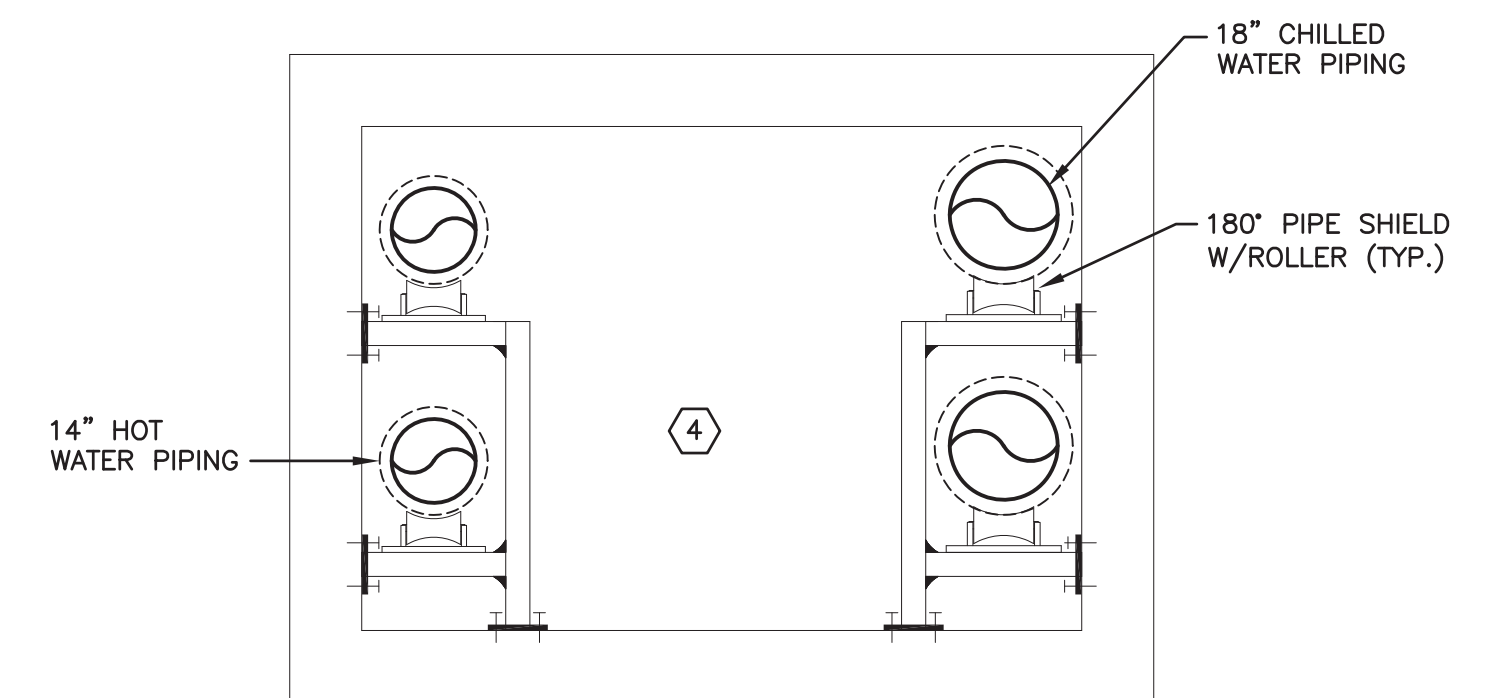

SECTION A-A

SCALE: 3/8" = 1'-0"

FINAL DESIGN (100%)

FFA #7482

<b>CONSULTANTS:</b>		<b>ARCHITECT/ENGINEERS:</b>		<b>Drawing Title</b> MECHANICAL: SITE PLAN, SYMBOL LIST AND SECTION		<b>Project Title</b> REPAIR HOT WATER LINES PHASE II Stratton VA Medical Center		<b>Project Number</b> VA 528A8-10-814		<b>Office of Construction and Facilities Management</b> 	
 FRIEDMAN FISHER ASSOCIATES, P.C. Quality Service Since 1944 CONSULTING ENGINEERS 22 Aviation Road, Albany, New York 12206 TEL (518) 458-7040 FAX (518) 458-7043 mail@friedmanfisher.com		 RYAN-BIGGS ASSOCIATES, P.C. 291 River Street Troy, NY 12180 p 518 272.6266 f 518 272.4467 www.ryanbiggs.com				<b>Location</b> Albany, New York		<b>Building Number</b> -			
 EBERLIN AND EBERLIN, P.C. 347 ROUTE 100 SUITE 300 SHERBORN NEW YORK 10959 CONSULTING ENGINEERS, PLANNERS, LANDSCAPE ARCHITECTS WATERLOO PHONE WATERLOO FAX				<b>Approved Project Director</b>		<b>Date</b> JULY 24, 2012		<b>Checked</b> BJF	<b>Drawn</b> PBL	<b>Drawing Number</b> M1.1 Dwg. 19 of 23	
<b>Revisions</b>		<b>Date</b>									
ASI #1		12-21-12									
ADDENDUM #2		7/24/12									