

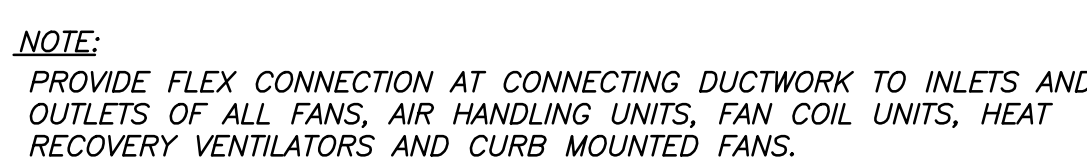

SCALE: NONE



FAN FLEX CONNECTION



ALL DUCT FABRICATION SHALL BE ACCORDING TO SMACNA EXCEPT WHERE MORE STRINGENT REQUIREMENTS ARE INDICATED. ALL JOINTS SHALL BE SEALED TO SMACNA SEAL CLASS A.



RECTANGULAR BRANCH DUCT DETAIL

- 1 1/4" COPPER TUBING
- 2 1/2" SHUT-OFF VALVE
- 3 1/2" x 4" NIPPLE
- 4 HYDRONIC PIPING HIGH POINT
- 5 REDUCER (TYPICAL)



SCALE: NONE

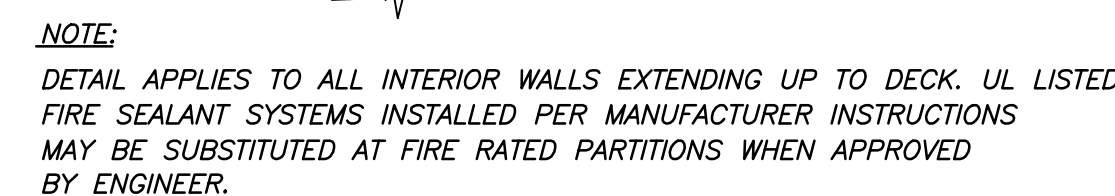

PIPE OR
SCALE: NONE

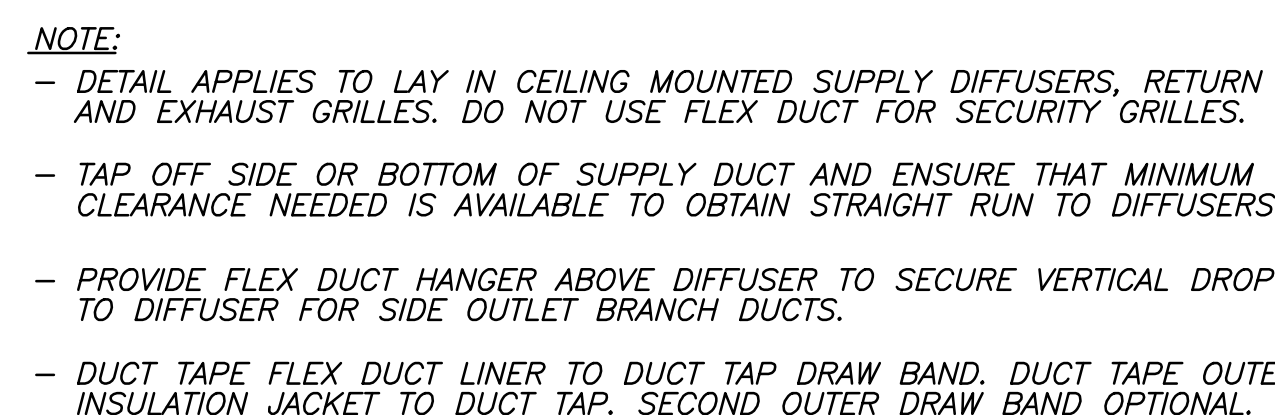

SCALE: NONE

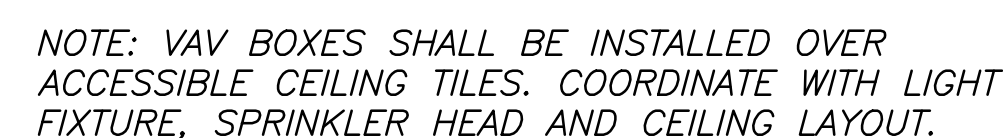

SCALE: NONE

SUB-CONSULTANTS:



PREPARED BY:

ΣΨ Sigma Psi Consulting
Mechanical, Electrical, Plumbing Engineers, PLLC

4 Collamer Road, Malta, NY 12020 PH (518) 581-9428 FX (518) 580-9325

Drawing Title	MECHANICAL DETAILS
---------------	--------------------

Approved: Project Director

Project Title	SYRACUSE VAMC RENOVATE POLICE STATION
---------------	--

Project Number
700-17-12-700

Building Number	1
-----------------	---

Location	SYRACUSE VA MEDICAL CENTER
----------	----------------------------

NY

Checked
- PJ

Drawn

Dwg. 16 of

Dwg 16 of 2

Office of
Construction
and Facilities
Management

