

three eighths inch = one foot
 one eighth inch = one foot
 one quarter inch = one foot
 one half inch = one foot
 three quarters inch = one foot
 one inch = one foot
 one and one half inches = one foot
 two inches = one foot
 three inches = one foot

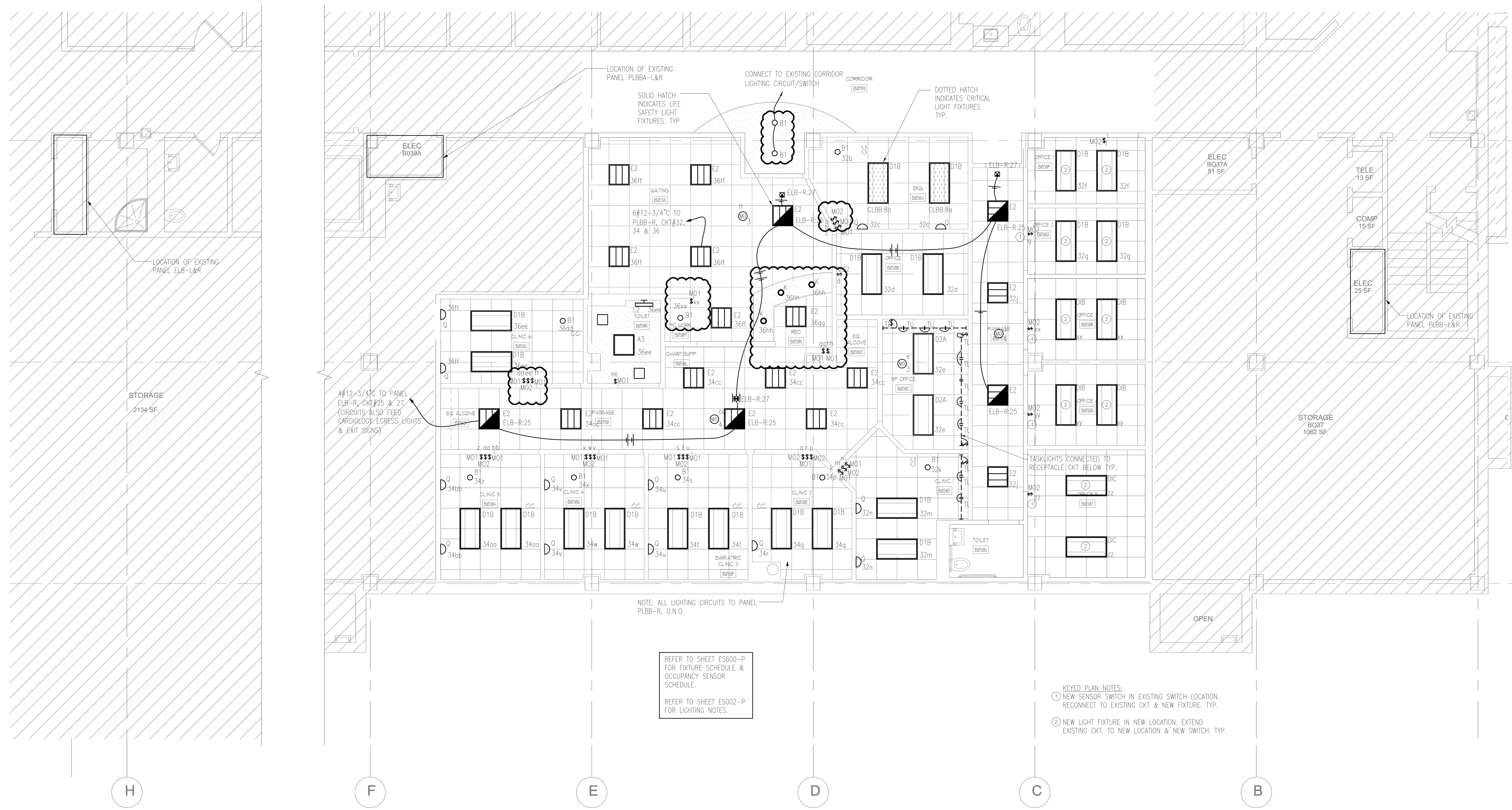

BASEMENT FLOOR LIGHTING PLAN
 SCALE: 1/4" = 1'-0"

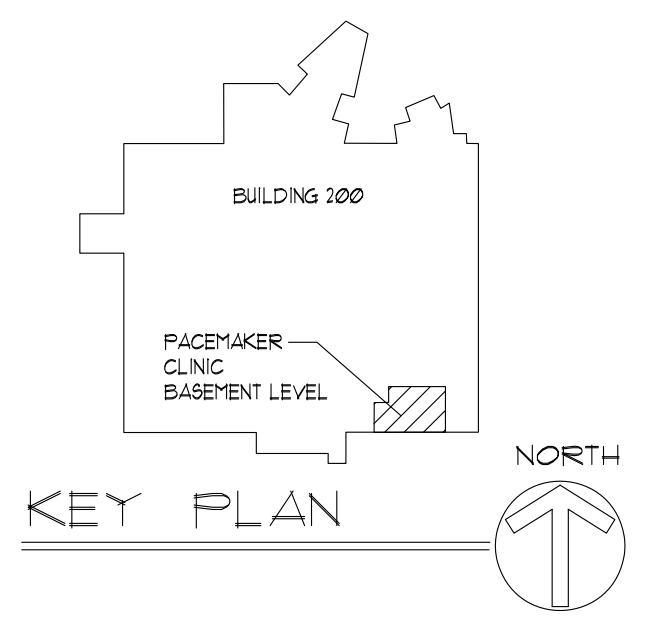

CONSULTANTS: KLAUCENS & ASSOCIATES, INC. MEP FP CONSULTANTS 3239 Arnold Lane Northbrook, IL 60062 Tel. 847-498-5950 Fax 847-498-6880		CARNDW, COMBEAR & ASSOCIATES, LTD. CERTIFIED INDUSTRIAL HYGIENISTS 300 W. Adams Street Suite 1200 Chicago, IL 60606 Tel. 312-782-4486 Fax 312-782-5145		ARCHITECT: Anderson Mikos Architects Ltd. <i>"Architecture through Listening"</i> One Parkview Plaza 17W110 22nd Street, Suite 200 Oakbrook Terrace, Illinois 60181 Tel. 630-573-5149 Fax 630-573-5176		Drawing Title BASEMENT FLOOR LIGHTING PLAN Approved Project Director		Project Title RENOVATE PACEMAKER CLINIC, BLDG 200		Project Number 578-13-002 Building Number BLDG 200, SEC-C BASEMENT FLOOR Drawing Number EL100-P Dwg of		Office of Construction and Facilities Management Department of Veterans Affairs	
AMENDMENT #2 ISSUED FOR BID Revisions:		07.09.2013 05.20.2013 Date		AMA PROJ. # 11175.00		Date Checked Drawn		Date Checked Drawn		Date Checked Drawn			