

Note: Exterior Signs Extrusions
to Contain Minimum 75%
Recycled Aluminum Content.

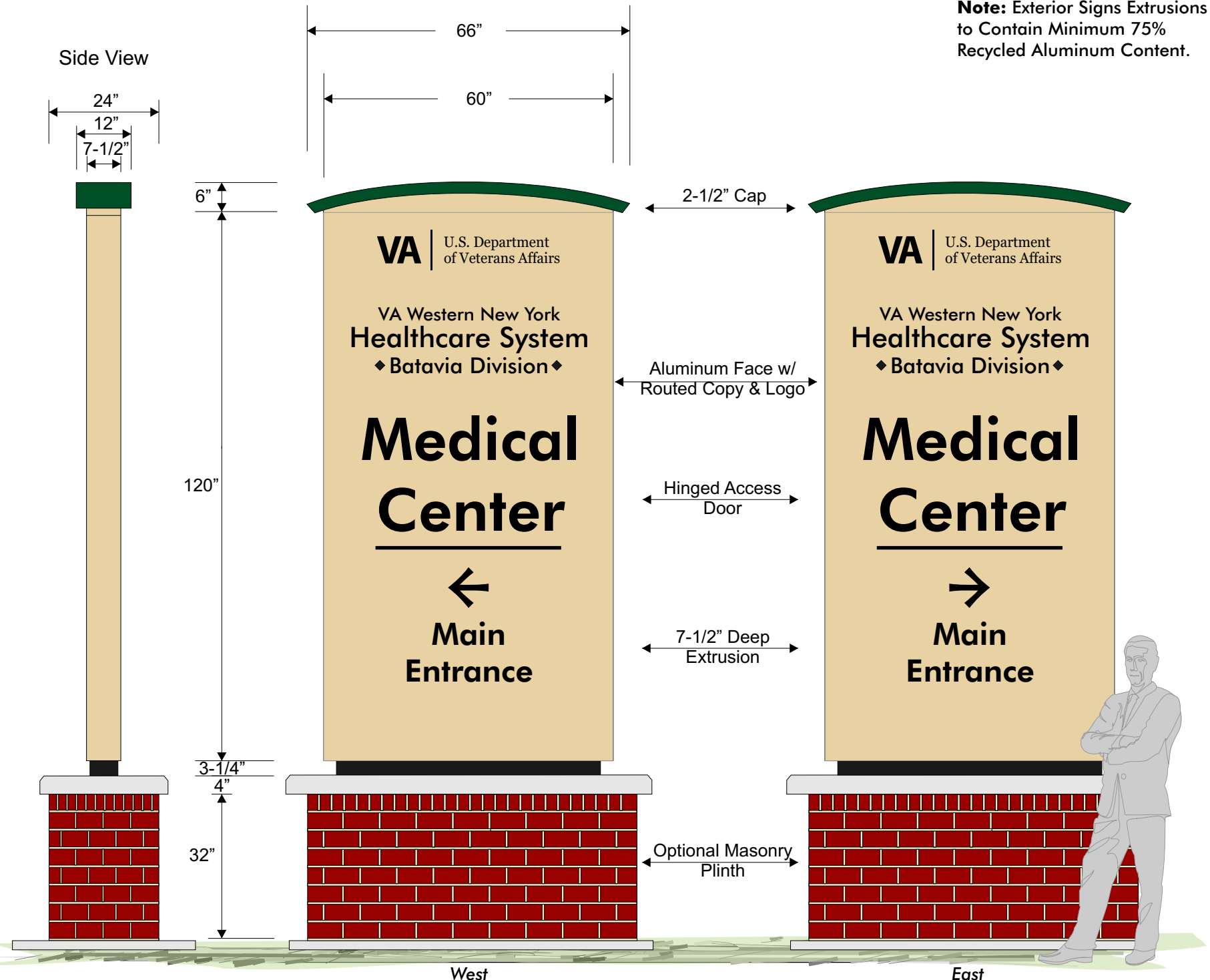

Illuminated Main Site ID Pylon

Type: 7/750 Illuminated Main Site DF

Note: Exterior Signs Extrusions to Contain Minimum 75% Recycled Aluminum Content.

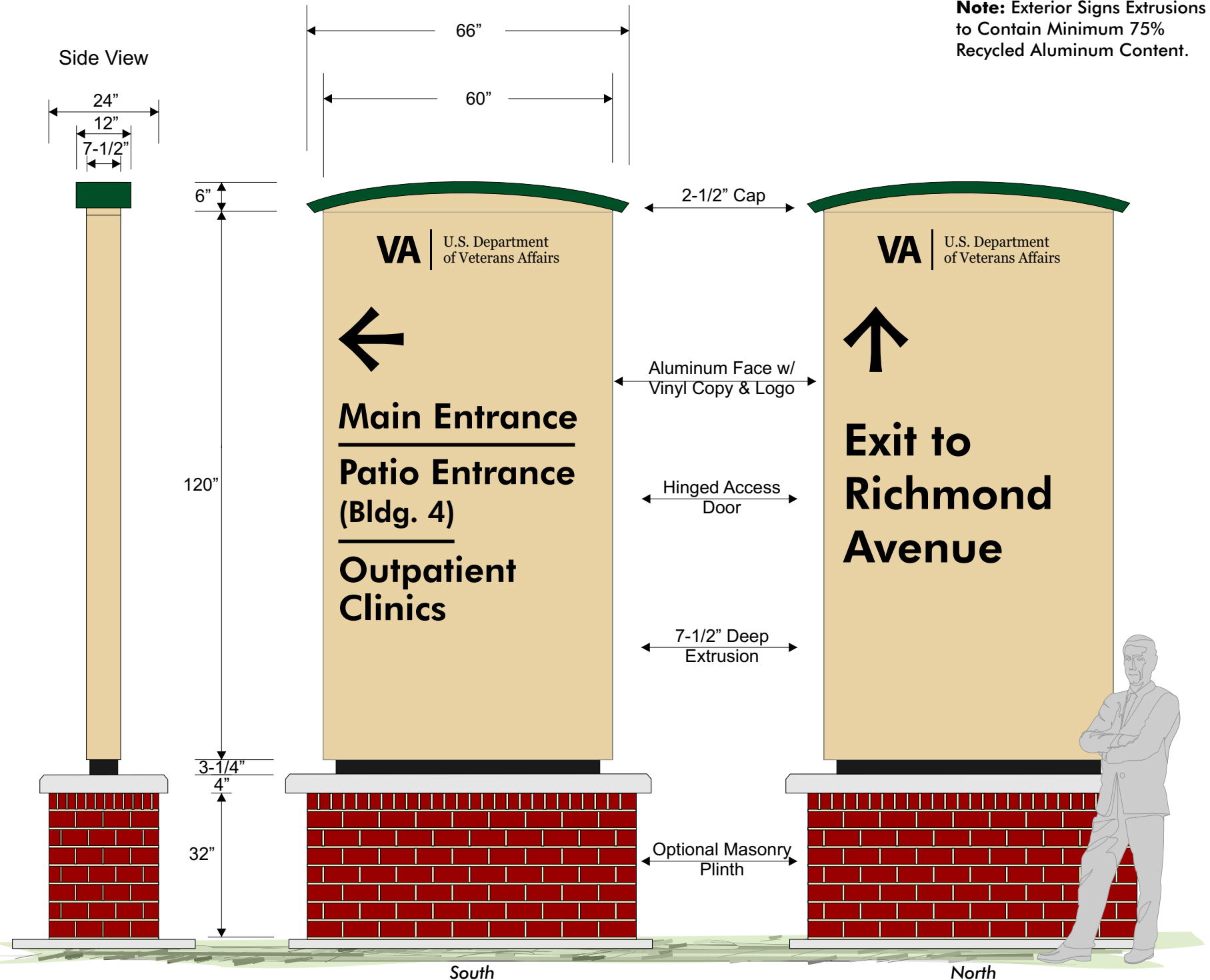

Non-Illuminated Main Site ID Pylon

VA Batavia, NY - A.3		
Scale: 1/28	Designer:	Drawn By: XHZ
Date: 5.13.13	Revised:	
Type: 5/750 Non-Illuminated Main Site DF		

Note: Exterior Signs Extrusions to Contain Minimum 75% Recycled Aluminum Content.

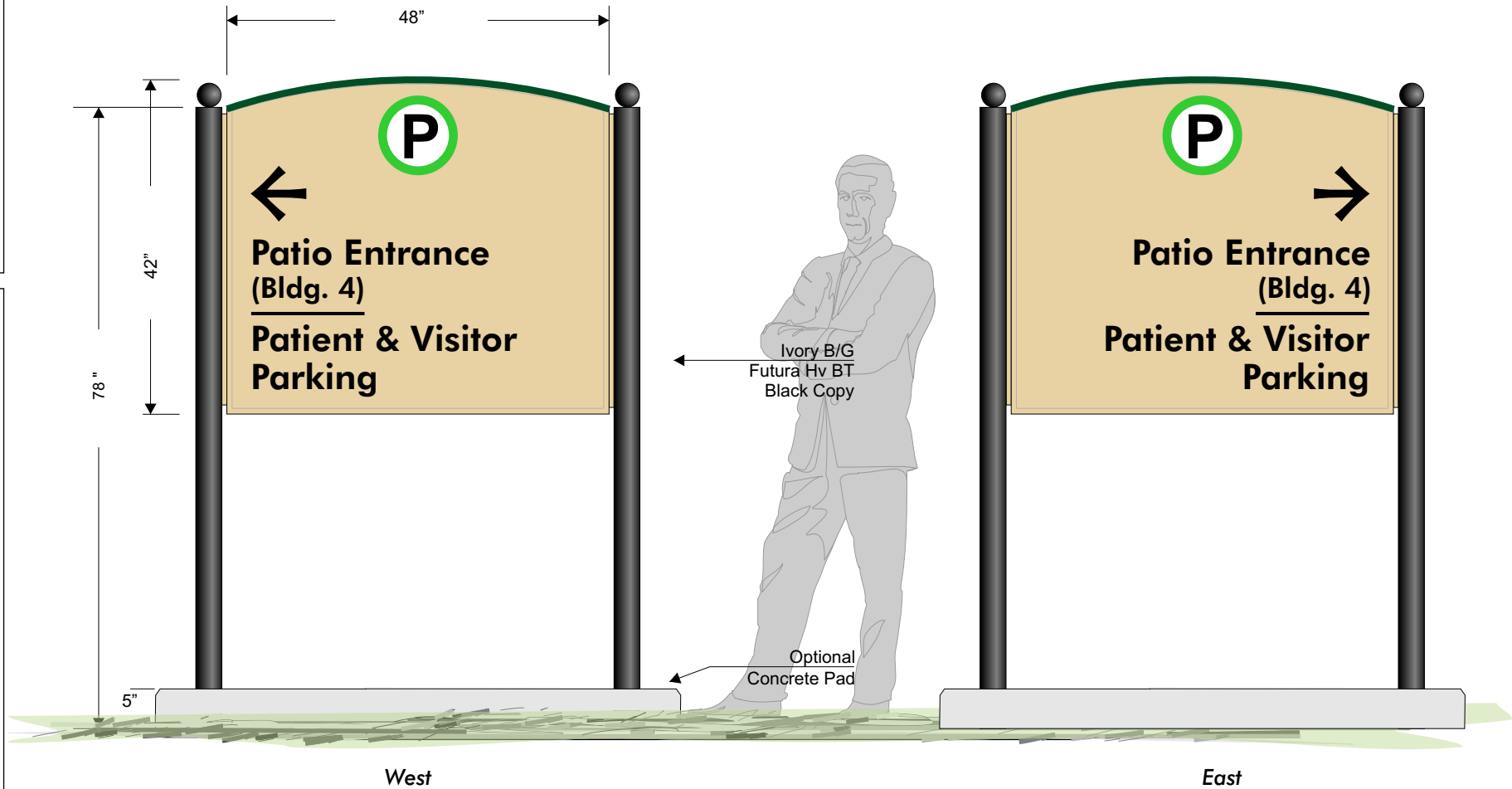
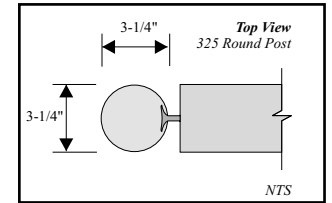

Double Post & Panel Directional

VA Batavia, NY - A.3			
Scale: 1:20	Designer:	Drawn By: XHZ	
Date: 5.13.13	Revised:		
Type 6/325 - Post & Panel DF			

Note: Exterior Signs Extrusions
to Contain Minimum 75%
Recycled Aluminum Content.

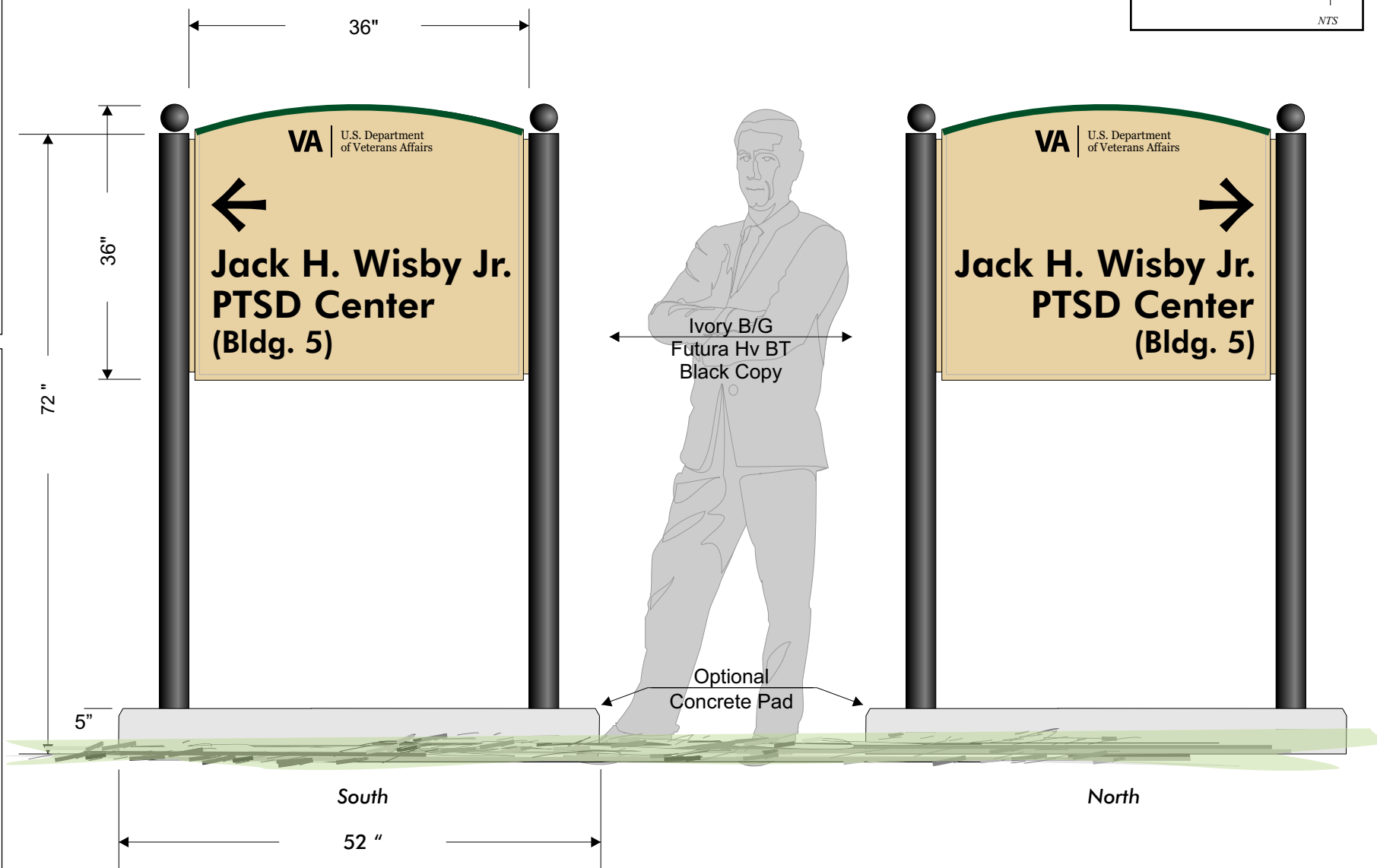
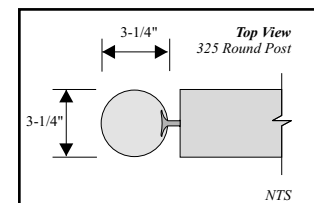

VA Batavia, NY - A.3			
Scale: 1:16	Designer:	Drawn By: XHZ	
Date: 5.13.13	Revised:		
Type 6/325 - Post & Panel DF			

Double Post & Panel Directional

Note: Exterior Signs Extrusions to Contain Minimum 75% Recycled Aluminum Content.

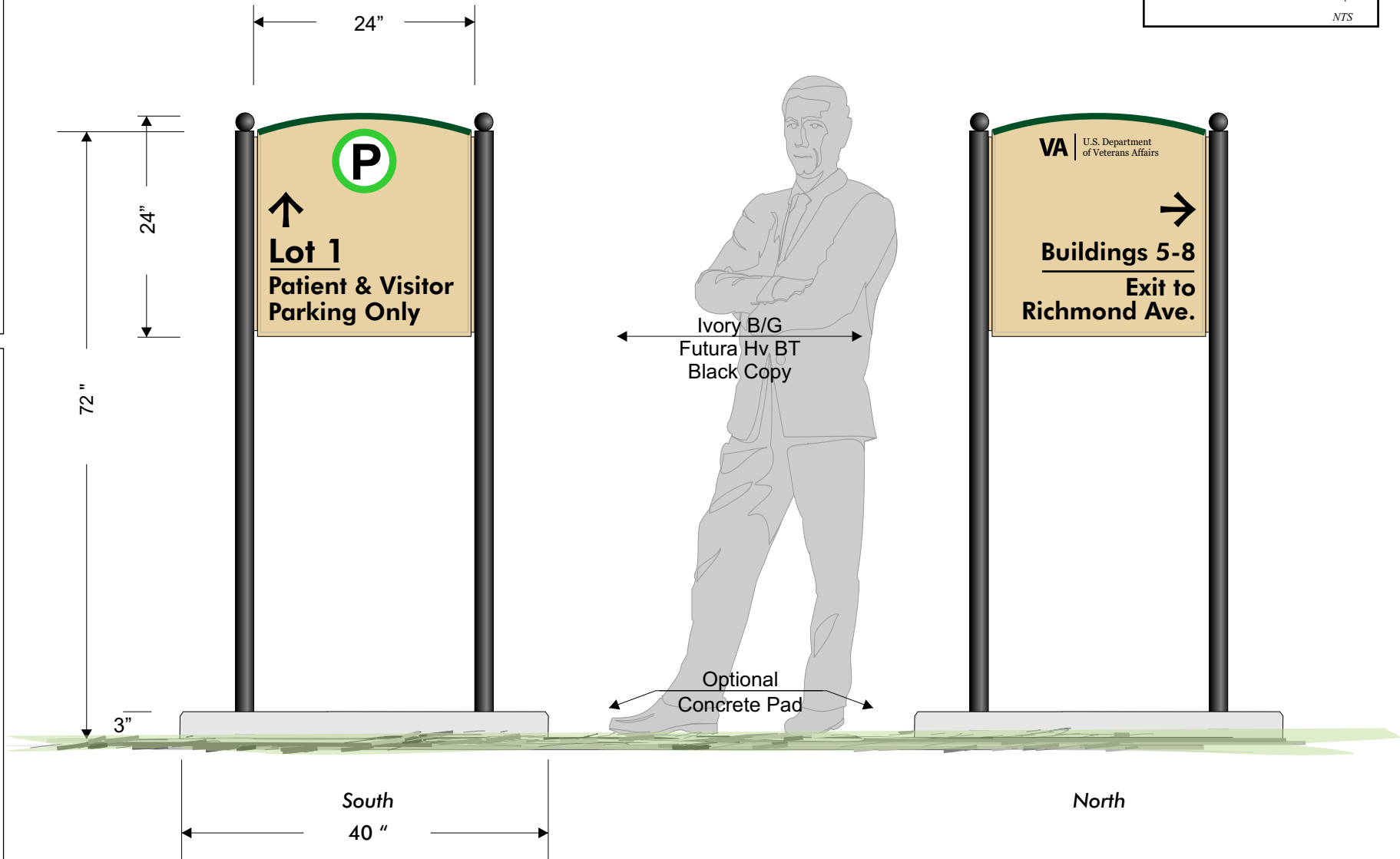
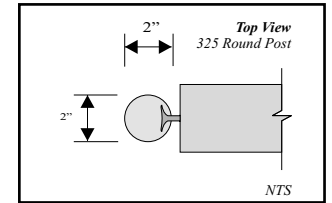

Double Post & Panel Building/Lot ID

VA Batavia, NY - A.3		
Scale: 1:16	Designer:	Drawn By: XHZ
Date: 5.13.13	Revised:	
Type 6/325 - Post & Panel DF		

Note: Exterior Signs Extrusions to Contain Minimum 75% Recycled Aluminum Content.

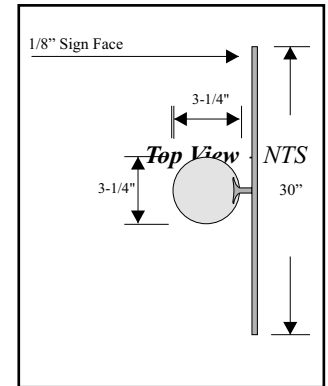

VA Batavia, NY - A.3			
Scale: 1:30	Designer:	Drawn By: XHZ	
Date: 5.13.13	Revised:		
Type: 5/218 SF			

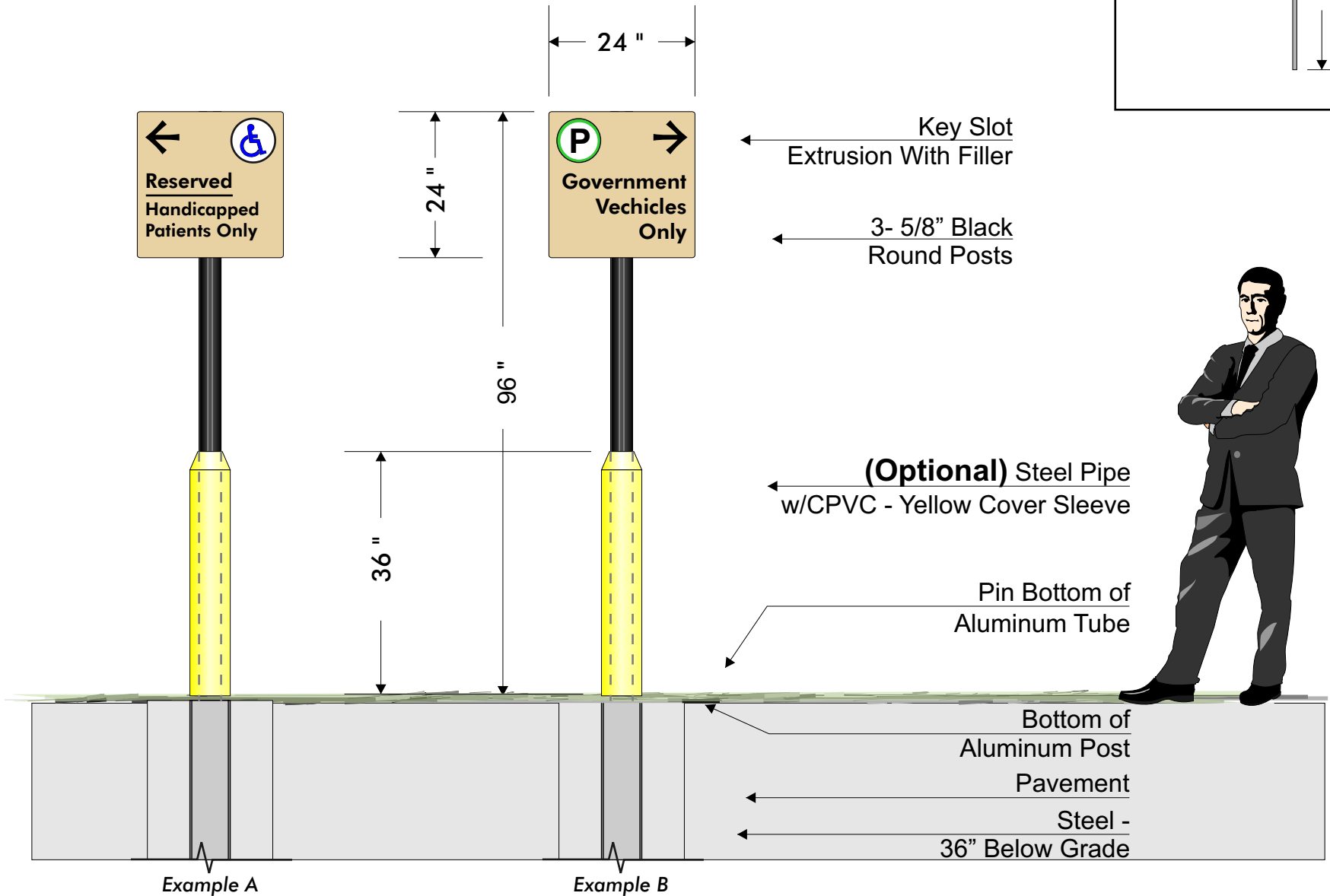

Single Post Panel Parking - Directional

Note: Exterior Signs Extrusions
to Contain Minimum 75%
Recycled Aluminum Content.



Futura Hv
Vinyl Copy & Logo

2" Deep

Wall-Mounted Building ID

VA Batavia, NY - A.3

Scale: 1:6

Designer:

Drawn By: XHZ

Date: 5.13.13

Revised:

Type 8/225 Wall-Mounted

VA Batavia, NY - A.3			
Scale: 1:24	Designer:	Drawn By: XHZ	
Date: 5.13.13	Revised:		

Type Footing Detail 7/1500 Illuminated

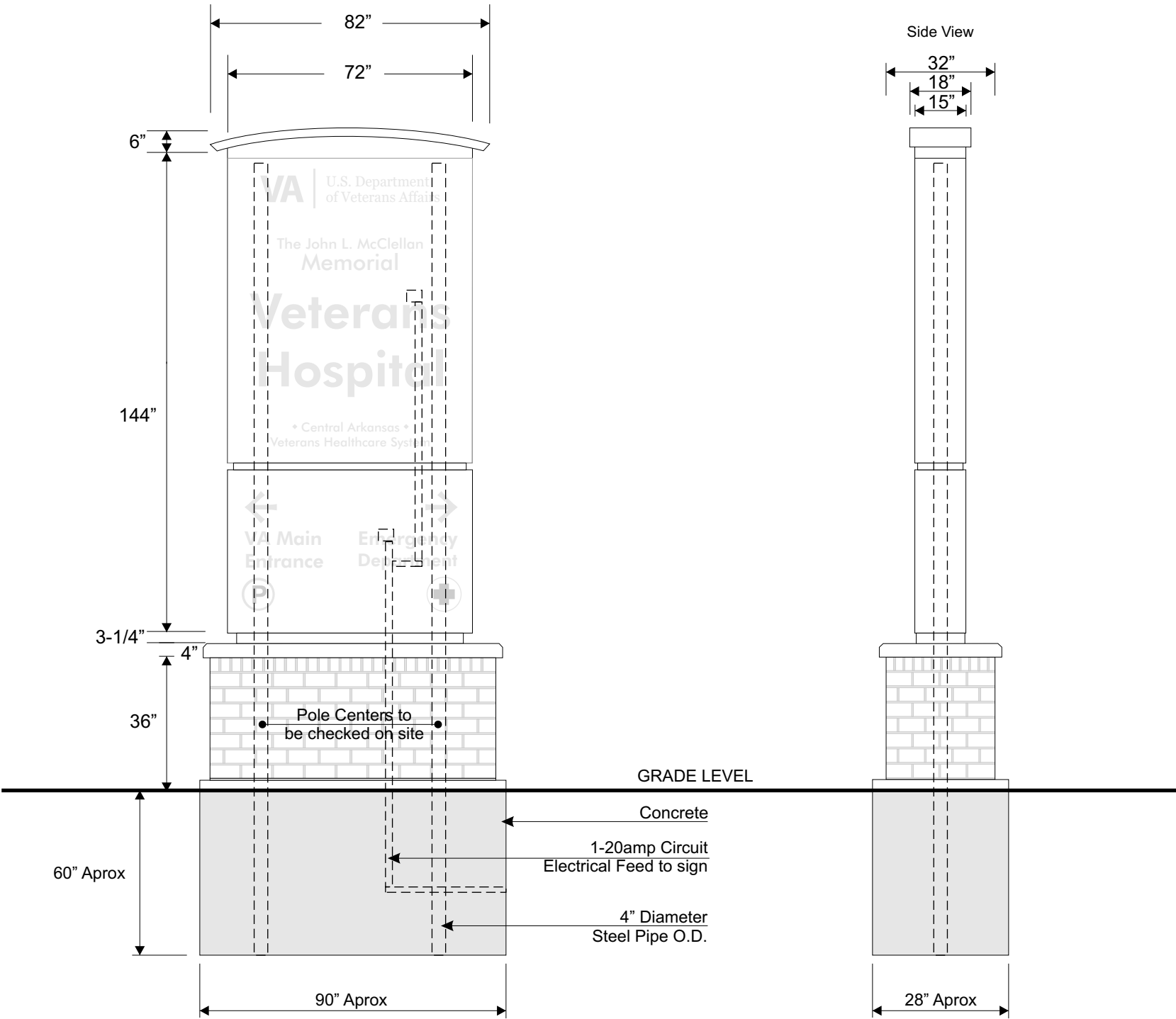

VA Batavia, NY - A.3			
Scale: 1:30	Designer:	Drawn By: XHZ	
Date: 5.13.13	Revised:		
Type: 5/218 DF			

