

**DOCUMENT 00 91 01**

**AMENDMENT NUMBER ONE**

AMENDMENT DATE: July 11, 2013

PROJECT: Correct Cited Safety, Security and Facility Condition Assessments for Bldg 3

BBSAE PROJECT NUMBER: 07062.04

VA Project No. 636A6-13-809

BID DATE: July 26, 2013

---

The information contained in this Amendment modifies, supplements or replaces information contained in the Bidding Documents dated January 31, 2013 and is hereby made a part of the Contract Documents.

Acknowledge receipt of this Amendment in the space provide on the Form of Bid.

Amendment consists of 5 pages (plus 4 pages of attachments).

---

**AMENDMENT INDEX**

APPLICABLE TO THE PROJECT MANUAL: Items #3 through Item #9 inclusive.

APPLICABLE TO THE DRAWINGS: Items #10 through Item #24 inclusive.

ATTACHMENTS: See the end of the Amendment for a list of attachments.

---

**GENERAL INFORMATION & CLARIFICATIONS**

ITEM #1 "After-hours" work is defined as work to be performed outside of the standard Medical Center working hours as indicated per Section 01 00 11; 1.2; A; 2. Exact work times are to be coordinated with the VA COR on a case-by-case basis. All after-hours work involving occupied space or the public way shall be clean and ready for Medical Center business use by 6:00 AM, Monday – Friday.

ITEM #2 Revise the following room numbers at all applicable locations throughout the contract documents:

A. **REVISE** room number Stair No.1 - 2910 to Stair No.1 - 2912.

1. **REVISE** door number to 2912.

B. **REVISE** room number Stair No.2 - 2950 to Stair No.2 - 2948.

1. **REVISE** door number 2948.

**APPLICABLE TO THE PROJECT MANUAL**

ITEM #3 SECTION 01 00 00 – GENERAL REQUIREMENTS

A. Article 1.13, Paragraph B: **ADD** new subparagraph 1 to read as follows:

1. ***The Owner shall have the right to inspect the Contactor's As-Built set of documents at any time throughout the duration of the construction Project.***

- ITEM #4      SECTION 01 00 11 – MEDICAL CENTER REQUIREMENTS
- A.      Article 1.2, Paragraph M, Subparagraph 3: **ADD** sub-subparagraph a. to read as follows:
- a.      ***During normal business hours, the maximum sustained noise level permitted shall not exceed 75 dB, as measured at all project boundaries. Construction noise generating sound levels up to 85 dB shall be allowed on an intermittent basis, not to exceed 5 minutes per hour. Construction noise generating sound levels over 85 dB are not permitted during normal business hours.***
- ITEM #5      SECTION 09 51 00 – ACOUSTICAL CEILINGS
- A.      Article 3.2: **ADD** new Paragraph B and subparagraphs as follows:
- B. Layout**
1. ***To the greatest extent possible, layout grid approximately centered on each space or room such that the partial tiles on each side of a space are of approximately equal in size.***
2. ***When layout is shown on Drawing, conform to that layout.***
3. ***Permit no tile dimension of less than 4 inches without obtaining permission from the Resident Engineer.***
4. ***In no case place to grid “T”s adjacent to one another.***
- ITEM #6      SECTION 01 33 23 – SHOP DRAWINGS, PRODUCT DATA, AND SAMPLES
- A.      **REVISE** Article 1.3, Paragraph D, Subparagraph 1 to read:
1. Allow 10 ***business*** days for Architect/Engineer review.
- B.      **REVISE** Article 1.3, Paragraph D, Subparagraph 2.
1. Allow ~~44~~ ***10 business*** days for VA review after completion of review by Architect/Engineer.
- ITEM #7      SECTION 10 14 00 – SIGNAGE
- A.      Revise Signage Schedule as follows:
1.      **REVISE** signage to be provided for Room 2912 per attached revised signage schedule.
2.      **REVISE** signage to be provided for Room 2948 per attached revised signage schedule.
- ITEM #8      SECTION 23 31 00 – 3.1 - INSTALLATION
- A.      **REVISE** Paragraph K. Protection and Cleaning to read: ***“Protect equipment and ducts during construction against entry of foreign matter including construction dust to the inside. Equipment and ducts shall be clean both inside and outside before operation and painting. All new and existing ductwork shall be cleaned by mopping and vacuuming inside and outside before operation.”***
- B.      **ADD** to Paragraph K. Protection and Cleaning ***“All ductwork openings shall be covered throughout construction and contractor shall provide complete duct cleaning before VA acceptance. Provide documentation of ductwork cleaning to Resident Engineer.”***

- ITEM #9 SECTION 23 31 00 – Part 3
- A. **ADD** ***“Section 3.5 – PRE-OCCUPANCY FLUSH OUT – Contractor shall provide pre-occupancy project area air flush out in accordance with LEED credit IEQc3.2 – Option 1, Path 2 or Option 2 – Air Testing, at the contractor’s discretion. Coordinate option with Resident Engineer.”***

APPLICABLE TO DRAWINGS

- ITEM #10 SHEET A101-4 – SECOND LEVEL FINISH FLOOR PLAN, ROOM FINISH SCHEDULE
- A. **REMOVE** rooms B907, B934, 1954, 1956, and 1959 from the Room Finish Schedule.
- ITEM #11 SHEET AD100-4 – DEMOLITION – ATTIC FLOOR PLAN
- A. **RELOCATE** Keynote Legend to allow readability for Demolition General Note G24. Demolition General Note G24 to read: ***“Remove, Patch, Repair all sections of the existing plaster wall finish to remain as necessary. Finish wall repaired per Room Finish Schedule. Refer to Specifications Section 01 70 29 and 4/500-4.”***
- ITEM #12 SHEET A110-4 – SECOND LEVEL REFLECTED CEILING PLANS
- A. **ADD** B/A110-4 – Basement Level Reflected Ceiling Plan. Refer to ASD-001.
- B. **ADD** Keynote 15 to Keynote Legend. Keynote 15 to read: ***“Replace damaged acoustical ceiling tile located within hatched area.”***
- ITEM #13 SHEET A600-4 – DOOR SCHEDULES AND DETAILS
- A. **REMOVE** door numbers 2954F & 2954G from the Door Schedule.
- ITEM #14 SHEET FX100-4 – PARTIAL FLOOR PLANS – FIRE PROTECTION
- A. **ADD** high temperature rated, dry type sidewall sprinkler head coverage for unheated Electrical Equipment room E022. Connection to existing fire sprinkler line shall be done as afterhours work and any fire protection shutdowns shall be coordinated with COTR and Authority Having Jurisdiction. Notice shall be given to COTR and Authority Having Jurisdiction a minimum of one week in advance.
- ITEM #15 SHEET FX101-4 – PARTIAL FLOOR PLANS – FIRE PROTECTION
- A. **ADD** Bubble to indicate after hours work for fire protection work for 2<sup>nd</sup> Floor affecting Office E154 and Waiting Room E127 below on 1<sup>st</sup> floor.
- ITEM #16 SHEET FX102-4 – PARTIAL FLOOR PLANS – FIRE PROTECTION
- A. **ADD** dry type pendant sprinkler head coverage for overhead canopy at main entry on north side of the building. Provide piping from attic space above.
- ITEM #17 SHEET PD100-4 – PARTIAL FLOOR PLANS – PLUMBING DEMOLITION
- A. **ADD** Bubble to indicate after hours work for plumbing demolition for 2<sup>nd</sup> Floor Men’s and Women’s room affecting Office 113, Office 114, and

Office 115 below on 1<sup>st</sup> floor.

- ITEM #18 SHEET PL100-4 – PARTIAL FLOOR PLANS – PLUMBING
- A. **ADD** Bubble to indicate after hours work for plumbing work for 2<sup>nd</sup> Floor Director's Suite affecting Travel Clerk Area below on 1<sup>st</sup> floor.
  - B. **ADD** Bubble to indicate after hours work for plumbing work for 2<sup>nd</sup> Floor Restrooms affecting Restrooms below on 1<sup>st</sup> floor.
  - C. **ADD** Bubble to indicate after hours work for plumbing work for 2<sup>nd</sup> Floor Kitchenette affecting Office 114 below on 1<sup>st</sup> floor. Office 114 could be affected for a prolonged period of time.
- ITEM #19 SHEET MP100-4 – PARTIAL FLOOR PLANS – MECHANICAL PIPING
- A. **ADD** Bubble to indicate after hours work for mechanical piping work for tie in and extension of HWS and HWR mains up to the 2<sup>nd</sup> Floor affecting Waiting Room E127 below on 1<sup>st</sup> floor.
- ITEM #20 SHEET ED101-4 – ELECTRICAL DEMOLITION WORK – FLOOR PLANS
- A. **ADD** (1) ceiling mounted wireless access point to Corridor EC202 in-between grid lines 7 and 8 on the Second Floor Plan. Show to be demolished.
  - B. **ADD** general note 11 which reads as follows: ***“Remove and return wireless access points and security cameras to the COR.”***
- ITEM #21 SHEET EP101-4 – ELECTRICAL POWER NEW WORK – SECOND FLOOR PLAN
- A. **REVISE** layout of existing equipment in Electrical Room B022 for clarification. Reference attached supplemental drawing ESD-001.
  - B. **ADD** keyed note (19) to panelboard 3-1-6 which reads as follows: ***“Demolish abandoned pull box and associated conduits in panelboard 3-1-6 location.”***
  - C. **ADD** keyed note (20) to 3-1-11 enclosed circuit breaker which reads as follows: ***“Relocate 3-1-11 within Electrical Room E022 as necessary to make space available for new 3-B-10E distribution type panelboard.”***
- ITEM #22 SHEET EP501-4 – ELECTRICAL POWER NEW WORK – ONELINE SCHEMATIC AND SCHEDULES
- A. **ADD** note to panelboard schedule 3-2-1E: ***“PROVIDE WITH DOUBLE INCOMING LUGS”***.
  - B. **ADD** note to 150A circuit breaker located in SWBD 3-1 which reads as follows: ***“Provide new in existing available space. Provide all necessary mounting hardware for a complete installation.”***
  - C. **REVISE** feeder from panelboard 3-2-1E to 3-2-2E to the following: ***“4-#1 & #8 GND; 1-1/4”C.”***
- ITEM #23 SHEET EL101-4 – ELECTRICAL LIGHTING NEW WORK – SECOND FLOOR PLAN
- A. **DELETE** keyed note 6 from F6 lighting fixture on second floor plan.
  - B. **REVISE** keyed note 6 to ***“NOT USED.”***

- C. **ADD** wall mounted dimmer switch labeled 'd' to Director's Conference Room 2956 adjacent to dimmer switch labeled 'b'. Control the indirect lighting of suspended F3 fixtures with dimmer switch 'd' and the direct lighting of suspended F3 fixtures with dimmer switch 'b'.
- D. **ADD** keyed note 8 to F9 fixtures located in the Basement Electrical Room and First Floor Electrical Rooms which reads as follows: ***"INSTALL LIGHT FIXTURES WITHIN 8 WEEKS OF NOTICE TO PROCEED."***

ITEM #24 SHEET EL601-4 – LIGHTING FIXTURE SCHEDULE AND DETAILS

- A. See attached supplemental drawing ESD-002.

ATTACHMENTS:

- 1. Signage Schedule: Specifications Page 10 14 00-4 (Page 3 of 5 signage schedule pages - 8½x11)
- 2. ASD-001: B/A110-4 – Basement Level Reflected Ceiling Plan
- 3. ESD-001: 5/EP101-4 – Basement Partial Plan – Electrical 022
- 4. ESD-002: EL601-4 – Lighting Fixture Schedule

END OF AMENDMENT ONE  
Issued July 11, 2013

CORRECT CITED SAFETY, SECURITY AND FACILITY CONDITION ASSESSMENTS  
FOR BUILDING 3 636A6-13-809

SIGNAGE SCHEDULE

SIGN TYPE	NEW RM NO	EXISTING NO	MESSAGE	COMMENTS	FLOOR PLAN NAME/NUMBER REFERENCE ONLY
B (IN-03.01 IN-04.02, IN-04.02A)	2908B	NEW	(NEW) Top Panel to read: 2908B (T&B)  (NEW) Middle Panel to read: ASSOCIATE NURSE EXECUTIVE (T&B)  (NEW) Bottom Panel to read: ***coordinate name with VA via submittal process***	New top, middle, and bottom panels	Nurse Manager 2908B
B (IN-03.01 IN-04.02, IN-04.02A)	2909	NEW	(NEW) Top Panel to read: 2909 (T&B)  (NEW) Middle Panel to read: STAFF ASSISTANT (T&B)  (NEW) Bottom Panel to read: ***coordinate name with VA via submittal process***	New top, middle, and bottom panels	Office 2909
9.07 (IN-03.01 & IN-09.06)	2912	NEW	(NEW) Top Panel to read: 2912 (T&B)  (NEW) Bottom panel to read: (stairs and arrow picto) STAIRWELL 3-1 EXIT (T&B) FIRE DOOR KEEP CLOSED	New top and bottom panels	Stair No. 1 2912
B (IN-03.01 IN-04.02, IN-04.02A)	-	2911 RELOC	(RELOC) Top Panel to read: 2911 (T&B)  (RELOC) Blank Middle Panel.  (RELOC) Bottom Panel to read: ***coordinate name with VA via submittal process***	Relocate top, middle, and bottom panels.  Glass Mounted Sign.  Provide blank 9"x9" sign (IN- 09.06 with no text) on office side of glass aligned to corridor side to hide mounting tape from being seen inside room. Blank to match color of corridor side.  Consult Architect for exact location before installation	Office 2911
9.07 (IN-03.01 & IN-09.06)	2948	NEW	(NEW) Top Panel to read: 2948 (T&B)  (NEW) Bottom panel to read: (stairs and arrow picto) STAIRWELL 3-2 EXIT (T&B) FIRE DOOR KEEP CLOSED	New top and bottom panels.	Stair No. 2 2948
A (IN-03.01 & IN-04.01)	-	2951	(EXIST) Top Panel to read: 2951 (T&B) (EXIST) Large Bottom Panel to read: ELECTRICAL (T&B)	Reinstall top panel.  Reinstall bottom panel from E210.	Elec. Clst. 2951
A (IN-03.01 & IN-04.01)	-	2953 RELOC	(RELOC) Top Panel to read: 2953 (T&B)  (NEW) Large Bottom Panel to read: TEAM ROOM (T&B)	Relocate top panel.  New bottom panel.	Team Room 2953
A (IN-03.01 & IN-04.01)	-	2954 RELOC	(RELOC) Top Panel to read: 2954 (T&B)  (NEW) Large Bottom Panel to read: SWING SPACE (T&B)	Relocate top panel.  New bottom panel.	Swing Space 2954



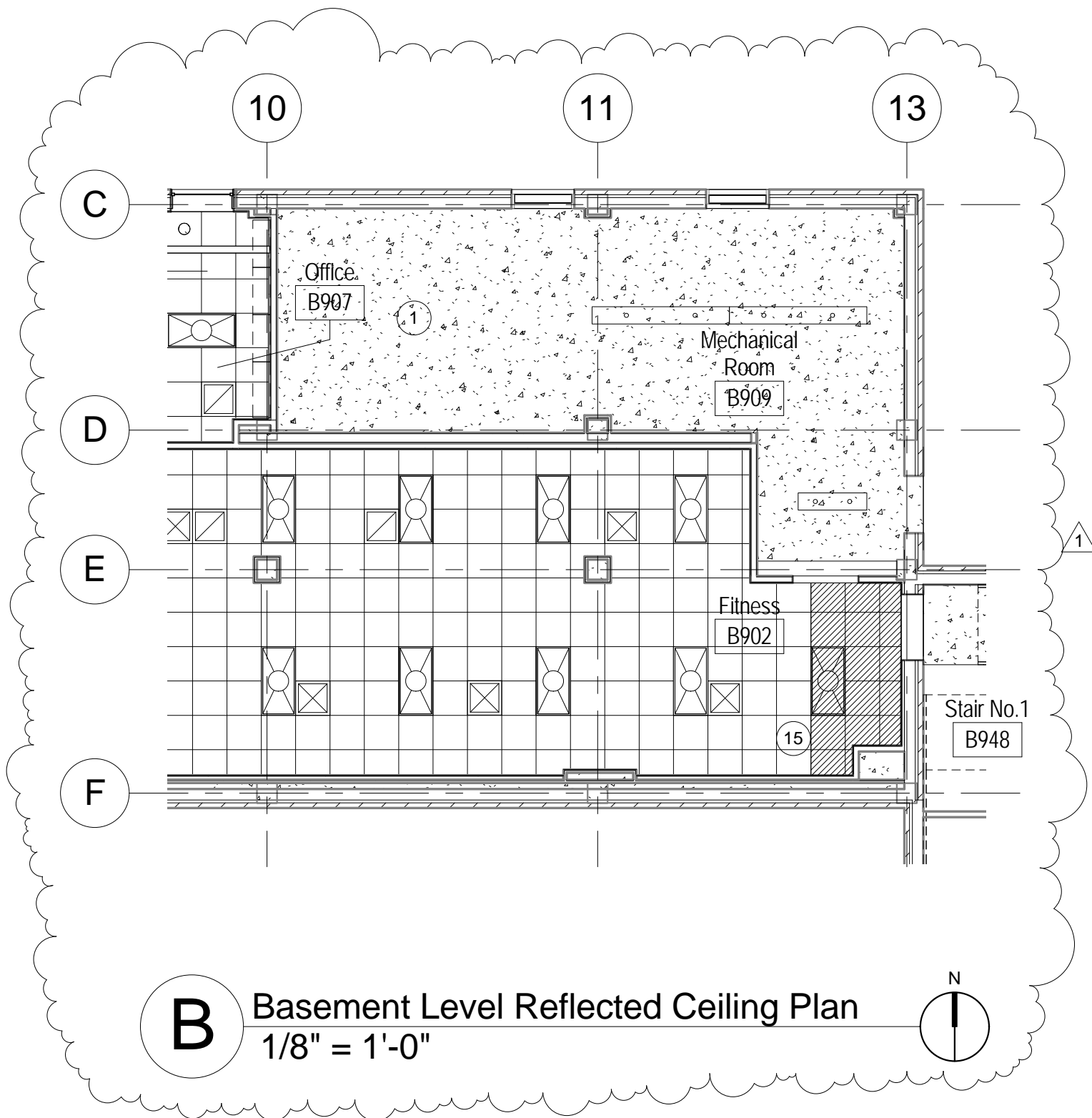

VA Central Iowa Health Center  
 Correct Cited Safety, Security and  
 Facility Condition Assessments for  
 Bldg 3

PROJECT  
 DATE  
 SCALE

07062.04  
 07/11/2013  
 1/8" = 1'-0"

SHEET TITLE  
 Supplemental Drawing -  
 ADD B/A110-4 to Sheet  
 A110-4

SHEET NO.

**ASD-001**

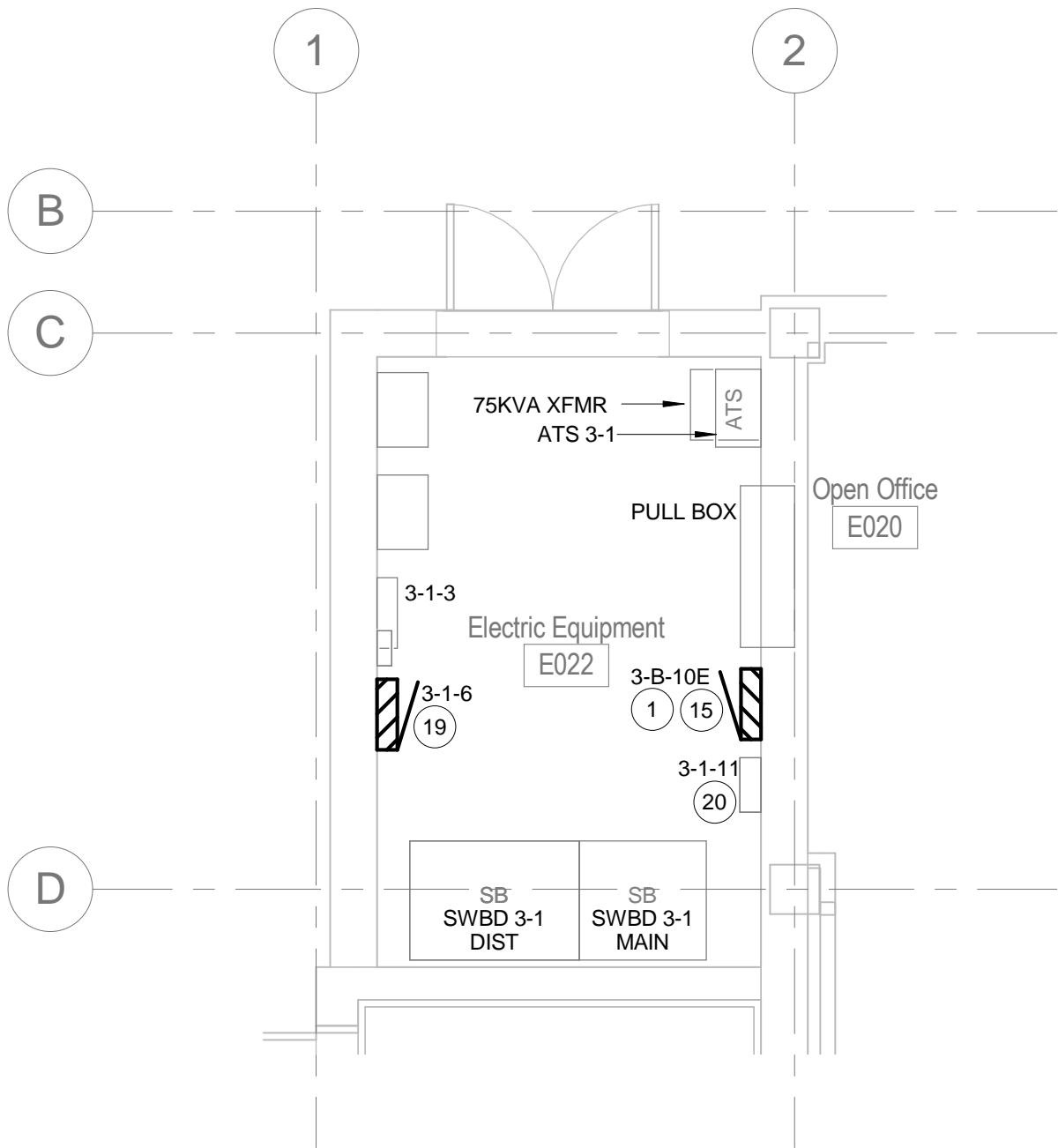

5

## Basement Partial Plan - Electrical 022

1/4" = 1'-0"



VA Central Iowa Health  
Center Phase IV; Bldg 3

PROJECT

07062.04

DATE

07/10/13

SCALE

As indicated

SHEET TITLE

Supplemental Drawing -  
Refer to Sheet EP101-4;  
ELECTRICAL POWER  
NEW WORK

SHEET NO.

ESD-001



TYPE	MANUFACTURER & MODEL NUMBER	MOUNTING	NOMINAL DIMENSIONS	LAMPS	VOLTAGE	BALLAST	DETAILS
F2	GOTHAM EVO-SQ-41-10-6AR	RECESSED	13-7/8"W x 12-3/8"L x 6-3/4"D WITH 6" MINIMUM SQUARE APERTURE	4100°K >80CRI LEDS INCLUDED	120/277	ELECTRONIC LED DRIVER. 700mA MAXIMUM DRIVE CURRENT.	ONE-PIECE SEMI-SPECULAR, REFLECTOR WITH NO MITERED CORNERS. 1100 MINUM DELIVERED LUMENS (ABSOLUTE PHOTOMETRY), 22 WATT MAXIMUM INPUT POWER. INTEGRAL OVERLOAD AND SHORT CIRCUIT PROTECTION. LED LIGHT ENGINE AND DRIVER ACCESSIBLE AND SERVICABLE WITHOUT REMOVAL OF FIXTURE HOUSING FROM CEILING.
F2A	GOTHAM ECSSW-41-12-6-AR-TRBL	RECESSED	13-7/8"W x 12-3/8"L x 6-3/4"D WITH 6" MINIMUM SQUARE APERTURE	4100°K >80CRI LEDS INCLUDED	120/277	ELECTRONIC LED 0-10V DIMMING DRIVER. MINIMUM DIMMING RANGE: 100-10%	ONE-PIECE SEMI-SPECULAR REFLECTOR WITH NO MITERED CORNERS. 1200 MINUM DELIVERED LUMENS (ABSOLUTE PHOTOMETRY), 45 WATT MAXIMUM INPUT POWER. INTEGRAL OVERLOAD AND SHORT CIRCUIT PROTECTION. LED LIGHT ENGINE AND DRIVER ACCESSIBLE AND SERVICABLE WITHOUT REMOVAL OF FIXTURE HOUSING FROM CEILING. PROVIDE WITH BLACK FLANGE.
F3	LUMENPULSE LLI2P-DI-120-8-dHO40K-iRO40K-DIM-ACC50-SI	SUSPENDED	2-11/16"W X 16"L X 4-9/16"D.	4000°K >80CRI LEDS INCLUDED	120	ELECTRONIC LED 0-10V DIMMING DRIVER. MINIMUM DIMMING RANGE: 100-10% 500mA MAXIMUM DRIVE CURRENT. UPLIGHT AND DOWNLIGHT CONTROLLED SEPARATELY.	TWO SEAMLESS 8 FOOT SECTIONS MADE OF EXTRUDED ALUMINUM HOUSING ATTACHED BY AN INTERNAL JOINER SYSTEM AND PLUG-TOGETHER WIRING TO FORM A CONTINUOUS 16 FOOT FIXTURE. FROSTED WHITE DIFFUSERS FOR BOTH UP AND DOWN LIGHT. BOTTOM DIFFUSER SHALL BE UNIFORMLY ILLUMINATED WITH NO VISIBLE LEDS. FULLY ADJUSTABLE 36" MINIMUM LONG AIRCRAFT CABLE SUSPENSION MOUNTING ASSEMBLIES WITH SILVER CANOPIES AND GRAY POWER FEED SJO CORD. METALLIC SILVER POWDER COAT FINISH.
F4	LAMAR LIGHTING C2-2-32-E8/IOP2S-U-PA-AS- <del>EMB50ST</del>	SURFACE	5-7/8"W X 48"L X 4-1/4"D.	2-F32T8/ XL/SPX65/ECO	120/277	ELECTRONIC PS ADVANCE IOP-2S32-SC	COLD ROLLED STEEL HOUSING AND END PLATES WITH WHITE POLYESTER POWDER COAT FINISH ELECTROSTATICALLY APPLIED AND BAKED AFTER FABRICATION. LINEAR AND CONICAL PRISMATIC EXTRUDED ACRYLIC DIFFUSER. INTEGRAL ULTRASONIC OCCUPANCY SENSOR WITH FIELD ADJUSTABLE STANDBY LIGHT LEVEL SETTINGS. <del>FACTORY-INSTALLED BODINE B50ST SELF-TESTING EMERGENCY-LIGHTING INVERTER AND VISIBLE TEST SWITCH.</del>
X1	DUAL-LITE SESGWNAC	UNIVERSAL	8-1/8"W X 12-5/8"L X 1-5/8"D	GREEN LEDS INCLUDED	120/277	-	<del>SELF-POWERED AND SELF-DIAGNOSTIC</del> LED EXIT SIGN WITH WHITE DIE-CAST ALUMINUM HOUSING AND SINGLE DIE-CAST BRUSHED ALUMINUM STENCIL LETTERING PANEL. CANOPY AND MOUNTING HARDWARE INCLUDED FOR WALL, CEILING OR END MOUNTING APPLICATIONS. SNAP OUT DIRECTIONAL CHEVRONS.