

three inches = one foot
one and one half inches = one foot
one inch = one foot
one half inch = one foot
three quarters inch = one foot
one half inch = one foot
one quarter inch = one foot
one eighth inch = one foot
one eighth inch = one foot

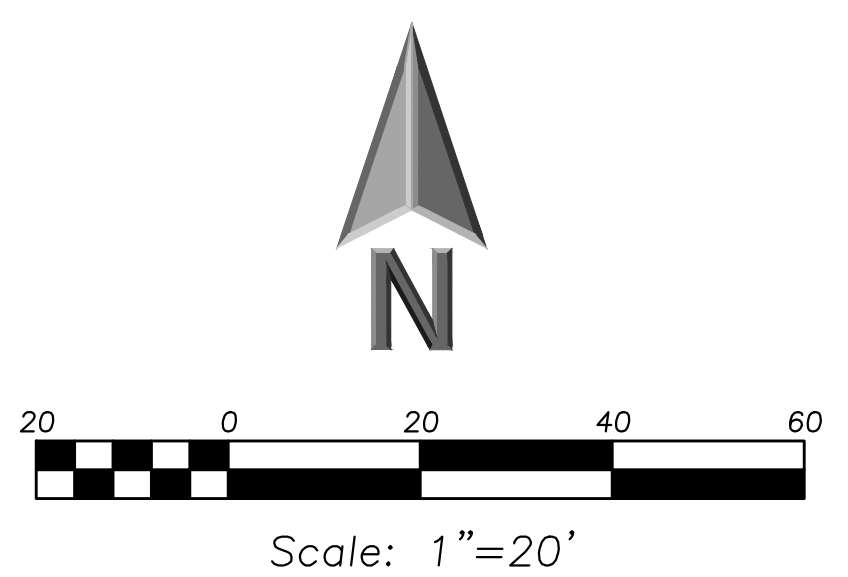
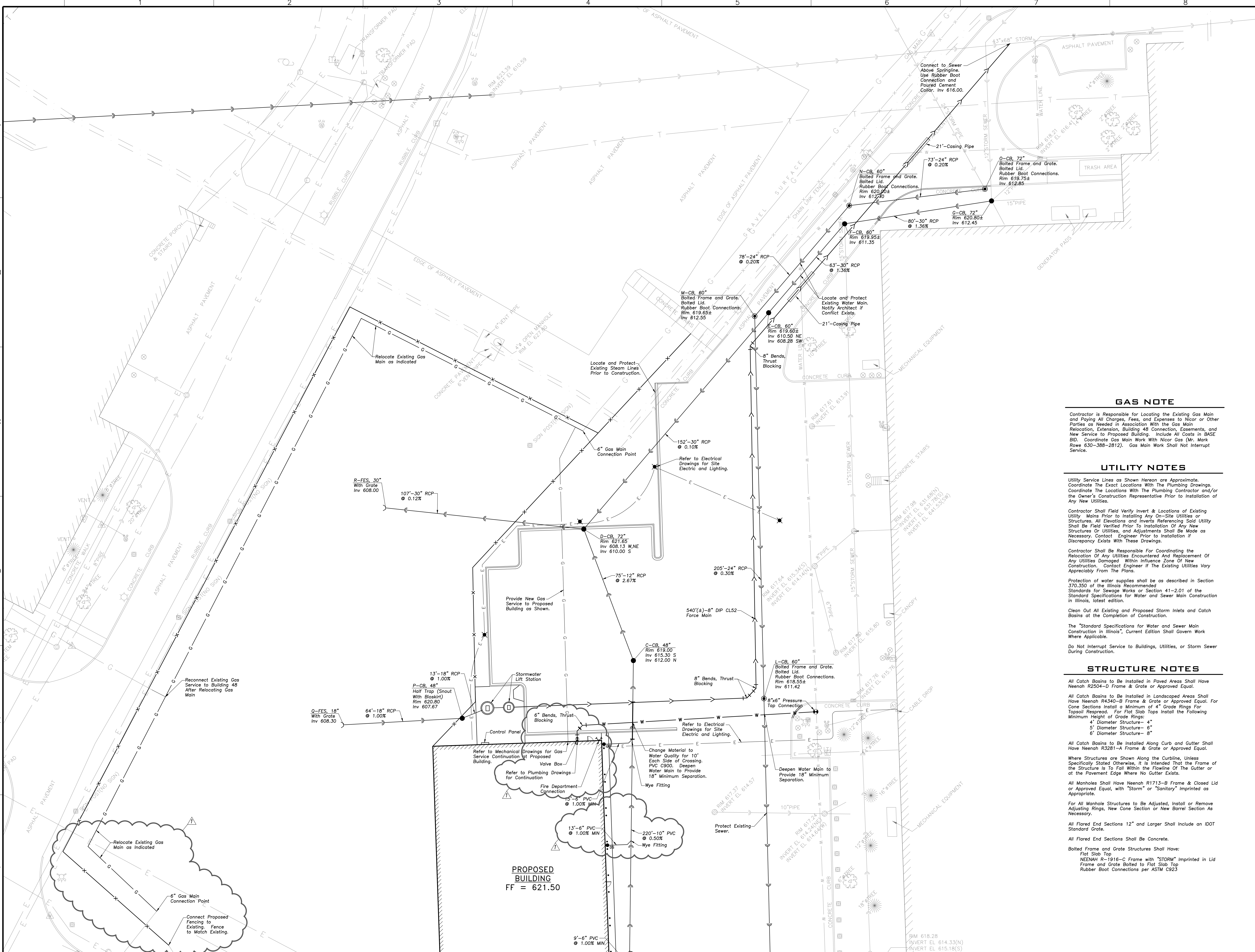

LEGEND	
EXISTING	PROPOSED

GAS NOTE

Contractor is Responsible for Locating the Existing Gas Main and Paying All Charges, Fees, and Expenses to Nicor or Other Parties as Needed in Association With the Gas Main Relocation, Extension, Building 48 Connection, Easements, and New Service to Proposed Building. Include All Costs in BASE BID. Coordinate Gas Main Work With Nicor Gas (Mr. Mark Rowe 630-388-2812). Gas Main Work Shall Not Interrupt Service.

UTILITY NOTES

Utility Service Lines as Shown Hereon are Approximate. Coordinate the Exact Locations With the Plumbing Contractor and/or the Owner's Construction Representative Prior to Installation of Any New Utilities.

Contractor Shall Field Verify Invert & Locations of Existing Utility Mains Prior to Installing Any On-Site Utilities or Structures. All Elevations and Inverts Referencing Said Utility Shall Be Field Verified Prior to Installation of Any New Structures or Utilities, and Adjustments Shall Be Made as Necessary. Contact Engineer Prior to Installation if Discrepancy Exists With These Drawings.

Contractor Shall Be Responsible for Coordinating the Relocation of Any Utilities Encountered And Replacement of Any Utilities Damaged Within Influence Zone of New Construction. Contact Engineer if the Existing Utilities Vary Appreciably From The Plans.

Protection of water supplies shall be as described in Section 370.350 of the Illinois Recommended Standards for Sewage Works or Section 41-2.01 of the Standard Specifications for Water and Sewer Main Construction in Illinois, latest edition.

Clean Out All Existing and Proposed Storm Inlets and Catch Basins at the Completion of Construction.

The "Standard Specifications for Water and Sewer Main Construction in Illinois", Current Edition Shall Govern Work Where Applicable.

Do Not Interrupt Service to Buildings, Utilities, or Storm Sewer During Construction.

STRUCTURE NOTES

All Catch Basins to Be Installed in Paved Areas Shall Have Neenah R204-D Frame & Grate or Approved Equal. All Catch Basins to Be Installed in Landscaped Areas Shall Have Neenah R4340-B Frame & Grate or Approved Equal. For Concrete Sections Install a Minimum of 4" Grade Rings For Topsoil Respread. For Flat Slab Tops Install the Following Minimum Height of Grade Rings:

- 4" Diameter Structure - 4"
- 5" Diameter Structure - 5"
- 6" Diameter Structure - 6"

All Catch Basins to Be Installed Along Curb and Gutter Shall Have Neenah R3281-A Frame & Grate or Approved Equal.

Where Structures are Shown Along the Curbline, Unless Specifically Stated Otherwise, It is Intended That the Frame of the Structure is To Fall Within the Flowline of the Gutter or at the Pavement Edge Where No Gutter Exists.

All Manholes Shall Have Neenah R1713-B Frame & Closed Lid or Approved Equal, with "Storm" or "Sanitary" Imprinted as Appropriate.

For All Manhole Structures to Be Adjusted, Install or Remove Adjusting Rings, New Cone Section or New Barrel Section As Necessary.

All Flared End Sections 12" and Larger Shall Include an IDOT Standard Grate.

All Flared End Sections Shall Be Concrete.

Bolted Frame and Grate Structures Shall Have:

- Flat Slab Top
- NEENAH R-1916-C Frame with "STORM" Imprinted in Lid
- Frame and Grate Bolted to Flat Slab Top
- Rubber Boot Connections per ASTM C923

GENERAL NOTES

The Location of Existing Underground Utilities, Such As Watermains, Sewers, Gas Lines, Etc., As Shown On The Plans, Has Been Determined From The Best Available Information And Is Given For The Convenience Of The Contractor. However, The Owner And The Engineer Do Not Assume Responsibility In The Event That During Construction, Utilities Other Than Those Shown May Be Encountered, And That The Actual Location Of Those Which Are Shown May Be Different From The Location As Shown On The Drawings. Contact Engineer Immediately if Surface And/or Subsurface Features are Different Than Shown On The Drawings.

Contractor Shall Notify The Engineer Without Delay Of Any Discrepancies Between The Drawings And Existing Field Conditions.

Contractor Shall Notify The Owner And Architect. A Minimum Of 48 Hours in Advance Of Performing Any Work.

All Areas, On Or Off Site, Disturbed During Construction Operations And Not Part Of The Work As Shown Hereon Shall Be Restored To Original Condition To The Satisfaction Of The Owner At No Additional Cost To The Owner. It is Incumbent Upon Contractor To Show That Damaged Areas Were Not Disturbed By Construction Operations.

These Drawings Assume That The Contractor Will Utilize An Electronic Drawing File And Stake All Site Improvements Using Coordinates Tied Into The Control Points. The Dimensions Indicated On The Drawings Are For The Convenience Of The Contractor Only.

No Person May Utilize The Information Contained Within These Drawings Without Written Approval From Eriksson Engineering Associates, Ltd.

The Engineer is Furnishing These Drawings For Construction Purposes As A Convenience To The Owner, Architect, Or Surveyor. Prior To The Use Of These Drawings For Construction Purposes, The User Of This Media Shall Verify All Dimensions And Locations Of Buildings With The Foundation Drawings And Architectural Site Plan. If Conflicts Exist The User Of This Information Shall Contact The Engineer Immediately.

Contractor Shall Provide An As-Built Survey Prepared By A Licensed Professional Land Surveyor in Accordance With The Authorities Having Jurisdiction Which May Include All Detention Basins, Including All Storm And Sanitary Sewers And Structure Locations, Sizes, Rim And Invert Elevations, Final Detention Volume Calculations For The Basin(s) And Watermain And Valve And Appurtenance Locations.

The Illinois Department of Transportation Standard Specifications For Road And Bridge Construction Latest Edition, And All Addenda Thereof, Shall Govern The Work Under This Contract Unless Noted Otherwise.

Standard Specifications For Sewer And Water Main Construction in Illinois Shall Govern Work.

Illinois Urban Manual Shall Govern Work.

Contractor Shall Repair Or Replace All Damaged Sidewalks, Curbs, Or Paving To Remain In Place, G.C. See All Drawings Outlining Existing & Extent Of Demo Areas.

Contractor is Responsible for Watering All Plant Material During The Course of Construction And Until Owner Takes Possession After Punchlist is Complete And Project is Closed Out.

J.U.L.I.E.

Note: The exact location of all utilities shall be verified by the contractor prior to construction activities. For utility locations call: J.U.L.I.E. 1 (800) 892-0123

CONSULTANTS:		ARCHITECT/ENGINEERS:		Drawing Title UTILITY PLAN: NORTH		Project Title HINES BUILDING 37 STORAGE BUILDING AND PARKING LOT EXPANSION		Project Number 796-10-017		Office of Construction and Facilities Management		
 ERIKSSON ENGINEERING ASSOCIATES, LTD. 145 COMMERCIAL DRIVE, SUITE A GRAYSLAKE, ILLINOIS 60030 PHONE: (847) 523-4804 FAX: (847) 523-4864 EMAIL: INFO@EEA-LTD.COM		 Kluber Architects + Engineers Kluber, Inc. 901 N. Batavia Ave., Suite 301 Batavia, Illinois 60010 tel. 630.406.1213 fax 630.406.9472 www.kluberinc.com		Approved: Project Director		Location VA SERVICE AND DISTRIBUTION CENTER HINES, ILLINOIS		Building Number 37				
ADDENDUM NO. 1 07-22-13 03-12-13 Revisions: Date						Date 03-12-13		Checked GD		Drawn TLH		
								Drawing Number 37-C005		Dwg. 7 of 30		

VA FORM 08-6231