

three inches = one foot  
one and one half inches = one foot  
one inch = one foot  
three quarters inch = one foot  
one half inch = one foot  
three eighths inch = one foot  
one quarter inch = one foot  
one eighth inch = one foot

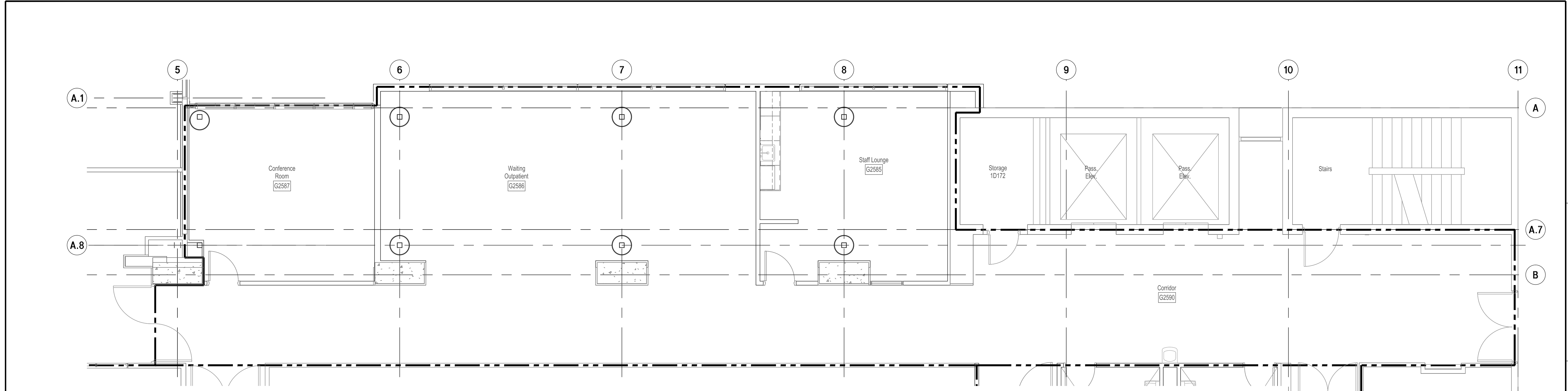

1 Partial Second Floor Phase 1E North Medical Gas Piping Plan  
1/4" = 1'-0"

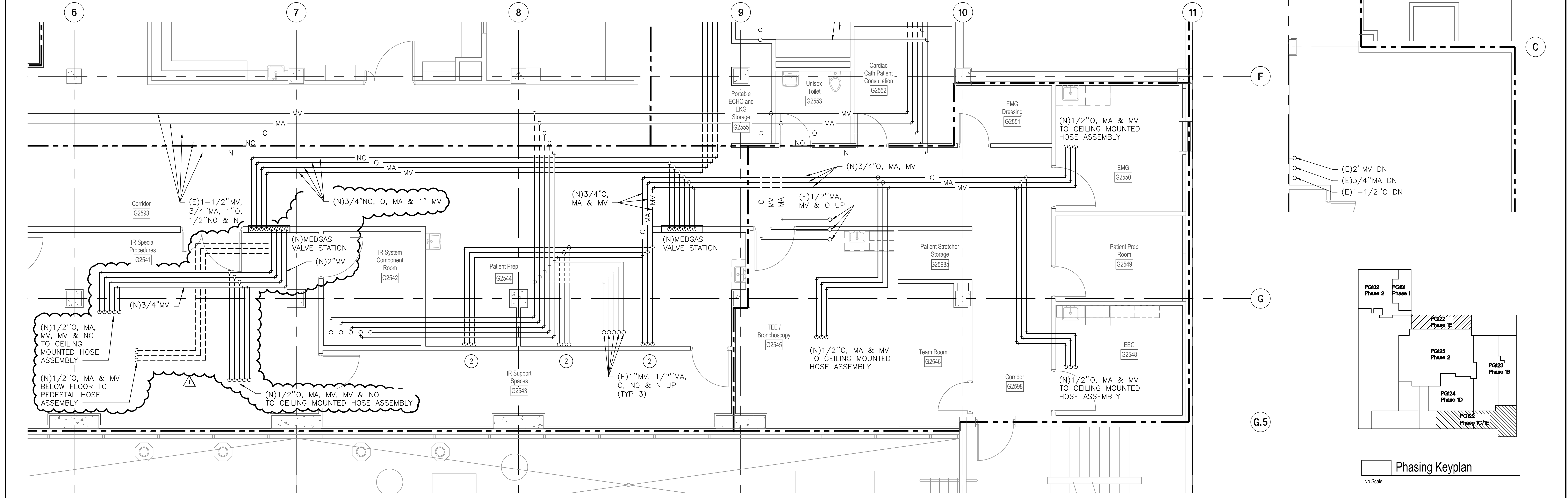

1 Partial Second Floor Phase 1C & 1E East Medical Gas Piping Plan  
1/4" = 1'-0"

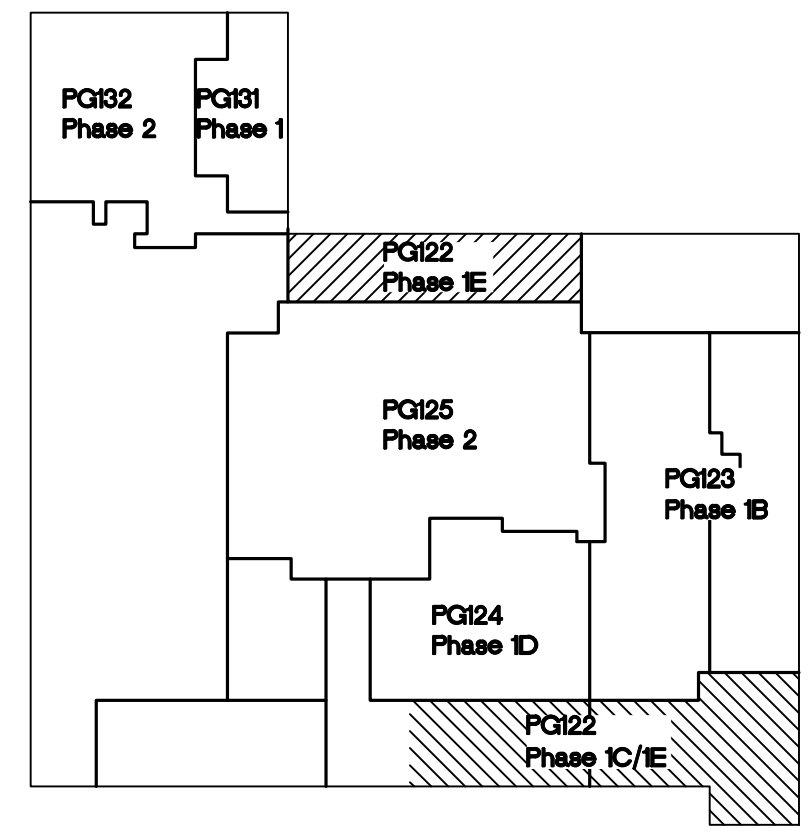

Phasing Keyplan  
No Scale

<b>CONSULTANTS:</b>  PETTY & ASSOCIATES, INC. 1375 OREG STREET, SUITE 108 SPARKS, NEVADA 89431 (775) 359-5777 FAX: 359-1119 PA# 294610		<b>ARCHITECT/ENGINEERS:</b> <b>H+K ARCHITECTS</b> 5485 Reno Corporate Drive, Suite 100 Reno, Nevada 89511-2262 P 775+332+6640 F 775+332+6642 hkarchitects.com		<b>Drawing Title</b> Second Floor Phase 1C, 1E East & 1E North Medical Gas Piping Plans <b>Approved:</b> Project Director		<b>Project Title</b> Remodel and Expansion of DICE Services <b>Location</b> 975 Kirman Ave., Reno, NV. 89502 <b>Date</b> 4/4/2013 <b>Checked</b> RA <b>Drawn</b> EM		<b>Project Number</b> 654-777 <b>Building Number</b> 1D <b>Drawing Number</b> PG122		<b>Office of Construction and Facilities Management</b> 	
<b>AMENDMENT DRAWINGS</b> Revisions: 07/25/13 Date		<b>Professional Seal</b>									