

CONSULTANTS:	
Architect ARRAY 2520 Renaissance Blvd. Suite 110 King of Prussia, PA 19406 Tel: (610) 270-5599 Fax: (610) 270-5599	MEPFP Engineer APOGEE 7330 Chapel Hill Rd. Suite 202 Raleigh, NC 27607 Tel: (919) 858-7622 Fax: (919) 858-7423
Structural Engineer WZG 40 Little Rd. Zieglerville, PA 19402 Tel: (610) 287-3194	Abatement Consultant GOLDEN 1617 JFK Blvd. Suite 1705 Philadelphia, PA 19103 Tel: (215) 496-9237 Fax: (215) 496-9280
Revisions	
Date	

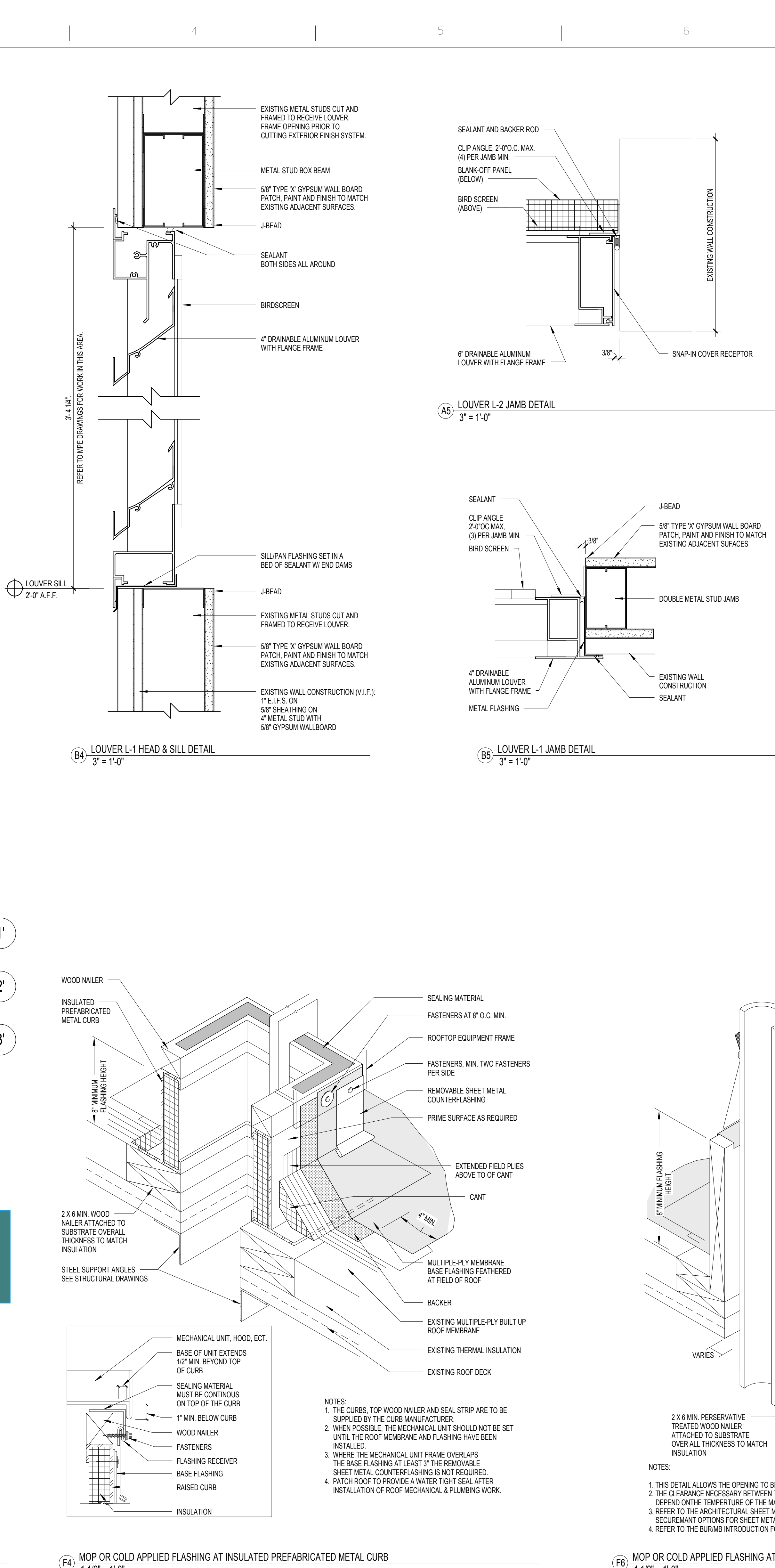

PROJECT MANAGER:		Project Number	Scale	Drawing Title
Bray Mooney Consulting		3659	As indicated	PENTHOUSE & ROOF PLANS
410 East 21st Street Chester, PA 19013 Tel: (215) 518-0864 Fax: (484) 428-1547		Approved: Project Director		
1 1/2" = 1'-0"		Location 1111 EAST END BLVD, WILKES-BARRE, PA 18711		
		Date	Checked	Drawn
		04/17/2013	WJ	WJ

ROOF PLAN GENERAL NOTES

- ALL DEMOLITION AND PATCHING WORK TO BE PERFORMED IN ACCORDANCE WITH SPECIFICATION SECTION 01 73 20, CUTTING AND PATCHING AND SECTION 02 41 00, DEMOLITION.
- NOTIFY ARCHITECT OF DISCREPANCIES BETWEEN EXISTING CONDITIONS AND DRAWINGS BEFORE PROCEEDING WITH SELECTIVE DEMOLITION.
- REMOVE NO MORE EXISTING ROOFING THAN WHAT CAN BE COVERED IN ONE DAY BY NEW ROOFING AND SO THAT BUILDING INTERIOR REMAINS WATERTIGHT AND WEATHERTIGHT.
- REMOVE, REPLACE, PATCH AND REPAIR MATERIALS AND SURFACES CUT OR DAMAGED DURING DEMOLITION AND INSTALLATION, BY METHODS AND WITH MATERIALS SO AS NOT TO VOID EXISTING ROOF WARRANTIES. NOTIFY ROOF WARRANTOR BEFORE PROCEEDING.
- NOTIFY ROOF WARRANTOR ON COMPLETION OF SELECTIVE DEMOLITION, AND OBTAIN DOCUMENTATION VERIFYING THAT EXISTING ROOF SYSTEM HAS BEEN INSPECTED AND WARRANTY REMAINS IN EFFECT. SUBMIT DOCUMENTATION AT PROJECT CLOSEOUT.
- NEW FLASHING AND SEALANT SHALL BE COMPATIBLE WITH EXISTING ROOFING SYSTEM.
- SUPPORT EXISTING METAL DECK AT ALL NEW ROOF PENETRATIONS AS SHOWN ON STRUCTURAL DRAWINGS.
- PROVIDE CRICKETS AT ALL NEW ROOF CURBS, EQUIPMENT SUPPORTS AND ENCLOSURES TO ENSURE POSITIVE DRAINAGE TO EXISTING ROOF DRAINS.
- CRICKETS SLOPE 1/2" PER FOOT.

EXTERIOR & ROOF PLAN KEYNOTES

R1	CONTRACTOR TO CUT EXISTING ROOFING SYSTEM AND METAL DECK AS REQUIRED TO INSTALL ROOF CURBS AND AIR HANDLING UNITS. CONTRACTOR TO PATCH AND REPAIR ROOF TO PROVIDE A WATERTIGHT SEAL. REFER TO STRUCTURAL AND MPE DRAWINGS FOR RELATED WORK IN THIS AREA.
R2	CONTRACTOR TO CUT EXISTING ROOFING SYSTEM AND METAL DECK AS REQUIRED TO INSTALL THRU-ROOF MECHANICAL DUCT AND ROOF CURB. CONTRACTOR TO PATCH AND REPAIR ROOF TO PROVIDE A WATERTIGHT SEAL. REFER TO STRUCTURAL AND MPE DRAWINGS FOR RELATED WORK IN THIS AREA.
R3	NOT USED
R4	CONTRACTOR TO CUT EXISTING ROOFING SYSTEM AND METAL DECK AS REQUIRED TO INSTALL ROOF CURB FOR MECHANICAL EXHAUST FAN. CONTRACTOR TO PATCH AND REPAIR ROOF TO PROVIDE A WATERTIGHT SEAL. REFER TO STRUCTURAL AND MPE DRAWINGS FOR RELATED WORK IN THIS AREA.
R5	CONTRACTOR TO CUT EXISTING ROOFING SYSTEM AND METAL DECK AS REQUIRED TO INSTALL ROOF CURB FOR MECHANICAL VENT ROOF CAP. CONTRACTOR TO PATCH AND REPAIR ROOF TO PROVIDE A WATERTIGHT SEAL. REFER TO STRUCTURAL AND MPE DRAWINGS FOR RELATED WORK IN THIS AREA.
R6	CONTRACTOR TO CUT EXISTING WALL SYSTEM AND PROVIDE FRAMING SUPPORT AS REQUIRED TO INSTALL ALUMINUM LOUVER. CONTRACTOR TO PATCH AND REPAIR WALL TO PROVIDE A WATERTIGHT SEAL. REFER TO MPE DRAWINGS FOR RELATED WORK IN THIS AREA.
R7	INSTALL 2" INSULATED BLANK-OFF PANEL BEHIND EXISTING LOUVER TO REMAIN. REFER TO MPE DRAWINGS FOR RELATED WORK IN THIS AREA.
R8	INSTALL 8" THICK CONCRETE HOUSEKEEPING PAD 6" LARGER THAN MECHANICAL UNIT. REFER TO MPE DRAWINGS FOR RELATED WORK IN THIS AREA. REFER TO STRUCTURAL DRAWINGS FOR DETAIL.

FULLY SPRINKLERED ISSUED FOR BID

KEY PLAN

VA Project Number 693-12-104		Office of Facilities Management
Building Number 1 & 27		
Drawing Number AE-151		Department of Veterans Affairs
Dwg. 16 of 79		