

1 PARTIAL BASEMENT FLOORPLAN - ELECTRICAL NEW WORK - POWER (OPTION A)
E-3 SCALE: 1/4" = 1'-0"

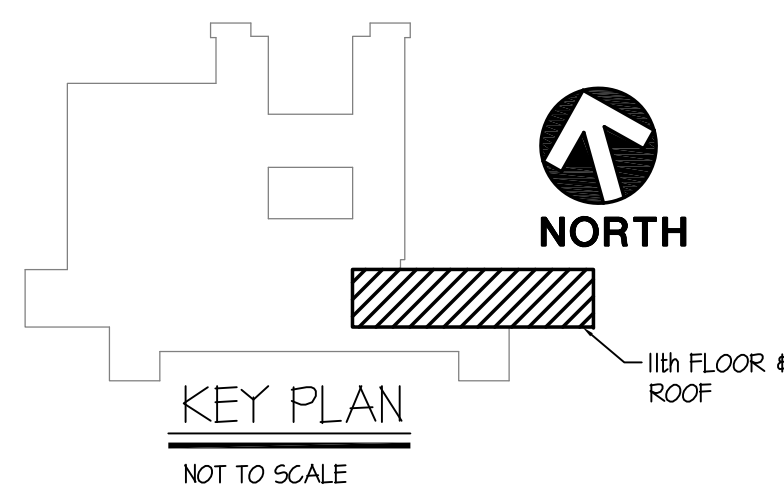

FIRSCHING, MARSTILLER, RUSBAISKY AND WOLF
ENGINEERING, INC.
2030 ARDMORE BOULEVARD, SUITE 250
PITTSBURGH, PA 15221
(412) 271-5090 PHONE (412) 271-5193 FAX
FILE NO. 07058

REVISIONS	DATE
RECORD DRAWINGS	12/15/08



VAPHS · UD
University Drive
Pittsburgh, PA 15240



A full service design/build construction company
436 Butler St. Pittsburgh, PA 15223 Ph: (412) 781-0119 Fax: (412) 781-2165

DRAWING TITLE	PARTIAL BASEMENT PLAN - ELECTRICAL NEW WORK
PROJECT NO.	646-06-112
CONTRACT NO.	V244C-0017
BUILDING NO.	1
JOB NO.	XXXXX
TUBE NO.	XXXXX

DESIGNED BY:	RPD
DRAWN BY:	WB
CHECKED BY:	LJL

PROJECT TITLE	DESIGN BUILD - REPLACE AHU 11E, 10E, 9E, 8E & 7E
LOCATION	VAMC UNIVERSITY DR. PITTSBURGH, PA

DATE	11/12/07
SCALE	AS NOTED
DRAWING NO.	E-3

DEPARTMENT OF
VETERANS AFFAIRS