

AUXILIARY PLAN GENERAL NOTES

- NURSE CALL DEVICES, CABLING, EQUIPMENT AND TERMINATIONS BY CONTRACTOR. BACK BOX, RACEWAY AND PULL TAPE BY CONTRACTOR.
- CONTRACTOR SHALL COORDINATE FINAL WIRELESS ACCESS POINT LOCATIONS WITH VAS WIRELESS VENDOR PRIOR TO ROUGH-IN.

AUXILIARY PLAN KEYNOTES

- PUNCH DOWN BLOCK
- NURSE CALL CONTROL PANELS BY CONTRACTOR. COORDINATE EXACT LOCATION WITH ALL OTHER DISCIPLINES
- 12" CABLE TRAY
- 6" CABLE TRAY
- PROVIDE TELECOM GROUNDING BUSBAR, SEE DETAIL A01E-001
- PROVIDE 3/4" RACEWAYS THRU SEPARATION WALL FOR COMMUNICATIONS CABLING. PROVIDE REQUIRED SMOKE/FIRE SEALANT
- EXISTING RELOCATED CEILING MOUNTED TELEMETRY AP. PROVIDE CAT 6 CABLE AND TERMINATION BACK TO ROOM #242 TELEMETRY EQUIPMENT
- TELEMETRY SYSTEM EXTENSION. COORDINATE EXACT REQUIREMENTS WITH PHILLIPS HEALTHCARE REPRESENTATIVE (TIM MOON/PHILLIPS HEALTHCARE 1-800-218-2045 EXT 3330)
- PROVIDE "RJ11" CABLE BETWEEN RM #229C AND RM #228C FOR TELEVISION SIGNAL. TERMINATE BOTH ENDS
- PROVIDE CONNECTION TO EXISTING PAGING SYSTEM
- REINSTALL EXISTING CEILING MOUNTED ELECTRICAL DEVICES IN NEW CEILING. COORDINATE WITH G.C.
- PROVIDE 4 CAT 6 CABLES TERMINATED AT BOTH ENDS FROM DATA OUTLETS TO ROOM #228C DATA RACK. (TYPICAL ALL DATA OUTLET LOCATIONS)
- PROVIDE 4 CAT 6 CABLES TERMINATED AT BOTH ENDS FROM EXISTING DATA OUTLETS TO ROOM #228C DATA RACK. TYPICAL
- PROVIDE FLUSH CEILING MOUNTED DATA JACK AND TWO CAT 6 CABLES BACK TO ROOM #228C FOR OWNER FURNISHED PROJECTOR. COORDINATE EXACT LOCATION WITH OWNER PRIOR TO ROUGH-IN.
- DATA JACK LOCATED IN POKE-THRU FLOOR DEVICE. SEE SHEET 5-EP101

PAGING SYSTEM EXTENSION

THIS CONTRACTOR SHALL PROVIDE A COMPLETE PAGING SYSTEM EXTENSION INCLUDING SPEAKERS, CONDUIT AND WIRING AS REQUIRED TO FORM A COMPLETE AND FULLY OPERABLE SYSTEM.

SYSTEM OPERATION:

THE PAGING SYSTEM SHALL OPERATE CONSISTENT WITH THE EXISTING SYSTEM CONFIGURATION.

EQUIPMENT:

SPEAKER SHALL BE 1/2 OUNCE MAGNET TYPE WITH BACKBOX, SUPPORTS, BAFFLE AND MULTI-TAP 70.7V TRANSFORMER. SPEAKER ASSEMBLY SHALL BE WHITE, 5" DEEP.

WIRE SHALL BE 18/2 TWISTED SHIELDED PAIR, PLENUM RATED.

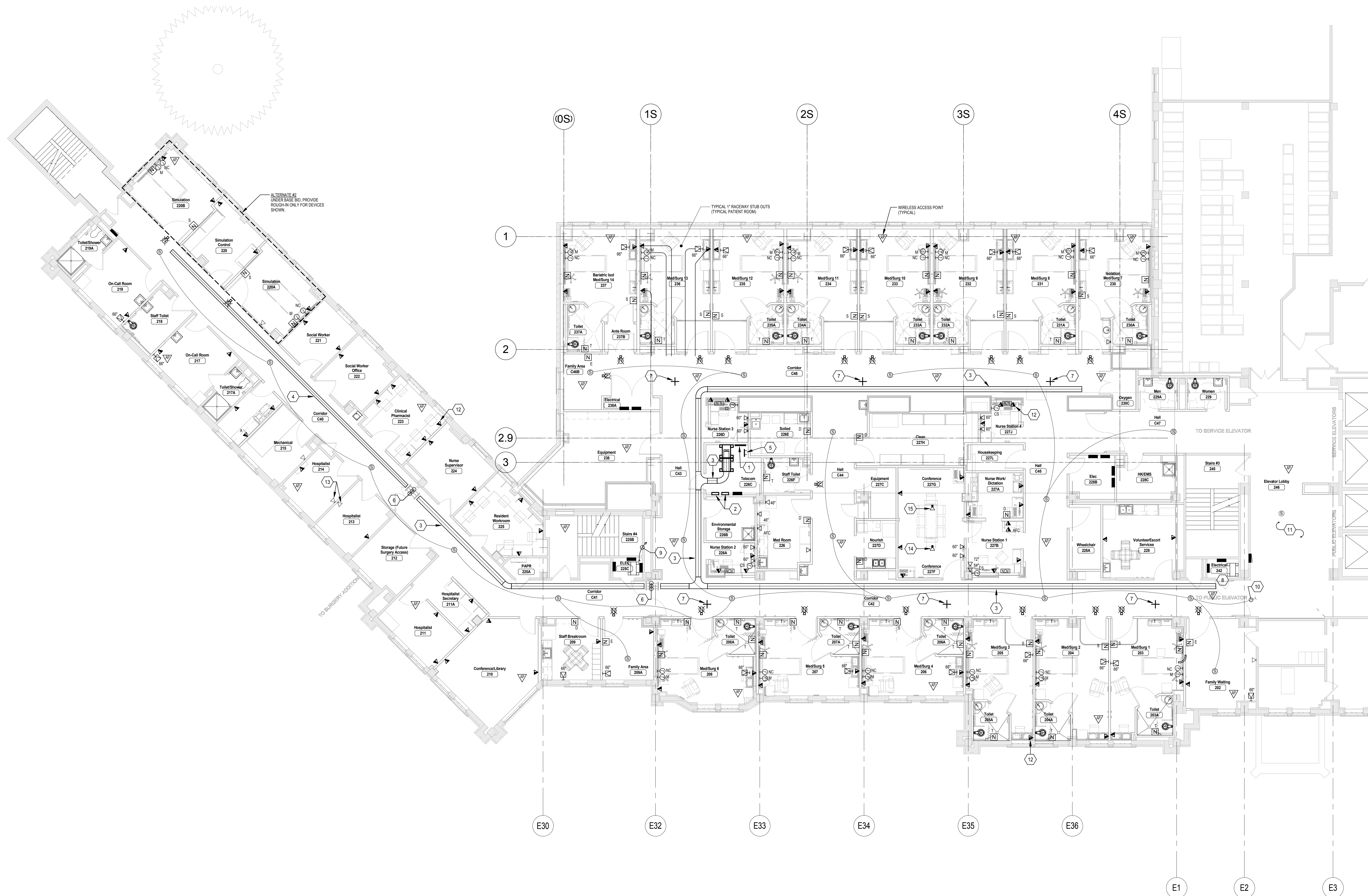

1F 2ND FLOOR AUXILIARY PLAN
1/8" = 1'-0"

CONSULTANTS:

ARCHITECTS/ ENGINEERS:

TSP, Inc.
1112 N. West Ave.
Sioux Falls, SD 57104
phone: (605) 336-1160
fax: (605) 336-1926
www.teamtsp.com



Drawing Title
2ND FLOOR AUXILIARY PLAN

Approved: Project Director

Project Title
**Sioux Falls VA Health Care System
Acute Inpatient Medical Unit Addition
and Renovation**

Location
VA Medical Center
2801 W. 22nd Street, PO Box 5046
Sioux Falls, SD 57117-5046

Date
08/06/2012

Checked
MJJ

Drawn
KAK

Project Number
04100857
Building Number
5

Drawing Number
5-EY102
Dwg. 113 of 123

Office of
Construction
and Facilities
Management

Department of
Veterans Affairs