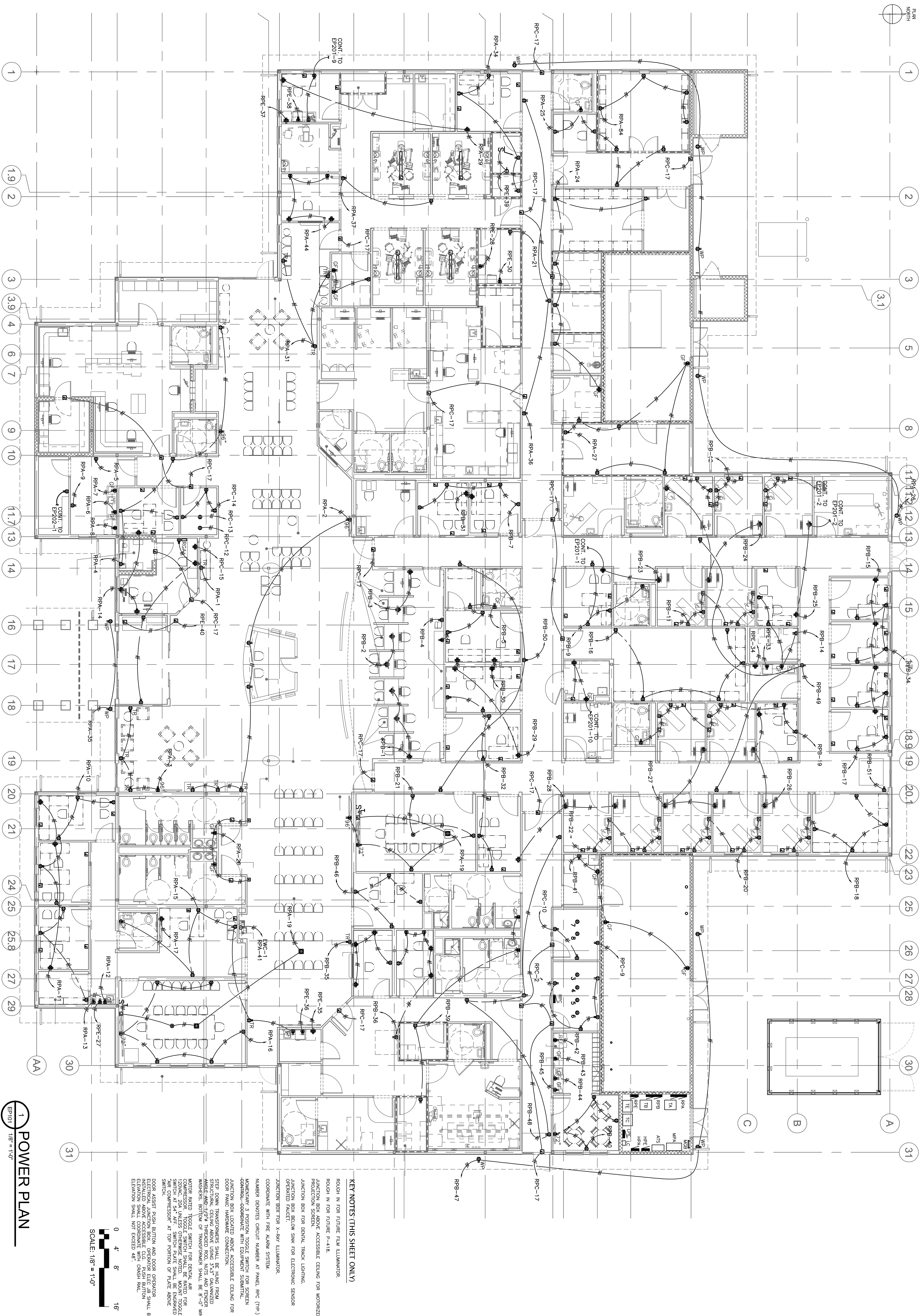

[illegible]

FINAL SUBMISSION / FULLY SPRINKLERED

CONSULTANTS:		ARCHITECT/ENGINEERS:	
CIVIL KENNETH HOPKIN & ASSOCIATES 10000 W. BAYVIEW AVENUE, SUITE 400 PENSACOLA, FLORIDA 32506 Pk. (904) 471-0093		BES DESIGN/BUILD 766 Middle St., Fairhope, AL 36532 Phone: 251/980/5778 Fax: 251/980/3716	
COMM/GEN. SCHMIDT CONSULTING GROUP, INC. 10000 W. BAYVIEW AVENUE, SUITE 400 PENSACOLA, FLORIDA 32506 Pk. (904) 432-8831		BES DESIGN/BUILD 766 Middle St., Fairhope, AL 36532 Phone: 251/980/5778 Fax: 251/980/3716	
LANDSCAPE ARCHITECT LANSKAP GROUP, INC. 6350 WYOMING AVENUE MOBILE, ALABAMA 36689 Pk. (251) 344-4052		BES DESIGN/BUILD 766 Middle St., Fairhope, AL 36532 Phone: 251/980/5778 Fax: 251/980/3716	
STRUCTURAL KOSKE ENGINEERING, INC. 10000 W. BAYVIEW AVENUE, SUITE 120 PENSACOLA, FLORIDA 32506 Pk. (904) 434-5545		BES DESIGN/BUILD 766 Middle St., Fairhope, AL 36532 Phone: 251/980/5778 Fax: 251/980/3716	
MECHANICAL KOSKE ENGINEERING, INC. 10000 W. BAYVIEW AVENUE, SUITE 120 PENSACOLA, FLORIDA 32506 Pk. (904) 434-5545		BES DESIGN/BUILD 766 Middle St., Fairhope, AL 36532 Phone: 251/980/5778 Fax: 251/980/3716	
ELECTRICAL KOSKE ENGINEERING, INC. 10000 W. BAYVIEW AVENUE, SUITE 120 PENSACOLA, FLORIDA 32506 Pk. (904) 434-5545		BES DESIGN/BUILD 766 Middle St., Fairhope, AL 36532 Phone: 251/980/5778 Fax: 251/980/3716	
PLUMBING KOSKE ENGINEERING, INC. 10000 W. BAYVIEW AVENUE, SUITE 120 PENSACOLA, FLORIDA 32506 Pk. (904) 434-5545		BES DESIGN/BUILD 766 Middle St., Fairhope, AL 36532 Phone: 251/980/5778 Fax: 251/980/3716	
DATE APRIL 2003		DRAWING NUMBER EPI01	
PROJECT TITLE POWER PLAN		PROJECT NUMBER 520-326	
APPROVED PROJECT DIRECTOR [Signature]		BUILDING NUMBER -	
LOCATION PANAMA CITY, FLORIDA		OFFICE OF CONSTRUCTION AND FACILITIES MANAGEMENT	
DATE APRIL 2003		DEPARTMENT OF VETERANS AFFAIRS	