

three inches = one foot
one and one half inches = one foot
one inch = one foot
three quarters inch = one foot
one half inch = one foot
three eighths inch = one foot
one quarter inch = one foot
one eighth inch = one foot

A
B
C
D
E
F

MATCHLINE SEE SHEET I1.4

ELEC. TOWER

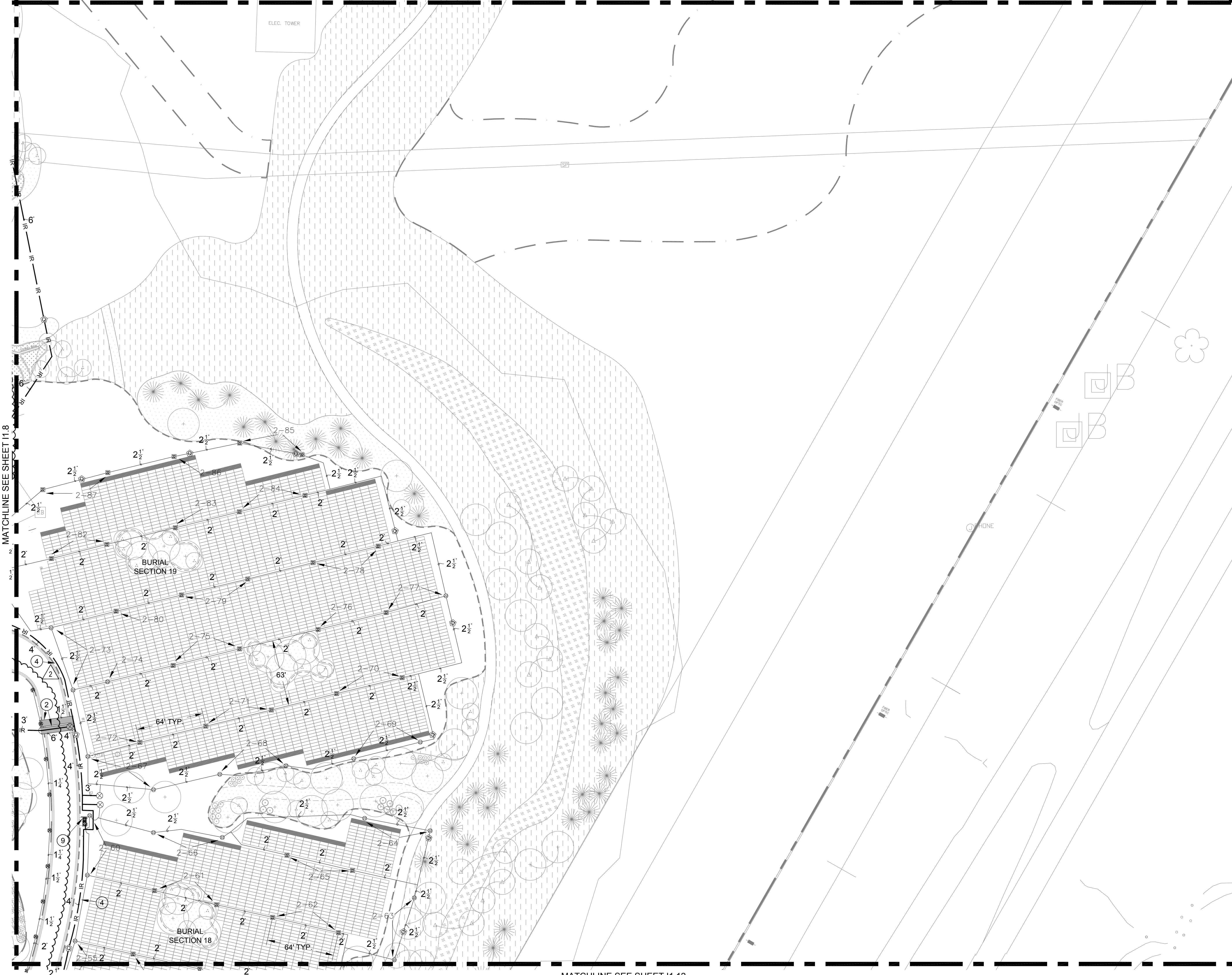

MATCHLINE SEE SHEET I1.12

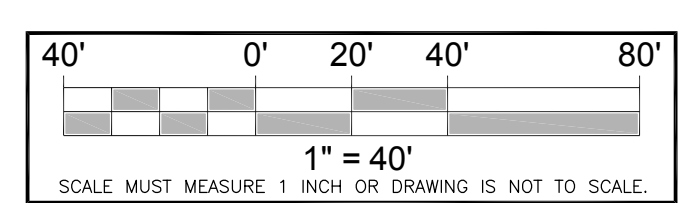
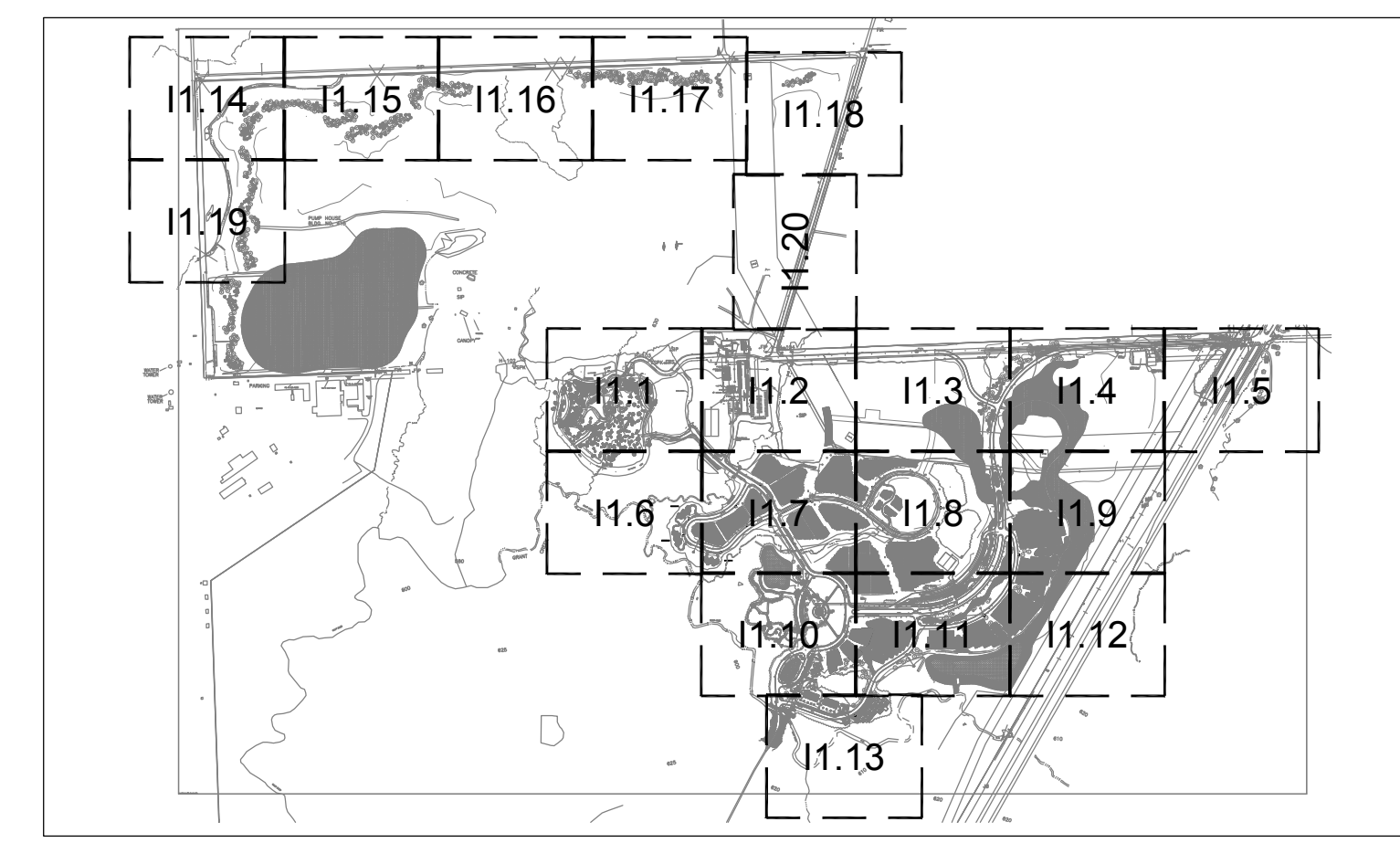

Revision	Revisions	Date
2		11/11/11

CONSULTANTS:

Landmark Engineering
3521 West Eisenhower Blvd., Loveland, Colorado 80537
(970) 667-6286 • Toll Free (866) 379-6282 • Fax (970) 667-6298
www.landmarkeng.com

Walton and Associates Architects, P.C.
1227 South Sixth Street
Springfield, Illinois 62703
Tel: (217) 544-8888 Fax: (217) 544-1881 Email: wa@waltonarchitects.com

Anderson Engineering of Minnesota, LLC
15905 144 Avenue North, Suite 100, Plymouth, MN 55441
Tel: (763) 418-6000 Fax: (763) 418-6000
www.ae-minn.com

Aqua Engineering, Inc.
Innovative Water Solutions
4803 Innovation Drive
Fort Collins, Colorado 80525
Phone: (970) 225-8668
Fax: (970) 226-3855

JOSE DE AVILA AND ASSOCIATES
Electrical and Mechanical Engineers
6611 W. North Avenue Suite 101
Oak Park, Illinois 60302
(708) 383-5330 (708) 383-5871 fax

SMITHGROUP
architecture engineering interiors planning

SMITHGROUP, INC.
500 GRISWOLD
SUITE 1700
DETROIT, MICHIGAN 48226
T 313.983.3600
F 313.983.3635
www.smithgroup.com

ARCHITECT/ENGINEERS:

JJR
landscape architecture
planning
urban design
civil engineering
environmental science

JJR LLC
110 MILLER AVENUE
ANN ARBOR, MICHIGAN 48104
734.662.4457 T 734.662.0779 F
www.jjr-us.com

Drawing Title
**IRRIGATION PLAN
AREA J**

Approved Project Director

Project Title
**ABRAHAM LINCOLN NATIONAL
CEMETERY - PHASE 2 GRAVESITE
EXPANSION AND IMPROVEMENTS**

Location
ELWOOD, ILLINOIS

Date
2010/05/13

Checked
2010/04/12

Drawn
JDL/CAM

Project Number
915PC2003

Drawing Reference Number
265

Drawing Number
I1.9

Office of
Construction
and Facilities
Management

Department of
Veterans Affairs