

- NOTES:
1. SEE 3/- FOR PROTECTED ZONE LOCATIONS.
 2. COL. STRENGTHENING PLATES TO BE WELDED PRIOR TO BRACE WELDING (N) BRACES TO BEAM/COL. GUSSETES.
 3. AESS AS REQUIRED PER GENERAL NOTES.
 4. PROVIDE DC WELDS FOR ALL CONNECTIONS OF SLRS.

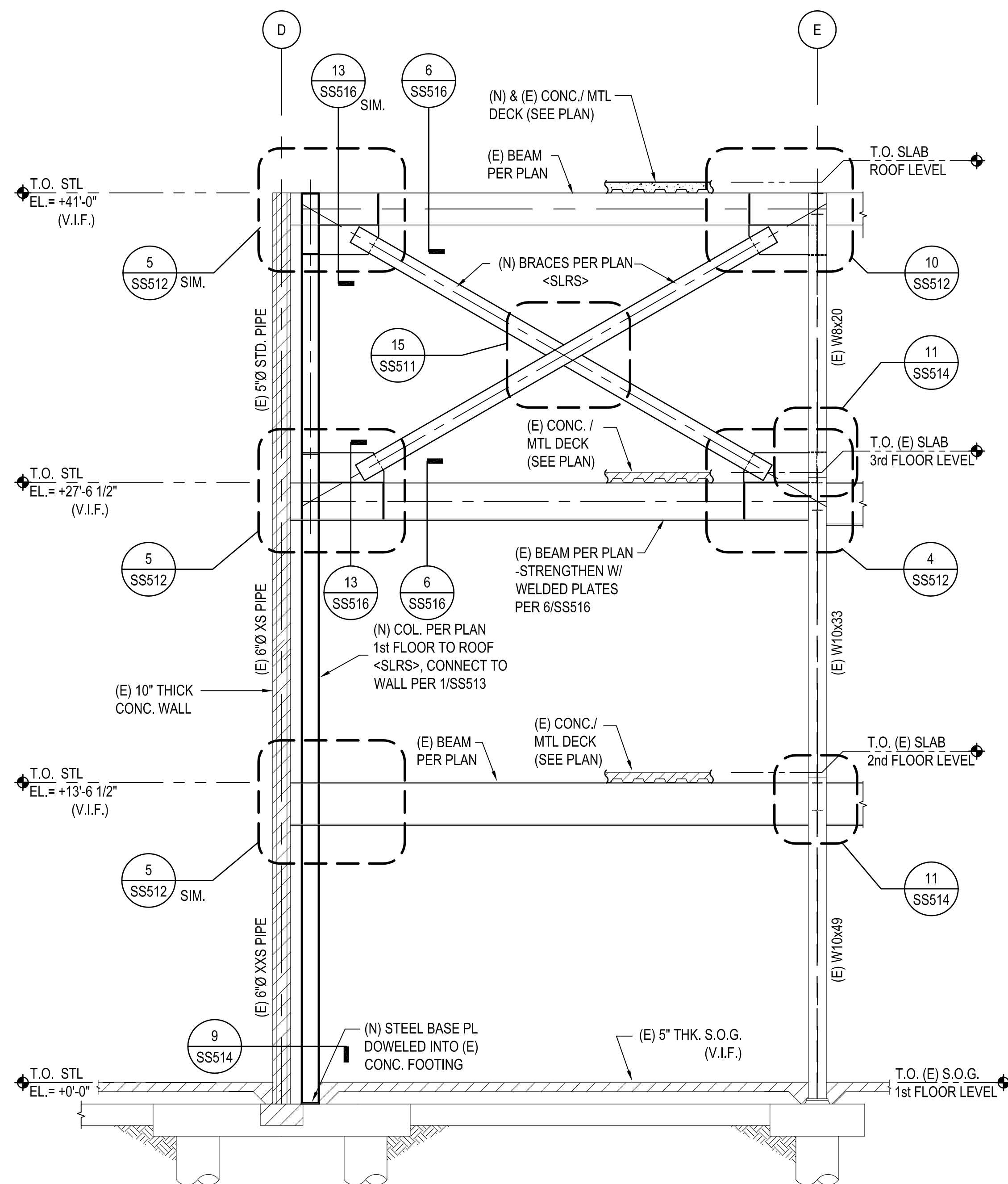

- NOTES:**
1. SEE 3/- FOR PROTECTED ZONE LOCATIONS.
 2. COL. STRENGTHENING PLATES TO BE WELDED PRIOR TO WELDING (N) BRACES TO BEAM/COL. GUSSETS.
 3. AESS AS REQUIRED PER GENERAL NOTES.
 4. PROVIDE DC WELDS FOR ALL CONNECTIONS OR SLRS.

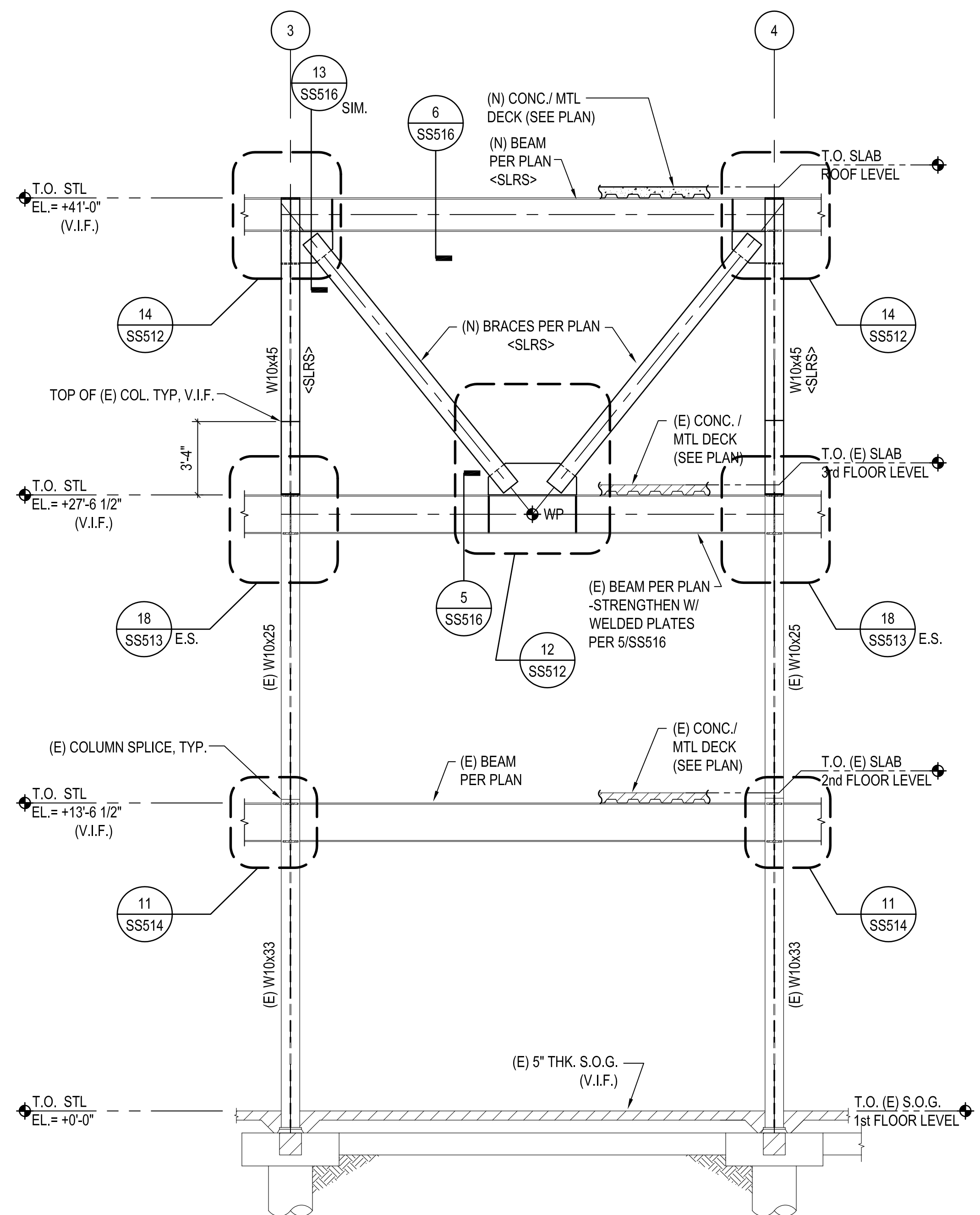

- NOTES:
1. SEE 6/- FOR PROTECTED ZONE LOCATIONS.
 2. COL. STRENGTHENING PLATES TO BE WELDED PRIOR TO WELDING (N) BRACES TO BEAM/COL. GUSSETS.
 3. AESS AS REQUIRED PER GENERAL NOTES.
 4. PROVIDE DC WELDS FOR ALL CONNECTIONS OF SLRS.

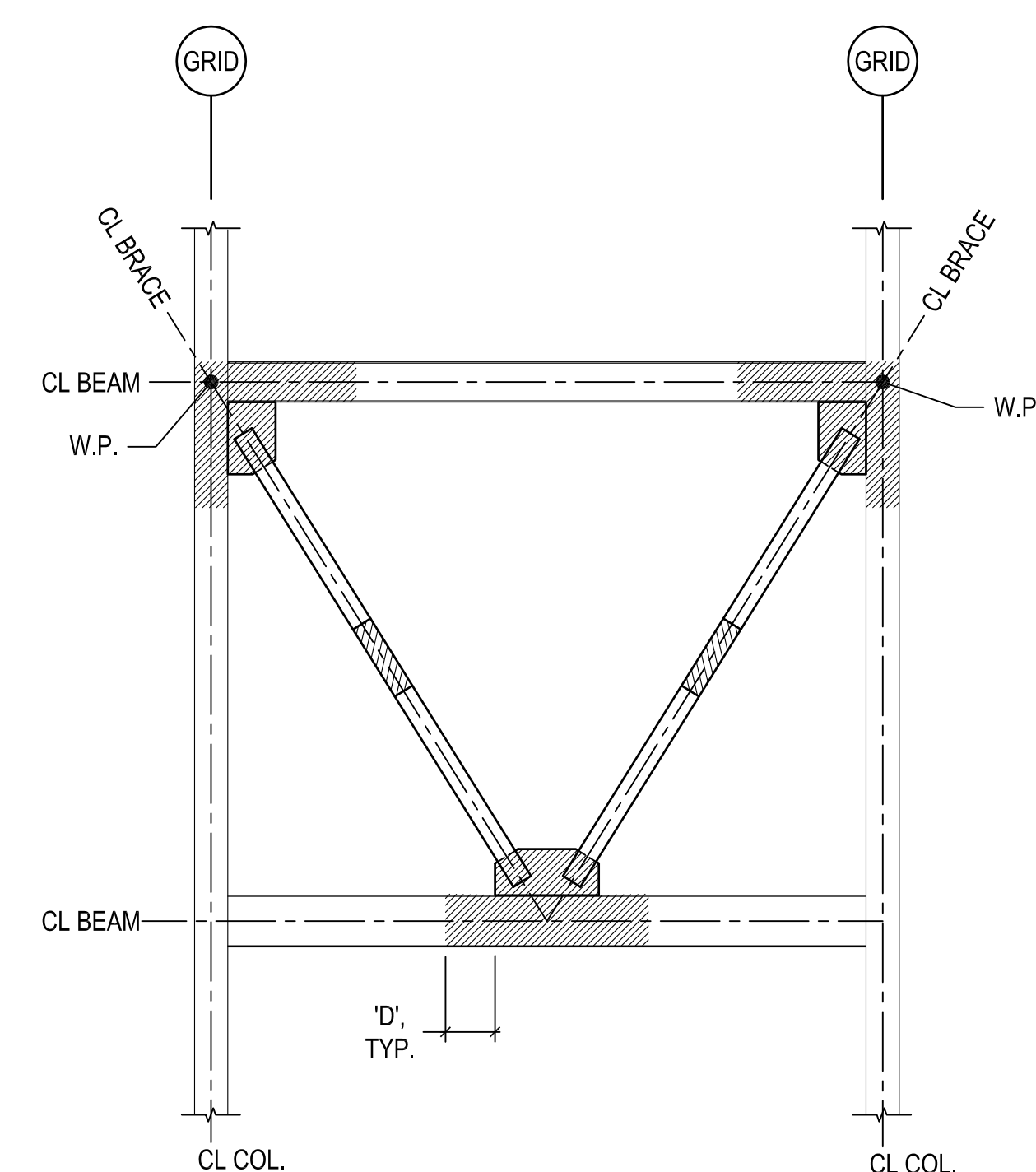

- DETAIL NOTES:
1. 'D' = BRACE DEPTH OR DIAMETER
 2. REQUIREMENTS FOR PROTECTED ZONES SHALL FOLLOW AISC 341-05 SECTION 13.6

LEGEND:

 PROTECTED ZONE

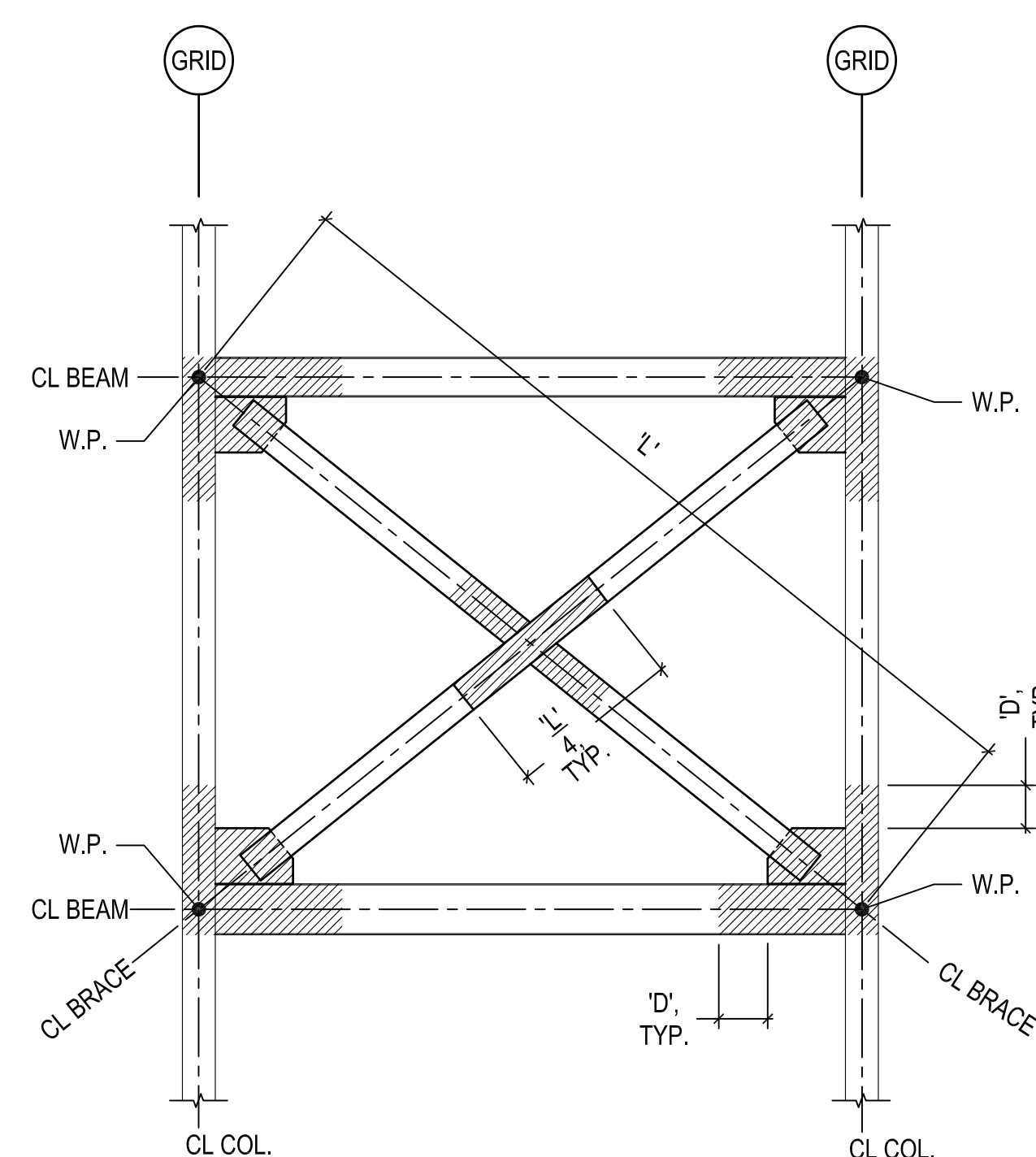

- DETAIL NOTES:
1. 'D' = BRACE DEPTH OR DIAMETER
 2. REQUIREMENTS FOR PROTECTED ZONES SHALL FOLLOW AISC 341-05 SECTION 13.6

LEGEND:

 PROTECTED ZONE

[illegible]