

No.	Botanical Name	Sect.	Common Name	DH	Ht. Ft.	Crown Cleaning	Crown Thinning	Crown Raise
1	Quercus phello	L	Willow Oak	40		X		
4	Quercus phello	W	Willow Oak	48		X		
5	Quercus phello	W	Willow Oak	48		X		
6	Quercus nigra	W	Water Oak	40			X	
7	Quercus nigra	W	Water Oak	48		X	X	
8	Quercus nigra	W	Water Oak	36		X	X	
9	Magnolia grandiflora	W	Southern Magnolia	48		X		
10	Quercus phello	W	Willow Oak	40		X	X	
11	Quercus phello	W	Willow Oak	30		X	X	
13	Quercus phello	V	Willow Oak	48		X	X	
15	Quercus nigra	V	Water Oak	36		X	X	
16	Quercus phello	V	Willow Oak	36		X	X	
17	Quercus nigra	U	Water Oak	60	90	X	X	
18	Ulmus alata	U	Winged Elm	48		X		
25	Quercus phello	F	Willow Oak	48		X	X	
30	Quercus phello	A	Willow Oak	48		X	X	
31	Quercus phello	A	Willow Oak	60		X		
35	Carya illinoensis	A	Pecan	30			X	
36	Carya illinoensis	A	Pecan	30		X		
39	Quercus phellos	L	Willow Oak	36		X	X	
40	Quercus phellos	L	Willow Oak	60		X		
42	Quercus phellos	C	Willow Oak	52	80	X	X	
43	Quercus phellos	L	Willow Oak	48		X		
45	Quercus nigra	C	Water Oak	40		X	X	
49	Juniperus virginiana	L	Eastern Redcedar	18	40			X
50	Juniperus virginiana	L	Eastern Redcedar	18	40			X
58	Quercus phellos	P	Willow Oak	36		X		
61	Quercus phellos	P	Willow Oak	30		X	X	
62	Magnolia grandiflora	P	Southern Magnolia	24	60	X		
64	Quercus phellos	P	Willow Oak	48		X		
70	Spiraea thunbergi	C	Thunberg Spirea	60		X		
74	Quercus nigra	C	Water Oak	40		X	X	
76	Carya illinoensis	A	Pecan	36		X		
77	Carya illinoensis	A	Pecan	36			X	
78	Carya illinoensis	A	Pecan	30		X		

No.	Botanical Name	Sect.	Common Name	DH	Ht. Ft.	Crown Cleaning	Crown Thinning	Crown Raise
79	Quercus nigra	A	Water Oak	60		X	X	
80	Quercus nigra	U	Water Oak	48		X	X	
81	Quercus phellos	U	Willow Oak	48			X	
82	Quercus phellos	U	Willow Oak	48		X	X	
84	Quercus phellos	T	Willow Oak	36			X	
87	Quercus phellos	T	Willow Oak	48		X	X	
89	Quercus phellos	T	Willow Oak	36		X	X	
91	Quercus nigra	G	Water Oak	48		X	X	
93	Quercus nigra	B	Water Oak	60	60	X	X	
96	Quercus phellos	B	Willow Oak	60	100			
97	Quercus phellos	B	Willow Oak	60		X	X	
98	Carya illinoensis	B	Pecan	30			X	
99	Carya illinoensis	B	Pecan	30			X	
100	Carya illinoensis	B	Pecan	30	50			
101	Quercus phellos	B	Willow Oak	55		X	X	
102	Quercus phellos	B	Willow Oak	60		X	X	
105	Quercus nigra	B	Water Oak	48		X	X	
111	Quercus phellos	R	Willow Oak	36		X		
123	Quercus phellos	D	Willow Oak	36		X		
124	Quercus phellos	D	Willow Oak	36		X	X	
126	Quercus phellos	N	Willow Oak	48		X		
127	Quercus phellos	N	Willow Oak	48		X	X	
128	Quercus phellos	N	Willow Oak	60		X		
129	Quercus phellos	N	Willow Oak	48		X		
132	Quercus phellos	O	Willow Oak	36		X		
133	Quercus phellos	O	Willow Oak	36		X		
134	Quercus phellos	O	Willow Oak	48			X	
140	Quercus nigra	O	Water Oak	36		X	X	
142	Fraxinus americana	O	White Ash	24			X	
143	Quercus phellos	O	Willow Oak	30		X	X	
144	Fraxinus americana	O	White Ash	40		X	X	
145	Quercus macrocarpa	N	Bur Oak	5		X		
146	Quercus phellos	N	Willow Oak	60		X	X	
147	Quercus nigra	N	Water Oak	48		X	X	
148	Quercus nigra	N	Water Oak	40		X	X	
149	Quercus phellos	O	Willow Oak	36		X		

No.	Botanical Name	Sect.	Common Name	DH	Ht. Ft.	Crown Cleaning	Crown Thinning	Crown Raise
158	Quercus phellos	S	Willow Oak	24		X		
163	Quercus phellos	S	Willow Oak	40		X	X	
165	Quercus nigra	S	Water Oak			X		
166	Quercus phellos	K	Willow Oak	72		X		
169	Ilex opaca	S	American Holly	12	20			
170	Quercus prinus	S	Chestnut Oak	48			X	
171	Quercus phellos	T	Willow Oak	60		X	X	
172	Ilex opaca	T	American Holly	10	20			
202	Quercus nigra	S	Water Oak	36		X		
207	Quercus nigra	S	Water Oak	36		X	X	
208	Quercus phellos	T	Willow Oak	36		X	X	
209	Magnolia grandiflora	T	Southern Magnolia	18	30	X		
210	Quercus phellos	T	Willow Oak	36		X	X	
212	Quercus nigra	T	Water Oak	48		X		
214	Quercus phellos	T	Willow Oak	48		X	X	
215	Quercus falcata	T	Southern Red Oak	36		X		
216	Quercus phellos	T	Willow Oak	32			X	
217	Quercus phellos	T	Willow Oak	36		X		
218	Quercus nigra	T	Water Oak	36			X	
219	Quercus falcata	T	Southern Red Oak	36		X	X	
220	Quercus phellos	R	Willow Oak	30	90			
221	Quercus nigra	R	Water Oak	36		X	X	
223	Quercus phellos	R	Willow Oak	48		X		
224	Quercus phellos	R	Willow Oak	48		X	X	
225	Quercus phellos	R	Willow Oak	36		X		
226	Quercus nigra	N	Water Oak	24			X	
228	Quercus phellos	N	Willow Oak	20			X	
229	Quercus phellos	N	Willow Oak	24		X	X	
230	Quercus phellos	N	Willow Oak	48			X	
231	Quercus phellos	N	Willow Oak	24		X	X	
233	Quercus phellos	O	Willow Oak	24		X	X	
234	Quercus phellos	O	Willow Oak	36		X	X	
235	Quercus phellos	O	Willow Oak	24			X	
237	Quercus phellos	O	Willow Oak	48			X	
243	Quercus falcata	U	Southern Red Oak	30		X	X	
244	Quercus nigra	U	Water Oak	48		X	X	

No.	Botanical Name	Sect.	Common Name	DH	Ht. Ft.	Crown Cleaning	Crown Thinning	Crown Raise
246	Quercus nigra	U	Water Oak	40		X	X	
247	Magnolia grandiflora	U	Southern Magnolia	24	30	X	X	
248	Quercus phellos	U	Willow Oak	24	80	X		
249	Quercus nigra	U	Water Oak	24		X	X	
252	Quercus phellos	V	Willow Oak	30		X	X	
253	Quercus falcata	V	Southern Red Oak	36		X		
256	Quercus phellos	E	Willow Oak	36		X	X	
260	Quercus nigra	V	Water Oak	36		X		
261	Quercus phellos	V	Willow Oak	60		X		
271	Quercus phellos	V	Willow Oak	24			X	
276	Quercus phellos	W	Willow Oak	48		X	X	
277	Quercus nigra	W	Quercus Nigra	48		X		
278	Quercus phellos	W	Willow Oak	36		X		
279	Quercus falcata	W	Southern Red Oak	36	70	X		
281	Quercus nigra	W	Water Oak	24				X
287	Quercus nigra	P	Water Oak	24		X	X	
288	Quercus phellos	P	Willow Oak	24		X	X	
289	Quercus phellos	P	Willow Oak	30		X	X	
290	Quercus phellos	P	Willow Oak	24		X	X	
291	Quercus phellos	P	Willow Oak	30			X	
292	Quercus phellos	P	Willow Oak	30		X	X	
293	Quercus phellos	P	Willow Oak	36		X	X	
294	Quercus phellos	P	Willow Oak	30		X	X	
295	Quercus phellos	P	Willow Oak	24		X	X	
296	Quercus phellos	P	Willow Oak	30		X	X	
297	Quercus falcata	P	Southern Red Oak	32	70	X		
300	Quercus falcata	P	Southern Red Oak	48		X	X	
302	Juniperus virginiana	P	Eastern Redcedar	24	70		X	X

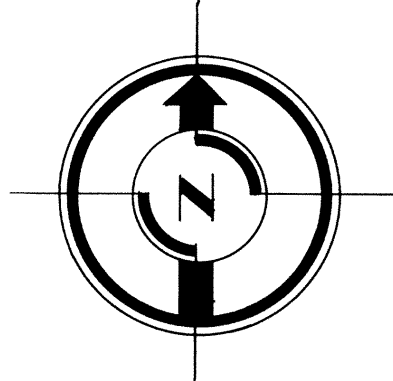

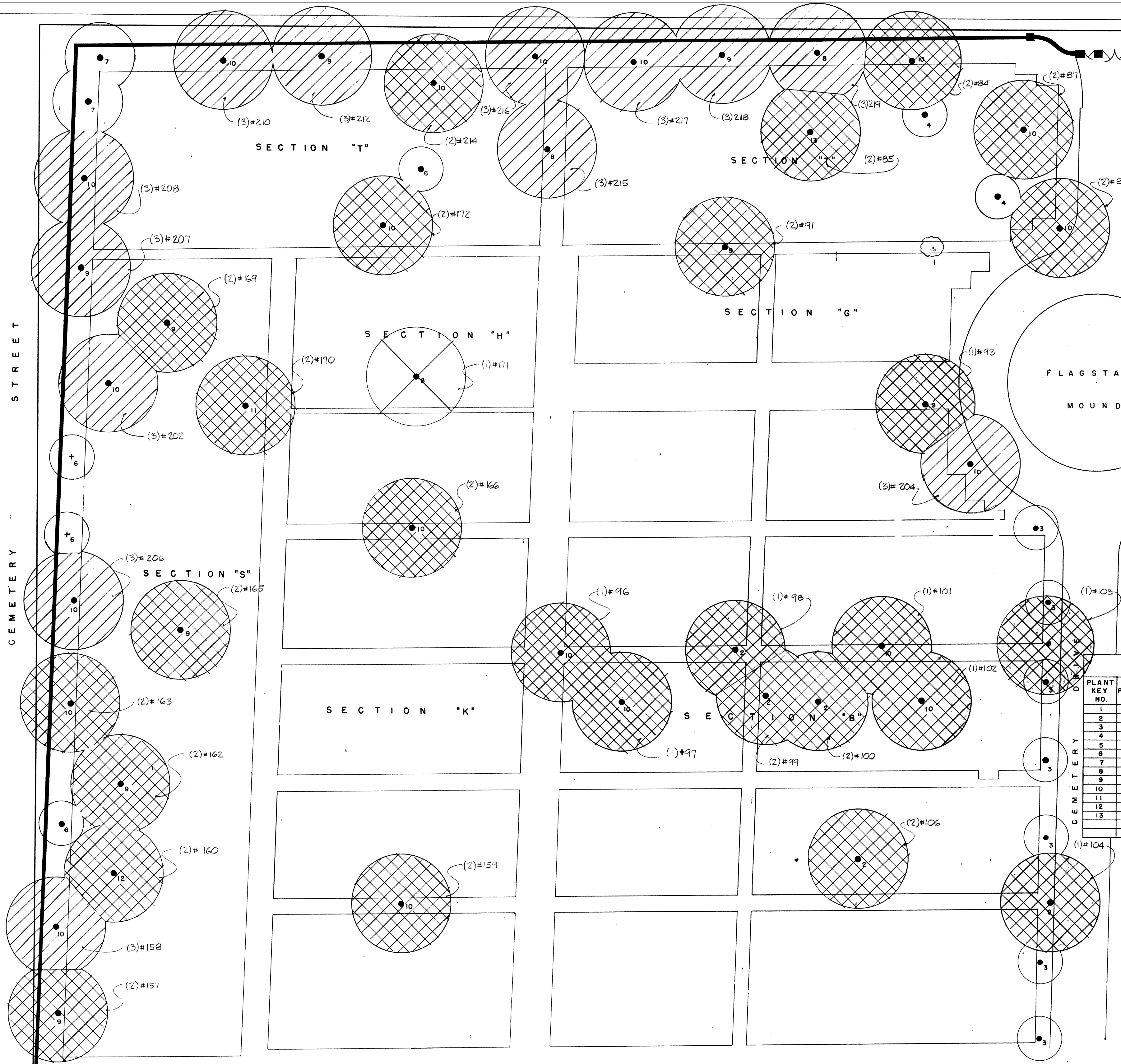

NOTE
1. WITH FEW EXCEPTIONS THE PLANT NAMES CONFORM TO "STANDARDIZED PLANT NAMES" AS ADOPTED BY THE JOINT COMMITTEE ON HORTICULTURAL NOMENCLATURE (1942 EDITION).
2. PLANT KEY NUMBER APPLY TO THIS SHEET ONLY.
3. UNLESS OTHERWISE SPECIFIED, NEW PLANT MATERIAL GRADING WILL CONFORM TO "AMERICAN STANDARD FOR NURSERY STOCK", AMERICAN ASSOCIATION OF NURSERYMEN, INC., WASHINGTON, D.C.

REVISIONS
A. REMOVALS AND PLANTING ACCOMPLISHED DEC. '64.
B. 9 TREES REMOVED DAMAGED BY TORNADO 4-19-70

LEGEND
● EXISTING TREES TO REMAIN

PRUNING LEGEND
● (1) PRUNE - (BASE BID)
● (1) REMOVE - (BASE BID)
● (2) PRUNE - (ADD ALTERNATE NO. 2)
● (3) PRUNE - (ADD ALTERNATE NO. 2)

P L A N T L I S T				
PLANT KEY NO.	NO. OF PLANTS (NEW)	BOTANICAL NAME	COMMON NAME	SIZE (NEW)
1		BUXUS SEMPERVIRENS	COMMON BOX	
2		CARYA ILLINOENSIS	PECAN	
3		CORNUS FLORIDA	FLOWERING DOGWOOD	
4		" "	REDFLOWERING DOGWOOD	
5		FRAXINUS AMERICANA	WHITE ASH	
6		ILEX OPACA	AMERICAN HOLLY	
7		MAGNOLIA GRANDIFLORA	SOUTHERN MAGNOLIA	
8		QUERCUS FALCATA	SOUTHERN RED OAK	
9		" NIGRA	WATER OAK	
10		" PHELLOS	WILLOW OAK	
11		" PRINUS	SWAMP CHESTNUT OAK	
12		" ALBA	WHITE OAK	
13		ULMUS AMERICANA	AMERICAN ELM	

SCALE 1" = 20'	
REVISIONS	
CORINTH NATIONAL CEMETERY CORINTH, MISSISSIPPI	
TREE PRUNING & REMOVAL SECTIONS B, G, H, K, S, & T.	
DRAWN BY DAEWON	CHECKED BY DAEWON
APPROVED DAEWON	DATE 1/12/11
TRACED BY	SUBMITTED BY
PLAN NUMBER ML 167.3	

Revisions	Date

Scale : NTS

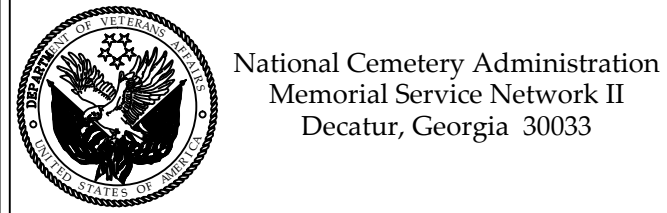

National Cemetery Administration
Memorial Service Network II
Decatur, Georgia 30033

Drawing Title
Sections B-G-H-K-S & T
Tree Plan

Approved: Area Director
Approved: Cemetery Director

Project: Corinth National Cemetery
Location: Corinth, MS

Building Number
Checked
Drawn
DCJ

Path: \\Cemata101\share\MSN II
Drawings\Corinth\Planting

Date
3/17/11

Project No.

Drawing Title
838PL100

Dwg. Of

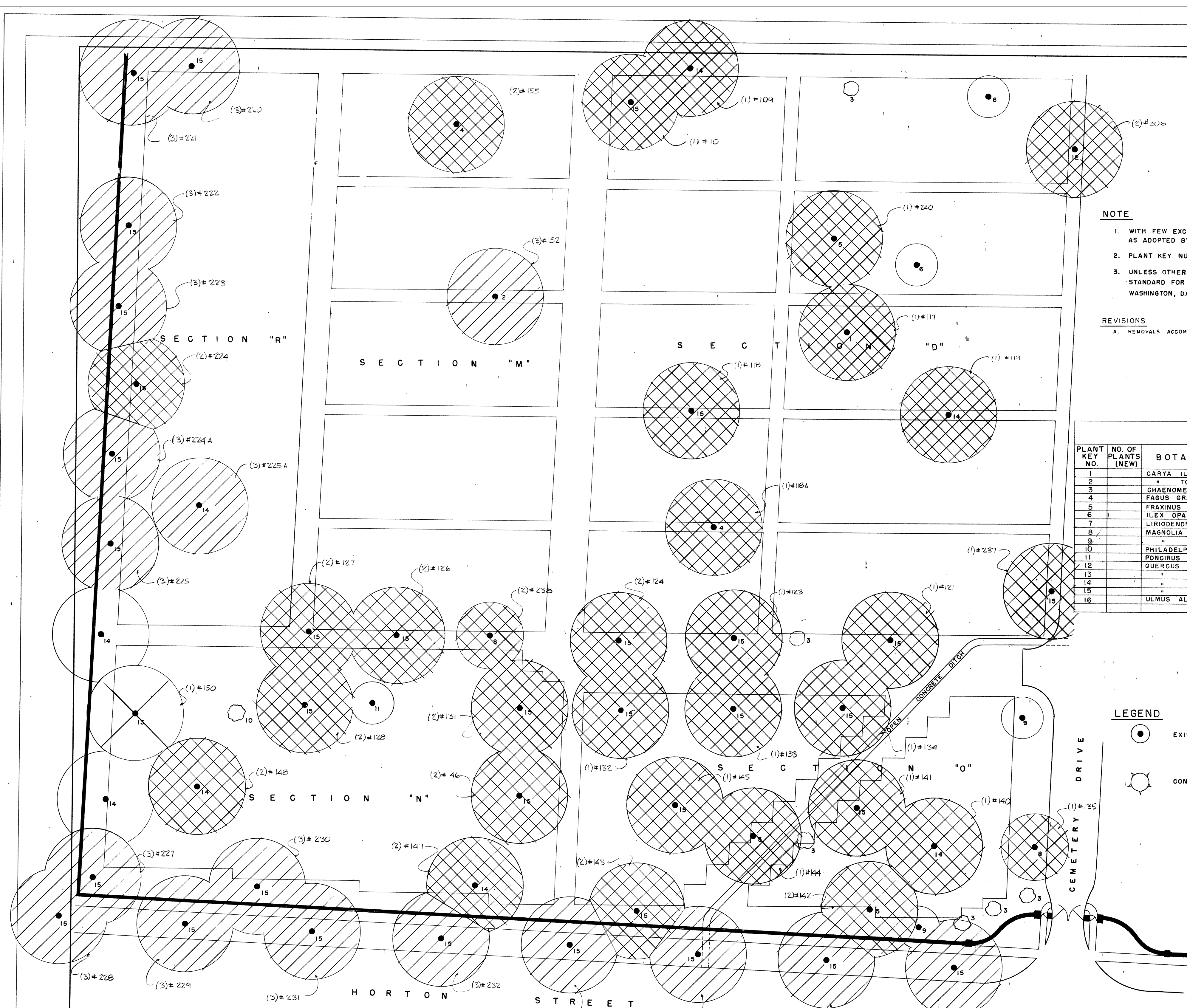

NOTE

1. WITH FEW EXCEPTIONS THE PLANT NAMES CONFORM TO "STANDARDIZED PLANT NAMES" AS ADOPTED BY THE JOINT COMMITTEE ON HORTICULTURAL NOMENCLATURE (1942 EDITION).

2. PLANT KEY NUMBERS APPLY TO THIS SHEET ONLY.

3. UNLESS OTHERWISE SPECIFIED NEW PLANT MATERIAL GRADING WILL CONFORM TO "AMERICAN STANDARD FOR NURSERY STOCK", AMERICAN ASSOCIATION OF NURSEYMEN, INC., WASHINGTON, D.C.

REVISIONS

A. REMOVALS ACCOMPLISHED DEC. '64.

P L A N T L I S T					
PLANT KEY NO.	NO. OF PLANTS (NEW)	BOTANICAL NAME	COMMON NAME	SIZE (NEW)	COMMENT
1		CARYA ILLINOENSIS	PECAN		
2		" TOMENTOSA	MOCKERNUT HICKORY		
3		CHAENOMELES JAPONICA	JAPANESE FLOWERINGQUINCE		
4		FAGUS GRANDIFLORA	AMERICAN BEECH		
5		FRAXINUS AMERICANA	WHITE ASH		
6		ILEX OPACA	AMERICAN HOLLY		
7		LIRIODENDRON TULIPIFERA	TULIPTREE		
8		MAGNOLIA GRANDIFLORA	SOUTHERN MAGNOLIA		
9		" SOULANGEANA	SAUCER MAGNOLIA		
10		PHILADELPHUS CORONARIUS	SWEET MOCKORANGE		
11		POINCUS TRILOBIATA	TRIFOLIATE ORANGE		
12		QUERCUS PRINUS	CHESNUT OAK		
13		" MACROCARPA	BUR OAK		
14		" NIGRA	WATER OAK		
15		" PHELLOS	WILLOW OAK		
16		ULMUS ALATA	WINGED ELM		

PRUNING LEGEND

(1) PRUNE - (BASE BID)

(1) REMOVE - (BASE BID)

(2) PRUNE - (ADD. ALTERNATE #1)

(3) PRUNE - (ADD. ALTERNATE #2)

LEGEND

● EXISTING TREES TO REMAIN

☼ CONIFEROUS EVERGREENS

SCALE

1" = 20'

REVISIONS

CORINTH NATIONAL CEMETERY
CORINTH, MISSISSIPPI

TREE PRUNING & REMOVAL
SECTIONS D, M, N, O & R

DRAWN BY: _____ CHECKED BY: _____ APPROVED: _____ DATE: _____

Revisions	Date

Scale : NTS



National Cemetery Administration
Memorial Service Network II
Decatur, Georgia 30033

Drawing Title
**Sections D-M-N-O & R
Tree Plan**

Approved: Area Director _____

Approved: Cemetery Director _____

Project: **Corinth National Cemetery**

Location: **Corinth, MS**

Building Number _____ Checked _____ Drawn **DCJ**

Path: \\Cemata101\share\MSN II Drawings\Corinth\Planting

Date **3/17/11**

Project No. _____

Drawing Title **838PL100**

Dwg. _____ Of _____