

A

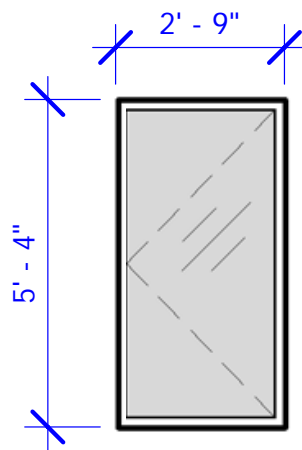

B

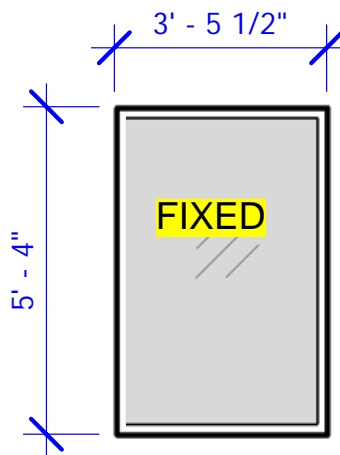

C

NOTE

1. ALL DIM. ARE FOR WINDOW ROUGH OPENING
2. ALL DIM. ARE TO BE FIELD VERIFIED

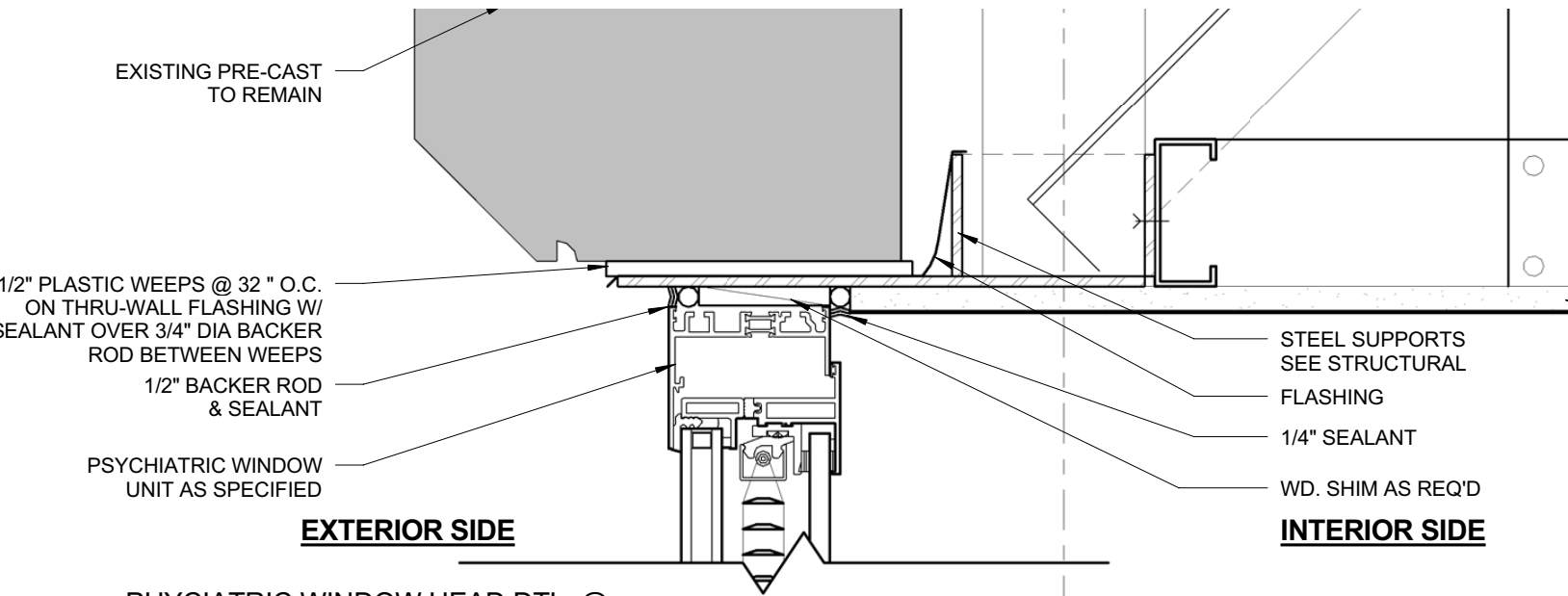

PHYCIATRIC WINDOW HEAD DTL. @
EXISTING PRE-CAST
3" = 1'-0"

①

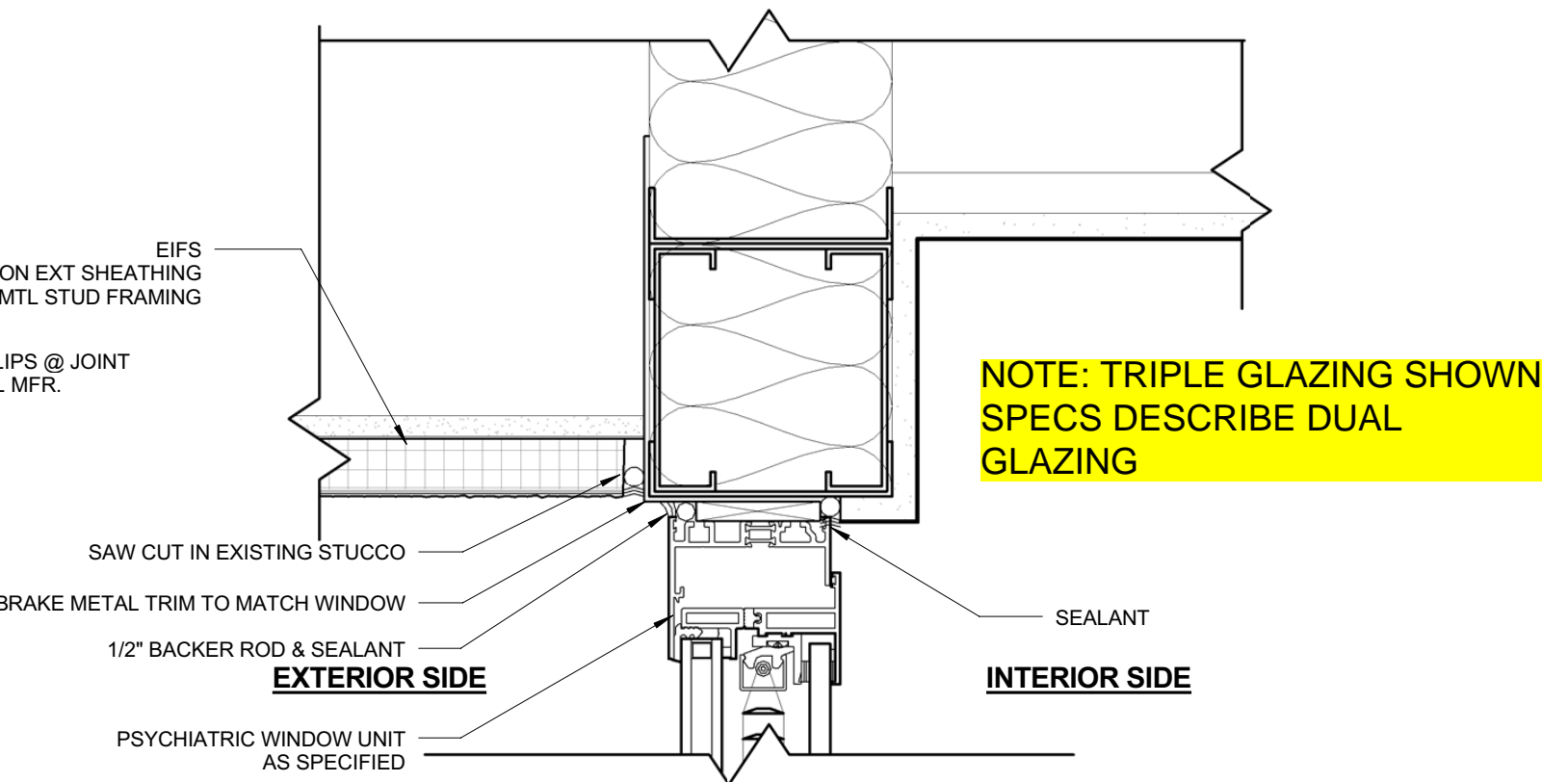

PHYCIATRIC WINDOW HEAD DTL. @
TERRACE CEILING
3" = 1'-0"

④



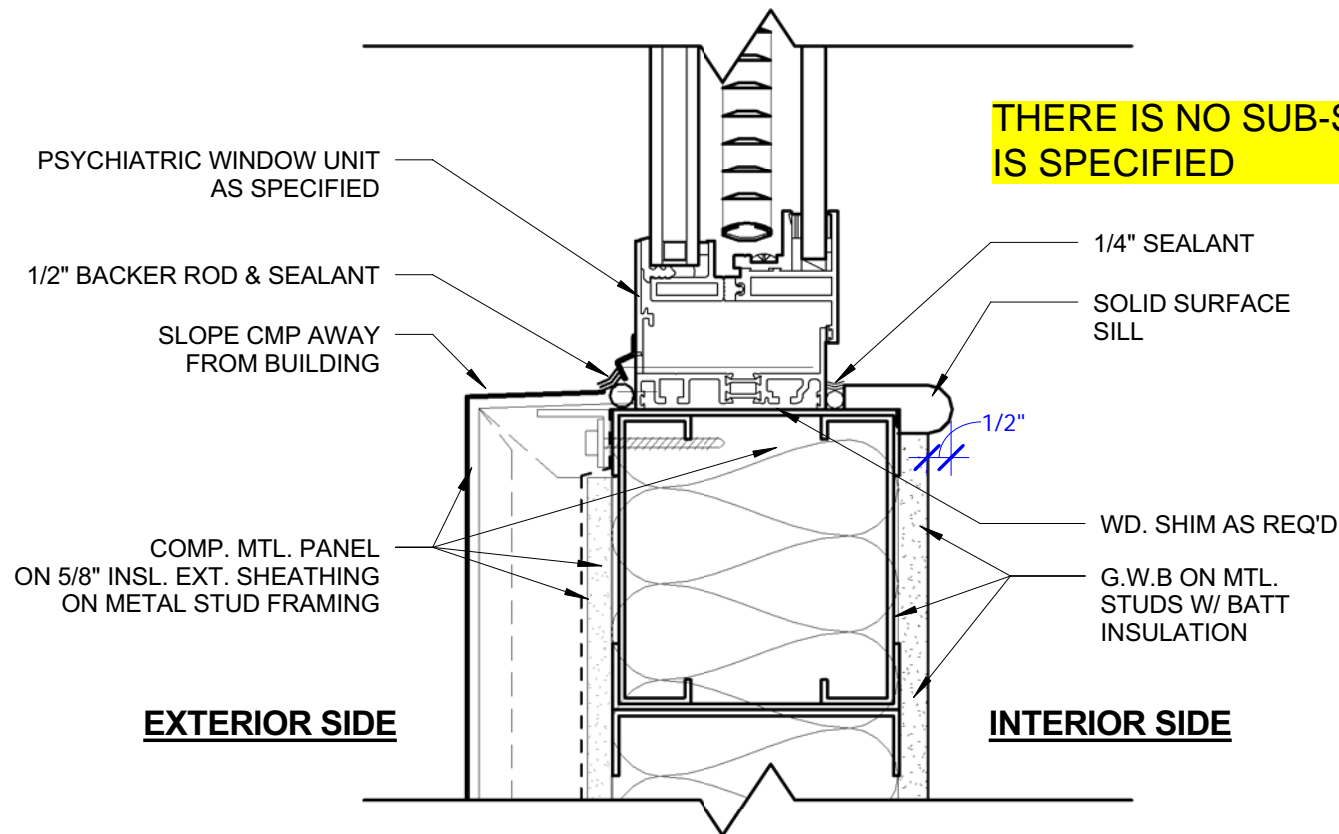

8 TYP. DTL. @ PHYCIATRIC WINDOW SILL
3" = 1'-0"

As for a response, the Basis of Design windows are to be the Wausau psychiatric window unit 4000i-DT Psychiatric Window...or equivalent.

The double-pane insulated panel is on the outside with the laminated glass panel in the inside. The venetian blind is sandwiched in between both panels. This is what is detailed on the drawings.

We have two specific window glazing requirements. One for patient rooms (7/16" laminated safety glass) and one for patient occupied spaces (5/16" laminated safety glass) as dictated by VA design guidelines. The latter is to be installed in Dayroom exterior windows and office storefront.

Patients will have access to the offices as advised by the VA mental health staff. The basis of design window unit meets the NY OMH requirements and so must any contractor alternative.